

**STONA COUGH- dextromethorphan hydrobromide, guaifenesin syrup**  
**Sato Pharmaceutical Co., Ltd.**

-----  
**Stona Cough Syrup**

**Active ingredients** (in 10 mL)

Dextromethorphan hydrobromide 30 mg

Guaifenesin 200 mg

**Purpose**

Dextromethorphan hydrobromide Cough suppressant

Guaifenesin Expectorant

**Uses**

For the temporary relief of cough due to the common cold. Helps loosen phlegm (mucus) and thin bronchial secretions to make coughs more productive.

**WARNINGS**

Enter section text here

**Do not use** this product

■if you are now taking a prescription monoamine oxidase inhibitor (MAOI) (certain drugs for depression, psychiatric or emotional conditions, or Parkinson's disease), or for 2 weeks after stopping the MAOI drug. If your prescription drug contains an MAOI, ask a doctor or pharmacist before taking this product.

■for a persistent or chronic cough such as occurs with smoking, asthma, or emphysema.

■if cough is accompanied by excessive phlegm (mucos) unless directed by a doctor.

A persistent cough may be a sign of a serious condition. If cough persists for more than 1 week, tends to recur, or is accompanied by fever, rash, or persistent headache, consult a doctor.

**Keep out of reach of children.** In case of accidental overdose, get medical help or contact a Poison Control Center right away.

**If pregnant or breast-feeding**, ask a health professional before use.

**Directions**

■Adults and children 12 years of age and over: Take 10mL every 6 - 8 hours, not to exceed 30mL in 24 hours, or as directed by a doctor.

■Children under 12 years: Ask a doctor.

**Inactive ingredients**

alcohol, beta-cyclodextrin, butylparaben, calcium chloride, caramel, citric acid, flavor, glycyrrhiza (licorice) extract, propylparaben, sodium benzoate, sodium saccharin, sugar, water.

# STONA COUGH SYRUP

COUGH SUPPRESSANT,  
EXPECTORANT



sato

NDC 49873-302-01



STONA  
COUGH SYRUP  
COUGH SUPPRESSANT,  
EXPECTORANT

ストナ  
咳止液

せき、たんは

★ATTENTION : DO NOT PURCHASE IF IMPRINTED TAPE SEALING THE TOP AND BOTTOM OF THE BOX IS DAMAGED OR MISSING.

★FOR YOUR PROTECTION THIS PRODUCT HAS AN IMPRINTED SEAL AROUND THE NECK OF THE BOTTLE. DO NOT USE IF SEAL IS MISSING OR BROKEN.

★FOR SAFETY : THIS PRODUCT USES A CHILD RESISTANT SAFETY CAP.  
TO OPEN : PUSH DOWN CAP AND TURN COUNTERCLOCKWISE.

### Drug Facts

#### Active Ingredients (in 10mL)

Dextromethorphan Hydrobromide 30 mg --- Cough Suppressant  
Guaifenesin 200 mg ..... Expectorant

#### Purpose

#### Uses

For the temporary relief of cough due to the common cold. Helps loosen phlegm (mucus) and thin bronchial secretions to make coughs more productive.

#### Warnings

Do not use this product

- if you are now taking a prescription monoamine oxidase inhibitor(MAOI)(certain drugs for depression, psychiatric or emotional conditions, or Parkinson's disease), or for 2 weeks after stopping the MAOI drug. If your prescription drug contains an MAOI, ask a doctor or pharmacist before taking this product.
- for a persistent or chronic cough such as occurs with smoking, asthma, or emphysema.
- if cough is accompanied by excessive phlegm (mucus) unless directed by a doctor.

A persistent cough may be a sign of a serious condition. If cough persists for more than 1 week, tends to recur, or is accompanied by fever, rash, or persistent headache, consult a doctor.

Keep out of reach of children. In case of overdose, get medical help or contact a Poison Control Center right away. If pregnant or breast-feeding, ask a health professional before use.

#### Directions

- Adults and children 12 years of age and over: Take 10mL every 6-8 hours, not to exceed 30mL in 24 hours, or as directed by a doctor.
- Children under 12 years: Ask a doctor.

#### Inactive Ingredients

alcohol,  $\beta$ -cyclodextrin, butylparaben, calcium chloride, caramel, citric acid, flavor, glycyrrhiza(licorice) extract, propylparaben, sodium benzoate, sodium saccharin, sugar, water.

WITH MEASURING CUP  
計量コップ付

4 FL OZ (120 mL)

Manufactured by  
**SATO PHARMACEUTICAL CO., LTD.**  
1-5-27 MOTOAKASAKA MINATO-KU TOKYO, JAPAN

EXP. DATE  
使用期限

LOT  
製造記号

US-C

DISTRIBUTED BY  
SATO PHARMACEUTICAL INC./USA, TORRANCE, CA 90503

3

stonacoughsyrkartB.jpg

**sato**

NDC 49873-302-01

**STONA**  
**COUGH SYRUP**  
COUGH SUPPRESSANT

- ★もし、外箱の上ぶた、又は底のロブセンサーテープがはがされていたり、なくなっている場合は、購入しないでください。
- ★安全のため、容器のキャップには安全用シュリンク包装をしています。
- ★安全のために、この製品には幼児が開けられないように安全キャップを使用しています。  
開け方：キャップを押し下げながら時計と反対の方向に回してください。

**医薬品表示**

有効成分・分量 (10mL中)	配合目的
臭化水素酸デキストロメトルファン30mg	鎮咳剤
グアイフェネシン200mg	去痰剤

効能 風邪に伴う咳、咳の原因となるたんや気管支分泌物の緩和

**使用上の注意**

服用しないでください。

■モノアミノオキシダーゼ阻害剤 (MAOI) (うつ病、

S

# COUGH SUPPRESSANT, EXPECTORANT

WITH MEASURING CUP

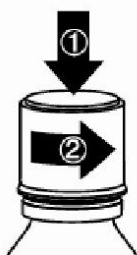

①  
TO OPEN: PUSH DOWN CAP  
AND TURN COUNTERCLOCK-  
WISE.

②  
開け方: キャップを押し下  
げながら時計と反対の方  
向に回してください。



③  
FASTEN THE CAP ON THE  
BOTTLE TIGHTLY.

瓶のふたをしっかりと閉め  
てください。

 サトウ製薬

精神病、情緒不安定、パーキンソン病などで処方されることのある薬)を服用している時は、本剤を服用しないでください。また、MAOI製剤の服用を中止してから2週間は本剤を服用しないでください。もしわからない場合には医師もしくは薬剤師にご相談ください。

■喫煙、喘息、慢性気管支炎、気腫などによる持続性又は慢性的咳や多量の痰(粘液)を伴う咳の場合は医師の指示がない限り服用しないでください。

持続する咳は重い症状の徴候である場合があります。1週間以上咳が持続する場合、再発する場合、又は発熱、発疹あるいは持続する頭痛を伴う場合は医師にご相談ください。

小児の手のとどかない所に保管してください。誤って過量を服用した場合、ただちに専門家又はポイズンコントロールセンターへ連絡してください。

妊娠していたり乳児に授乳している場合には本剤を服用前に、医師や薬剤師等の専門家の指示を受けてください。

### 用法・用量

■大人及び12才以上の小児: 1回10mLを6~8時間おきに服用してください。

ただし、24時間以内に30mLを超えないこと、又は医師の指示により服用してください。

■12才未満の小児: 医師にご相談ください。

その他の成分 アルコール、β-シクロデキストリン、パラオキシ安息香酸ブチル、塩化カルシウム、カラメル、クエン酸、香料、カンゾウエキス、パラオキシ安息香酸プロピル、安息香酸ナトリウム、サッカリンナトリウム、砂糖、精製水

Reports of serious side effects associated with use of this product can be sent to:  
SATO PHARMACEUTICAL, INC  
20501 Earl Street, Suite 3, Torrance, CA 90503

## STONA COUGH

dextromethorphan hydrobromide, guaifenesin syrup

### Product Information

Product Type	HUMAN OTC DRUG	Item Code (Source)	NDC:49873-302
Route of Administration	ORAL		

### Active Ingredient/Active Moiety

Ingredient Name	Basis of Strength	Strength
DEXTROMETHORPHAN HYDROBROMIDE (UNII: 9D2RT19KYH) (DEXTROMETHORPHAN - UNII: 7355X3ROTS)	DEXTROMETHORPHAN HYDROBROMIDE	30 mg in 10 mL

GUAIFENESIN (UNII: 495W7451VQ) (GUAIFENESIN - UNII:495W7451VQ)

GUAIFENESIN

200 mg  
in 10 mL**Inactive Ingredients**

Ingredient Name	Strength
<b>ALCOHOL</b> (UNII: 3K9958V90M)	
<b>BETADEX</b> (UNII: JV039JZZ3A)	
<b>BUTYLPARABEN</b> (UNII: 3QPI1U3FV8)	
<b>CALCIUM CHLORIDE</b> (UNII: M4I0D6VV5M)	
<b>CARAMEL</b> (UNII: T9D99G2B1R)	
<b>CITRIC ACID MONOHYDRATE</b> (UNII: 2968PHW8QP)	
<b>GLYCYRRHIZA GLABRA</b> (UNII: 2788Z9758H)	
<b>PROPYLPARABEN</b> (UNII: Z8IX2SC1OH)	
<b>SODIUM BENZOATE</b> (UNII: OJ245FE5EU)	
<b>SACCHARIN SODIUM</b> (UNII: SB8ZUX40TY)	
<b>SUCROSE</b> (UNII: C151H8M554)	
<b>WATER</b> (UNII: 059QF0KO0R)	

**Product Characteristics**

<b>Color</b>		<b>Score</b>	
<b>Shape</b>		<b>Size</b>	
<b>Flavor</b>	CHERRY (cherry brandy) , VANILLA	<b>Imprint Code</b>	
<b>Contains</b>			

**Packaging**

#	Item Code	Package Description	Marketing Start Date	Marketing End Date
1	NDC:49873-302-01	1 in 1 CARTON	01/03/2001	
1		120 mL in 1 BOTTLE; Type 0: Not a Combination Product		

**Marketing Information**

Marketing Category	Application Number or Monograph Citation	Marketing Start Date	Marketing End Date
OTC Monograph Drug	M012	01/03/2001	

**Labeler** - Sato Pharmaceutical Co., Ltd. (690575642)**Establishment**

Name	Address	ID/FEI	Business Operations
Sato Pharmaceutical Co., Ltd.		715699133	manufacture(49873-302) , label(49873-302) , pack(49873-302)