

OPTASE- glycerin solution/ drops
Scope Health Inc

Optase Dry Eye Intense Drops

Glycerin 0.2%

Keep out of reach of children. If swallowed get medical help or contact a poison control center right away.

Eye Lubricant

Warning

- For external use only.
- To avoid contamination, do not touch tip of container to any surface.
- If solution changes color or becomes cloudy, do not use.
- Do not use a damaged or punctured single-dose container.
- Wait at least 15 minutes between possible applications of other ophthalmic medication.

- Use immediately once opened.
- Do not reuse. Discard any remaining solution after use.
- Do not use if you are sensitive to any of the ingredients.
- Do not use after the expiry date shown on the pack.

• For use as a lubricant to prevent further irritation.

• May be used as a protectant against further irritation.

• To relieve dryness of the eye.

- Please wash your hands before use.
- Open the aluminium pouch and pull out the strip of single-dose containers.
- Remove one of the single-dose containers from the strip.
- Place the remaining single-dose containers back and close the pouch by folding the edge over.
- To open, twist and pull tab to remove.
- Do not touch the tip after opening the container.
- Put one or two drops in the affected eyes as needed
- Use immediately once opened.
- Do not reuse.
- Discard any remaining solution after use.
- No ingredients of animal origin.
- Contact lens compatible.

Inactive ingredients

Hydrochloric Acid, Sodium Hyaluronate, Sorbitol, Trometamol, Water



Patient Information Leaflet- 30 count

OPTASE®

DRY EYE INTENSE DROPS

Precautions and warnings

- For external use only.
- To avoid contamination, do not touch tip of container to any surface.
- If solution changes color or becomes cloudy, do not use.
- Do not use if you are sensitive to any of the ingredients.
- After usage of one single-dose container, the remaining liquid must be discarded, it is not intended for later usage. Do not use a damaged or punctured single-dose container.
- The container is for single person use only.
- Do not touch the eye or contact lens with the tip of the single-dose container.
- Do not touch the tip of the single-dose container with fingers.
- Do not use after the expiry date shown on the pack.
- Wait at least 15 minutes between possible applications of other ophthalmic medication.
- Keep out of the reach and sight of children.

- OPTASE® Dry Eye **INTENSE** Drops should not be stored above 25°C/77°F, and should be protected from direct sunshine and heat.
- Discard the empty single-dose container appropriately.
- Stop use and ask doctor for advice if you feel pain, changes in vision occur, redness or irritation of the eye or if condition worsens or lasts more than 72 hours.
- Do not use if you are sensitive to any of the ingredients. If in doubt, consult a healthcare professional.

Composition

Active Ingredient: Glycerin 0.2%

Inactive ingredients: Hydrochloric Acid, Sodium Hyaluronate, Sorbitol, Trometamol, Water.

This revision: June 2023

The OPTASE® brand and Scope logo are trademarks of Scope Ophthalmics Ltd.

SCOPE

Scope Health Inc.
79 Madison Av, 27 E 28th St. New
York, NY, 10016, USA

Phone: +1 917 795 4227
www.optase.com
hello@optase.com

OIS-101PL-1

OPTASE®

DRY EYE INTENSE DROPS

Instructions for Use – please read carefully
OPTASE® Dry Eye INTENSE Drops, solution
in single-dose containers

What this is and what it is intended for?

OPTASE® Dry Eye **INTENSE** Drops relieves symptoms of dry eyes such as irritation and burning sensations. This may also be used as a protectant against further irritation from dry eyes.

OPTASE® Dry Eye **INTENSE** Drops contains Glycerin. Glycerin is a humectant (moistening effect) that comes from plant sources. When applied topically to the eye, Glycerin protects and lubricates to relieve dryness and irritation. OPTASE® Dry Eye **INTENSE** Drops contains no alcohol, no preservatives, no ingredients of animal origin and are contact lens compatible.

Instructions for use

1. Please wash your hands before use.
2. Open the aluminium pouch and pull out the strip of single-dose containers.
3. Remove one of the single-dose containers from the strip (Fig. 1, below).
4. Place the remaining single-dose containers back and close the pouch by folding the edge over.
5. To open, twist and pull tab to remove. Do not touch the tip after opening the container (Fig. 2, below).
6. Lean your head back (Fig. 3, below).
7. Pull down your lower eyelid with your finger and hold the single-dose container in your other hand. Squeeze the container so that one drop falls into the eye (Fig. 4, below).
8. Close your eyes and press the tip of one finger against the inner corner of the eye for around 1-2 minutes. This will prevent the drop running through the tear duct into your throat and most of the drop will remain in the eye (Fig. 5, below). If necessary repeat steps 6 to 8 with your other eye.
9. Discard the single-dose container after use.



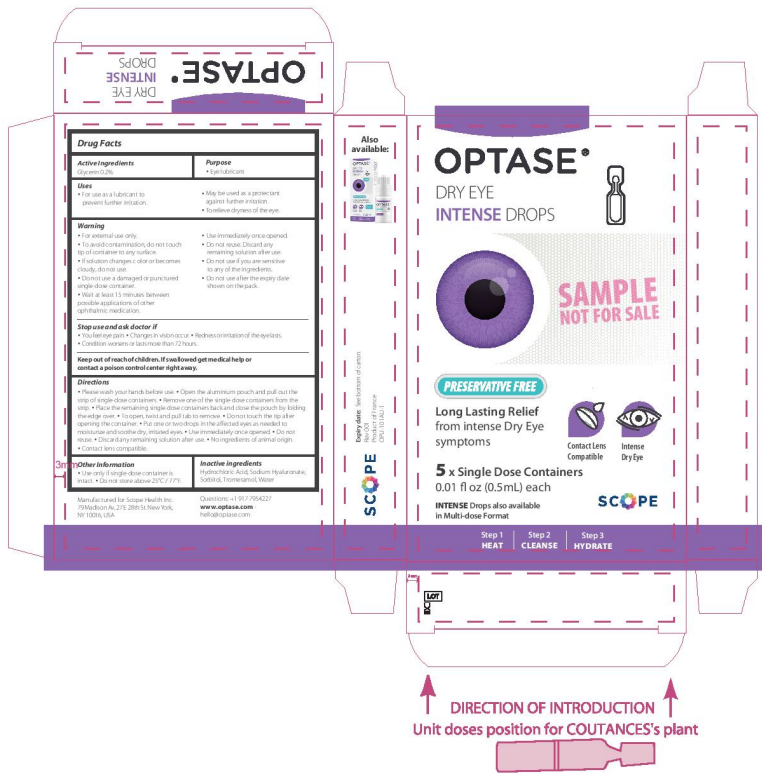

File information :							
Print colors:	Color 1	Color 2	Color 3	Color 4	Color 5	Color 6	Standard : 5 colors max + varnish
ECMA code :	A2120						
External dimensions :	75 x 20 x 120 mm						
Internal dimensions :	74.5 x 19.5 x 118.5 mm						
Packing :	5/6 vials of 0.25g						
Barcode :	Grade B minimum on customer artwork / Grade C on the printed packaging						
Technical colors :							
Diecut-Legendase	Text area		Lacquer-free area without text, graphics and color				
Color overhang area	Braille						
Revision history :							
V1 - 2007/18 : Creation TD standard x6							
V2 - 13/05/19 : Modification de la largeur int. à 74.5mm							
V3 - 07/08/19 : Déplacement de la donnée "g" (GTIN/CIP/PANTN) préimprimée							
V4 - 27/05/20 : Suppression des zones vignettes posées sur ligne							

Patient Information Leaflet- 5 count

OPTASE®

DRY EYE INTENSE DROPS

Precautions and warnings

- For external use only.
- To avoid contamination, do not touch tip of single-dose container to any surface.
- If solution changes color or becomes cloudy, do not use.
- Do not use if you are sensitive to any of the ingredients.
- After usage of one single-dose container, the remaining liquid must be discarded, it is not intended for later usage. Do not use a damaged or punctured single-dose container.
- The single-dose container is for single person use only.
- Do not touch the eye or contact lens with the tip of the single-dose container.
- Do not touch the tip of the single-dose container with fingers.
- Do not use after the expiry date shown on the pack.
- Wait at least 15 minutes between

possible applications of other ophthalmic medication.

- Keep out of the reach and sight of children.
- OPTASE® Dry Eye **INTENSE** Drops should not be stored above 25°C/77°F, and should be protected from direct sunshine and heat.
- Discard the empty single-dose container appropriately.
- Stop use and ask doctor for advice if you feel pain, changes in vision occur, redness or irritation of the eye or if condition worsens or lasts more than 72 hours.
- Do not use if you are sensitive to any of the ingredients. If in doubt, consult a healthcare professional.

Composition

Active Ingredient: Glycerin 0.2%
Inactive ingredients: Hydrochloric Acid, Sodium Hyaluronate, Sorbitol, Trometamol, Water.

This revision: June 2023

The OPTASE® brand and Scope logo are trademarks of Scope Ophthalmics Ltd.

SCOPE

Scope Health Inc.
79 Madison Av, 27 E 28th St. New
York, NY, 10016, USA

Phone: +1 917 795 4227
www.optase.com
hello@optase.com

OIS-101PL-1

OPTASE®

DRY EYE INTENSE DROPS

Instructions for Use – please read carefully
OPTASE® Dry Eye INTENSE Drops, solution in
single-dose containers

What this is and what it is intended for?

OPTASE® Dry Eye **INTENSE** Drops relieves symptoms of dry eyes such as irritation and burning sensations. This may also be used as a protectant against further irritation from dry eyes.

OPTASE® Dry Eye **INTENSE** Drops contains Glycerin. Glycerin is a humectant (moistening effect) that comes from plant sources. When applied topically to the eye, Glycerin protects and lubricates to relieve dryness and irritation. OPTASE® Dry Eye **INTENSE** Drops contains no alcohol, no preservatives, no ingredients of animal origin and are contact lens compatible.

Instructions for use

1. Please wash your hands before use.
2. Open the aluminium pouch and pull out the strip of single-dose containers.
3. Remove one of the single-dose containers from the strip (Fig. 1, below).
4. Place the remaining single-dose containers back and close the pouch by folding the edge over.
5. To open, twist and pull tab to remove. Do not touch the tip after opening the container (Fig. 2, below).
6. Lean your head back (Fig. 3, below).
7. Pull down your lower eyelid with your finger and hold the single-dose container in your other hand. Squeeze the container so that one drop falls into the eye (Fig. 4, below).
8. Close your eyes and press the tip of one finger against the inner corner of the eye for around 1-2 minutes. This will prevent the drop running through the tear duct into your throat and most of the drop will remain in the eye (Fig. 5, below). If necessary repeat steps 6 to 8 with your other eye.
9. Discard the single-dose container after use.

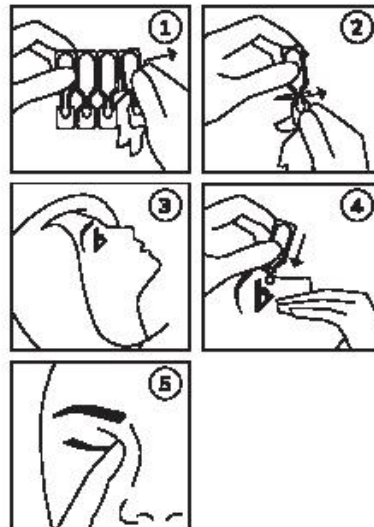

Single Dose Aluminum Foil Label- 5 pack

OPTASE®
DRY EYE
INTENSE
DROPS

5 x single-dose containers
 0.01 fl oz (0.5mL) each



Scope Health Inc., 79 Madison Av, 27 E 28th St, New York, NY 10016, USA
 Questions: +1 917 7954227 | www.optase.com | hello@optase.com

SCOPE
 OPI-101BU1-1

LOT
 EXP

OPTASE

glycerin solution/ drops

Product Information

Product Type	HUMAN OTC DRUG	Item Code (Source)	NDC:72972-007
Route of Administration	OPHTHALMIC		

Active Ingredient/Active Moiety

Ingredient Name	Basis of Strength	Strength
GLYCERIN (UNII: PDC6A3C0OX) (GLYCERIN - UNII:PDC6A3C0OX)	GLYCERIN	2 mg in 1 mL

Inactive Ingredients

Ingredient Name	Strength
HYALURONATE SODIUM (UNII: YSE9PPT4TH)	
HYDROCHLORIC ACID (UNII: QTT17582CB)	
WATER (UNII: 059QF0KO0R)	
TROMETHAMINE (UNII: 023C2WHX2V)	
SORBITOL (UNII: 506T60A25R)	

Packaging

	Marketing Start	Marketing End

#	Item Code	Package Description	Marketing Start Date	Marketing End Date
1	NDC:72972-007-30	1 in 1 BOX	02/07/2024	
1		30 in 1 DOSE PACK		
1		0.5 mL in 1 BOTTLE, UNIT-DOSE; Type 0: Not a Combination Product		
2	NDC:72972-007-05	1 in 1 BOX	02/07/2024	
2		5 in 1 DOSE PACK		
2		0.5 mL in 1 BOTTLE, UNIT-DOSE; Type 0: Not a Combination Product		

Marketing Information

Marketing Category	Application Number or Monograph Citation	Marketing Start Date	Marketing End Date
OTC Monograph Drug	M018	02/07/2024	

Labeler - Scope Health Inc (116778693)

Registrant - Scope Health Inc (116778693)

Revised: 2/2024

Scope Health Inc