

BRONCOCHEM EXPECTORANT II- acetaminophen-chlorpheniramine maleate-dextromethorphan hbr-guaifenesin-phenylephrine hcl syrup
LABORATORIO MAGNACHEM INTERNATIONAL SRL

BRONCOCHEM EXPECTORANT II

Warnings

Unless directed by a physician do not take this product if persistent or chronic cough such as occurs with smoking, asthma, chronic bronchitis, emphysema, or if cough is accompanied by excessive phlem (mucus). Likewise if you have heart disease, high blood pressure, thyroid disease, diabetes, or difficulty in urination due to enlargement of the prostate gland, if nervousness, dizziness, or sleeplesness occur, discontinue use or consult a doctor, if symptoms do not improve within 7 days or are accompanied by fever, consult a doctor. A persistent cough may be a sing of a serious condition. Stop use and ask a doctor if symptoms persist or last long that 5 days (children) or 7 days (adults), tend to return, arash, or persistent headache. As with any drug, if you are pregnant or nursing a baby; seek the advice of a healh professional before using this product. Unless directed by a doctor, do not take this product if you are presently taking another product containing Pseudoephedrine HCl, or if you are taking sedatives or trankilizers; it may increase the drowsiness effect. Avoid alcoholic beverages while taking this product. Use caution when driving a motor vehicle or operating machinery.

Active Ingredients

Acetaminophen

Dextromethorphan HBr

Guaifenesin

Phenylephrine HCl

Purpose

Analgesic

Antihistaminic

Antotussive

Expectorant

Decongestant

Keep Out Of the Reach Of children

In case of accidental overdose, seek professional assistancve or contact a poison control center immediately

Indications & Use

Bronchial congestion

Irritation of the respiratory passages

Nasal congestion

Helps loosen phlegm (mucus) and dilute bronchial secretions to make coughs more productive

Antitussive

Temporarily relieves allergy symptoms including runny nose, sneezing, stuffy nose, itchy nose, itchy throat, irritated and watery eyes, allergic rhinitis

Dosage and Administration

Do not exceed 6 doses in a 24 hour period

Adults and children 12 years and over: (10mL or cc) using metered dosage spoon every 4 hours.

Children 6 years up to 12 years: (5mL or cc) using metered dosage spoon every 4 hours

Drug Interaction Precautions

Do not use if you are now taking a prescription monoamine oxidase inhibitor (MAOI). (certain drugs for depression, psychiatric or emotional conditions, or Parkinson`s disease), or 2 weeks after stopping the MAOI drug. If you are uncertain whether your prescription drug contains an MAOI, consult a health professional before taking this product

Active Ingredient

Aloe Vera, Ammonium Glycyrrhizinate, Citric acid, Disodium EDTA, Glacial Acetic Acid, Natural Raspberry flavor, Propylene Glycol USP, Purified Water, FD&C Red No.40, Sodium Benzoate, Sodium Saccharin USP, Sorbitol 70%.

Package Label Principal Display Panel

223.58mm

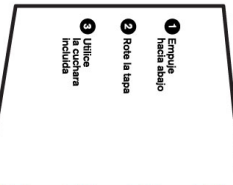

Broncochem®

EXPECTORANT SYRUP

NEW!

NDC 65131-011-68

Broncochem®

EXPECTORANT SYRUP

Contains Acetaminophen,
Dextromethorphan HBr,
Guaifenesin,
Phenylephrine HCL

Bronchial & nasal
decongestant
Loosens phlegm
Alcohol & sugar free

4 FL. OZ. (120 mL or cc)

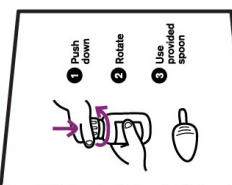

NUEVO!

NDC 65131-011-68

Broncochem®

EXPECTORANTE JARABE

Contiene Acetaminofén,
Dextrometorfán HBr,
Guaifenesina,
Fenilefrina HCL

Descongestionante
bronquial y nasal
Afloja la flema
Sin alcohol y sin azucar

4 FL. OZ. (120 mL ó cc)

Información del Medicamento

Ingredientes activos (en 10 mL ó cc)	Propósito
Acetaminofén..... 325.00 mg	Analgésico
Dextrometorfán HBr..... 20.00 mg	Antitusivo
Guaifenesina..... 400.00 mg	Expectorante
Fenilefrina HCL..... 10.00 mg	Descongestionante

Uso: Congestión Bronquial, Irritación de las vías respiratorias y bronquitis. Ayuda a aflojar las flemas (mucoosidad) y diluirlas, lo que hace más productiva la tos. Alivio temporal de los síntomas alérgicos tales como: Escorcimiento nasal, estornudos, picazón en la garganta o nariz, ojos lagrimeos o irritados, rinitis alérgica.

Advertencias

Advertencias sobre el Hígado: Este producto contiene acetaminofén. Puede causar daño hepático grave si usted toma:
■ más de 6 dosis en 24 horas, que es la cantidad diaria máxima
■ con otros medicamentos que contengan acetaminofén
■ 3 o más bebidas alcohólicas cuando utilice este producto
Advertencia sobre dolor de garganta: Si el dolor de garganta es intenso, dura más de 2 días, o va acompañado de fiebre, dolor de cabeza, sarpullido, náuseas o vómitos, consulte a un médico inmediatamente.

No usar

■ combinado con algún medicamento que contenga acetaminofén (con prescripción o no). Si usted no está seguro de que los medicamentos que usa, contienen o no acetaminofén, consulte a su médico o farmacéutico.
■ si está tomando algún producto que contenga inhibidores de la mono amina oxidasa (MAOI), o dos semanas después de haberlos suspendido. (Ciertos medicamentos para la depresión o condiciones Psicológicas, o enfermedad de Parkinson pueden contenerlos). Si usted no está seguro de que su receta contiene un MAOI, consulte a un profesional de la salud antes de tomar este producto.

Prepárese a su médico antes de usar, si usted tiene

■ enfermedad hepática ■ enfermedad cardíaca ■ presión arterial alta
■ enfermedad tiroidea ■ diabetes ■ problemas para orinar debido al agrandamiento de la próstata ■ tos con mucha flema (mucoosidad) ■ los que se crían, como ocurre con el tabaquismo, asma o enfisema.

Para el uso de este producto y prepárese a un médico

■ si se siente nervioso, mareado o muy asustado
■ si los síntomas duran más de 7 días en adultos o 5 días en los niños
■ si la tos regresa con irritación de la piel o dolor de cabeza que dure
■ si la fiebre persiste por más de 3 días.
Estos pueden ser signos de enfermedad grave.

Manténgase fuera del alcance de los niños. Si está embarazada o en período de lactancia, consulte a un profesional de la salud antes de usar.

Advertencia de seguridad: En caso de sobredosis accidental, busque la ayuda profesional o acuda a un Centro de Intoxicaciones inmediatamente.

Instrucciones: Siga las recomendaciones detalladas más abajo. Para su conveniencia, encontrará dentro de la caja una cucharita dosificadora. No exceda de 6 dosis en un período de 24 horas.

adultos y niños de 12 años en adelante 10 mL ó cc cada 4 horas
niños de 6 años hasta 12 años 5 mL ó cc cada 4 horas

Información adicional: ■ Conservar a 20-25 °C (68-77 °F) ■ 10 mL contiene 10 mg de sodio. ■ No lo use si la tapa está alterada o rota.

Ingredientes Inactivos: Ácido ascórbico glicilado, sodio citrato, agua purificada, benzoato sódico, Color rojo FD &C #40, cloruro sódico, edulcorante (sacarina), glicinato de potasio, propileno glycol USP, saborizante natural, sacarina sódica USP, sorbitol 70% USP.

Preguntas? 1-661-338-6221 o visiten www.broncochem.com

Fabricado en República Dominicana
Exclusivamente para: Global Corporation, Inc., Boca Raton, FL 33487 USA.

REGISTRADO EN LA FDA



INSTITUTO DE CALIDAD DE CALIDAD
Padilla
Instituto de Calidad
A-40147 R.2

Please recycle
Favor reciclar

Drug Facts

Active ingredients (in 10 mL or cc)

Acetaminophen..... 325.00 mg	Purpose
Dextromethorphan HBr..... 20.00 mg	Analgésico
Guaifenesin..... 400.00 mg	Antitusivo
Phenylephrine HCL..... 10.00 mg	Expectorante

Uso: Bronchial congestion, irritation of the respiratory passages, nasal congestion. Helps loosen phlegm (mucus) and dilute bronchial secretions to make coughs more productive. Temporarily relieves allergy symptoms including runny nose, sneezing, itchy nose, itchy nose, itchy throat, irritated and watery eyes, allergic rhinitis.

Warnings

Liver warning: This product contains acetaminophen. Severe liver damage may occur if you take:
■ more than 6 doses in 24 hours, which is the maximum daily amount for this product
■ with other drugs containing acetaminophen

■ 3 or more alcoholic drinks every day while using this product.
Severe throat warning: If your throat is severe, persists for more than 2 days, is accompanied or followed by fever, headache, rash, nausea, or vomiting, consult a doctor promptly.

Do not use

■ with any other drug containing acetaminophen (prescription or nonprescription). If you are not sure whether a drug contains acetaminophen, ask a doctor or pharmacist.
■ if you are now taking a prescription monoamine oxidase inhibitor (MAOI) (certain drugs for depression, psychiatric or emotional conditions, or Parkinson's disease), or 2 weeks after stopping the MAOI drug. If you are uncertain whether your prescription drug contains an MAOI, ask a doctor or pharmacist before taking this product.

Ask a doctor before use if you have

■ liver disease ■ heart disease ■ high blood pressure
■ thyroid disease ■ diabetes ■ trouble urinating due to enlarged prostate gland ■ cough that occurs with too much phlegm (mucus)
■ persistent or chronic cough such as occurs with smoking, asthma, chronic bronchitis, or emphysema.

Stop use and ask a doctor if

■ you get nervous, dizzy or sleepless
■ symptoms last more than 7 days (adults) or 5 days (children)
■ cough comes back or occurs with rash or headache that lasts
■ fever gets worse or lasts more than 3 days.
These could be signs of a serious condition.

Keep out of the reach of children.

If pregnant or breast-feeding, ask a health professional before use.

Overdose warning: In case of accidental overdose, seek professional assistance or contact a poison control center immediately.

Directions

Take only as directed. For your convenience, a dosage spoon is provided. Do not exceed 6 doses in a 24-hour period.
adults and children 12 years and over 10 mL, or cc every 4 hours
children 6 to under 12 years of age 5 mL, or cc every 4 hours

Other information

■ Store at 68-77 °F (20-25 °C) ■ 10mL, or cc contains sodium 10mg. ■ Do not use if cap is altered or broken.

Inactive ingredients: Ammonium glycyrrhizinate, citric acid, disodium EDTA, glycolic acid, natural strawberry flavor, propylene glycol, purified water, Red color #40700, sodium benzoate, sodium chlorides, sodium saccharin USP, sorbitol 70% USP.

Questions? 1-661-338-6221 or visit us at www.broncochem.com

Made in Dominican Republic
Exclusively for: Global Corporation, Inc., Boca Raton, FL 33487 USA.

FDA REGISTERED

Batch / Lote:
Expiration date:



ACETAMINOPHEN (UNII: 36Z091TE9D) (ACETAMINOPHEN - UNII:36Z091TE9D)	ACETAMINOPHEN	in 10 mL
DEXTROMETHORPHAN HYDROBROMIDE (UNII: 9D2RTI9KYH) (DEXTROMETHORPHAN - UNII:7355X3ROTS)	DEXTROMETHORPHAN HYDROBROMIDE	20 mg in 10 mL
GUAIFENESIN (UNII: 495W7451VQ) (GUAIFENESIN - UNII:495W7451VQ)	GUAIFENESIN	400 mg in 10 mL
PHENYLEPHRINE HYDROCHLORIDE (UNII: 04JA59TNSJ) (PHENYLEPHRINE - UNII:1WS297W6MV)	PHENYLEPHRINE	10 mg in 10 mL

Inactive Ingredients

Ingredient Name	Strength
SACCHARIN SODIUM (UNII: SB8ZUX40TY)	40 mg in 10 mL
SODIUM BENZOATE (UNII: OJ245FE5EU)	20 mg in 10 mL
SODIUM CHLORIDE (UNII: 451W47IQ8X)	12 mg in 10 mL
AMMONIUM GLYCYRRHIZATE (UNII: 3VRD35U26C)	6 mg in 10 mL
DISODIUM HEDTA (UNII: KME849MC7A)	5 mg in 10 mL
CITRIC ACID MONOHYDRATE (UNII: 2968PHW8QP)	2 mg in 10 mL
SORBITOL (UNII: 506T60A25R)	2.3 mL in 10 mL
PROPYLENE GLYCOL (UNII: 6DC9Q167V3)	2 mL in 10 mL
ACETIC ACID (UNII: Q40Q9N063P)	0.016 mL in 10 mL
RASPBERRY (UNII: 4N14V5R27W)	0.006 mL in 10 mL
FD&C RED NO. 40 (UNII: WZB9127XOA)	0.29 mg in 10 mL
WATER (UNII: 059QF0KO0R)	10 mL in 10 mL

Packaging

#	Item Code	Package Description	Marketing Start Date	Marketing End Date
1	NDC:65131-011-68	1 in 1 BOX	04/21/2025	
1		120 mL in 1 BOTTLE, PLASTIC; Type 0: Not a Combination Product		

Marketing Information

Marketing Category	Application Number or Monograph Citation	Marketing Start Date	Marketing End Date
OTC Monograph Drug	M	04/21/2025	

Labeler - LABORATORIO MAGNACHEM INTERNATIONAL SRL (871446100)

Registrant - LABORATORIO MAGNACHEM INTERNATIONAL SRL (871446100)

Establishment

Name	Address	ID/FEI	Business Operations
LABORATORIO MAGNACHEM INTERNATIONAL SRL		871446100	manufacture(65131-011)