

RETATRUTIDE PEN- retatrutide pen injection, solution
Guangzhou Yixin Cross-border E-commerce Co., Ltd.

Active ingredient (in each 0.75 mL pen)

Retatrutide — 10 mg

Purpose

Antidiabetic / Weight management agent

Uses

To improve blood glucose control in adults with type 2 diabetes.

For long-term weight management and reduction of visceral fat in adults who are overweight or obese, with or without diabetes.

Warnings

Pancreatitis: Acute pancreatitis has been reported with GLP-1 receptor agonists. If severe or persistent abdominal pain occurs (with or without vomiting), stop using RETATRUTIDE and contact your healthcare provider immediately.

Allergic reactions: Serious hypersensitivity reactions (including anaphylaxis) have been reported.

Stop use and seek medical attention if you develop rash, swelling, or difficulty breathing.

Severe gastrointestinal disease: RETATRUTIDE has not been studied in patients with severe GI disorders; use is not recommended.

Gallbladder disease: Acute gallbladder events, including cholelithiasis, have occurred. Evaluate promptly if gallbladder disease is suspected.

Hypoglycemia warning:

Do not use RETATRUTIDE if you have a history of recurrent or severe hypoglycemia.

RETATRUTIDE may further lower blood glucose levels. Use is contraindicated in individuals with baseline hypoglycemia or conditions predisposing to hypoglycemia.

Pregnancy and breastfeeding: Do not use if pregnant or breastfeeding.

Pediatric use: Not for use in children.

Drug Interactions / Precautions

Other antidiabetic medications: Retatrutide lowers blood glucose. Using it with insulin or sulfonylureas may increase the risk of hypoglycemia. Blood glucose should be closely monitored; doses of other antidiabetic drugs may need adjustment.

Drugs affecting gastrointestinal motility: Retatrutide may delay gastric emptying. Co-

administration with prokinetic agents (e.g., domperidone) or antacids may alter absorption or worsen GI discomfort.

Cardiovascular medications: Caution with statins, digoxin, or warfarin.

Statins: absorption may be affected; monitor lipid levels.

Warfarin: changes in metabolism may alter anticoagulant effects; monitor INR levels.

General precautions: Retatrutide should be used only under medical supervision. Inform your healthcare provider about all medications, including prescription, over-the-counter, and herbal products.

Possible side effects

Common: nausea, diarrhea, decreased appetite, vomiting, constipation, indigestion, abdominal pain.

Stop use and contact a doctor if symptoms become severe or persistent.

When to stop and call your doctor

Stop using the pen and contact your physician if you experience:

- Severe or persistent abdominal pain or vomiting
- Symptoms of an allergic reaction
- Signs of pancreatitis
- Any other unexpected or severe reaction

Titration schedule:

Weeks 1–4 0.19 mL (2.5 mg) once weekly

Weeks 5–8 0.37 mL (5 mg) once weekly

Weeks 9–12 0.56 mL (7.5 mg) once weekly

Week 13 and beyond 0.75 mL (10 mg) once weekly

Directions for Use

- For subcutaneous injection only.
- Inject once weekly on the same day each week, any time of day, with or without meals.
- Recommended injection sites: abdomen, thigh, or upper arm.
- Clean the injection site with alcohol before injection.
- Rotate injection sites each week.
- Use a new needle for each injection. Do not share your pen.

Uses

- To improve blood glucose control in adults with type 2 diabetes.

- For long-term weight management and reduction of visceral fat in adults who are overweight or obese, with or without diabetes.

Warnings

Pancreatitis: Acute pancreatitis has been reported with GLP-1 receptor agonists. If severe or persistent abdominal pain occurs (with or without vomiting), stop using RETATRUTIDE and contact your healthcare provider immediately.

Allergic reactions: Serious hypersensitivity reactions (including anaphylaxis) have been reported.

Stop use and seek medical attention if you develop rash, swelling, or difficulty breathing.

Severe gastrointestinal disease: RETATRUTIDE has not been studied in patients with severe GI disorders; use is not recommended.

Gallbladder disease: Acute gallbladder events, including cholelithiasis, have occurred. Evaluate promptly if gallbladder disease is suspected.

Hypoglycemia warning:

Do not use RETATRUTIDE if you have a history of recurrent or severe hypoglycemia.

RETATRUTIDE may further lower blood glucose levels. Use is contraindicated in individuals with baseline hypoglycemia or conditions predisposing to hypoglycemia.

Pregnancy and breastfeeding: Do not use if pregnant or breastfeeding.

Pediatric use: Not for use in children.

Drug Interactions / Precautions

Other antidiabetic medications: Retatrutide lowers blood glucose. Using it with insulin or sulfonylureas may increase the risk of hypoglycemia. Blood glucose should be closely monitored; doses of other antidiabetic drugs may need adjustment.

Drugs affecting gastrointestinal motility: Retatrutide may delay gastric emptying. Co-administration with prokinetic agents (e.g., domperidone) or antacids may alter absorption or worsen GI discomfort.

Cardiovascular medications: Caution with statins, digoxin, or warfarin.

Statins: absorption may be affected; monitor lipid levels.

Warfarin: changes in metabolism may alter anticoagulant effects; monitor INR levels.

General precautions: Retatrutide should be used only under medical supervision. Inform your healthcare provider about all medications, including prescription, over-the-counter, and herbal products.

Possible side effects

Common: nausea, diarrhea, decreased appetite, vomiting, constipation, indigestion, abdominal pain.

Stop use and contact a doctor if symptoms become severe or persistent.

When to stop and call your doctor

Stop using the pen and contact your physician if you experience:

- Severe or persistent abdominal pain or vomiting

- Symptoms of an allergic reaction
- Signs of pancreatitis
- Any other unexpected or severe reaction

stop use

Pancreatitis: Acute pancreatitis has been reported with GLP-1 receptor agonists. If severe or persistent abdominal pain occurs (with or without vomiting), stop using RETATRUTIDE and contact your healthcare provider immediately.

Allergic reactions: Serious hypersensitivity reactions (including anaphylaxis) have been reported.

Stop use and seek medical attention if you develop rash, swelling, or difficulty breathing.

Severe gastrointestinal disease: RETATRUTIDE has not been studied in patients with severe GI disorders; use is not recommended.

Gallbladder disease: Acute gallbladder events, including cholelithiasis, have occurred. Evaluate promptly if gallbladder disease is suspected.

Hypoglycemia warning:

Do not use RETATRUTIDE if you have a history of recurrent or severe hypoglycemia.

RETATRUTIDE may further lower blood glucose levels. Use is contraindicated in individuals with baseline hypoglycemia or conditions predisposing to hypoglycemia.

Pregnancy and breastfeeding: Do not use if pregnant or breastfeeding.

Pediatric use: Not for use in children.

Drug Interactions / Precautions

Other antidiabetic medications: Retatrutide lowers blood glucose. Using it with insulin or sulfonylureas may increase the risk of hypoglycemia. Blood glucose should be closely monitored; doses of other antidiabetic drugs may need adjustment.

Drugs affecting gastrointestinal motility: Retatrutide may delay gastric emptying. Co-administration with prokinetic agents (e.g., domperidone) or antacids may alter absorption or worsen GI discomfort.

Cardiovascular medications: Caution with statins, digoxin, or warfarin.

Statins: absorption may be affected; monitor lipid levels.

Warfarin: changes in metabolism may alter anticoagulant effects; monitor INR levels.

General precautions: Retatrutide should be used only under medical supervision. Inform your healthcare provider about all medications, including prescription, over-the-counter, and herbal products.

Possible side effects

Common: nausea, diarrhea, decreased appetite, vomiting, constipation, indigestion, abdominal pain.

Stop use and contact a doctor if symptoms become severe or persistent.

When to stop and call your doctor

Stop using the pen and contact your physician if you experience:

- Severe or persistent abdominal pain or vomiting
- Symptoms of an allergic reaction
- Signs of pancreatitis
- Any other unexpected or severe reaction

Keep out of reach of children.

Keep out of reach of children

Inactive ingredients

Sterile Water for Injection

PRINCIPAL DISPLAY PANEL

10mg减肥注射器-水剂款-双插盒外盒
尺寸:176x25x80mm
工艺:350g白卡过光膜, 四色印,指定位置激凸
内托:350g白卡纸折卡托



激凸版

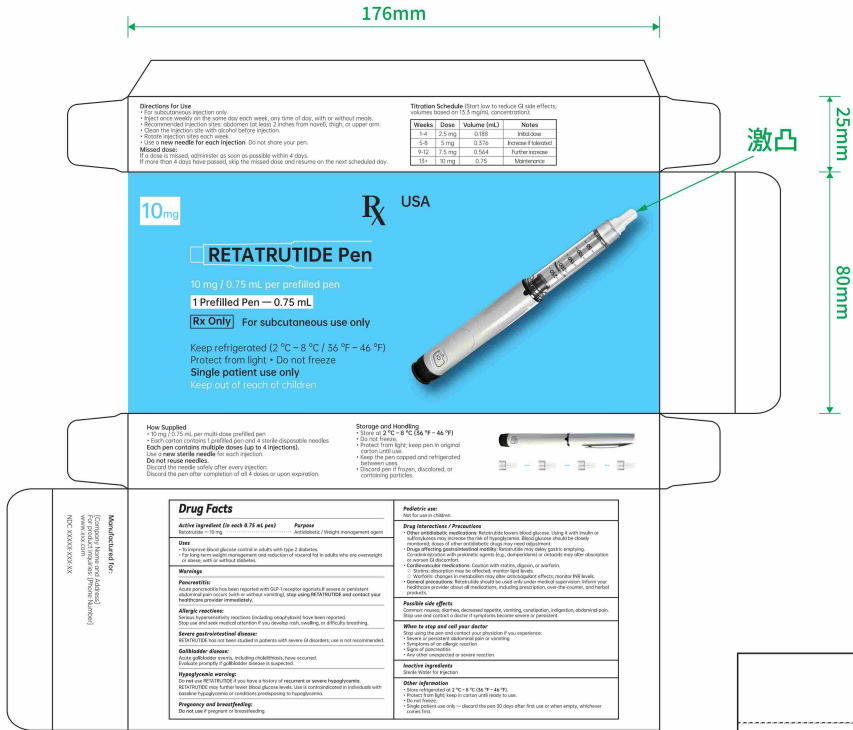

减肥注射器-水剂款-内包标贴
尺寸:40x15mm
工艺:合成纸不干胶, 四色印过光膜



内托:350g白卡
纸折摆放示意
尺寸根据外盒实际尺寸而定
槽尺寸深度按包材(可按实际大小调整)

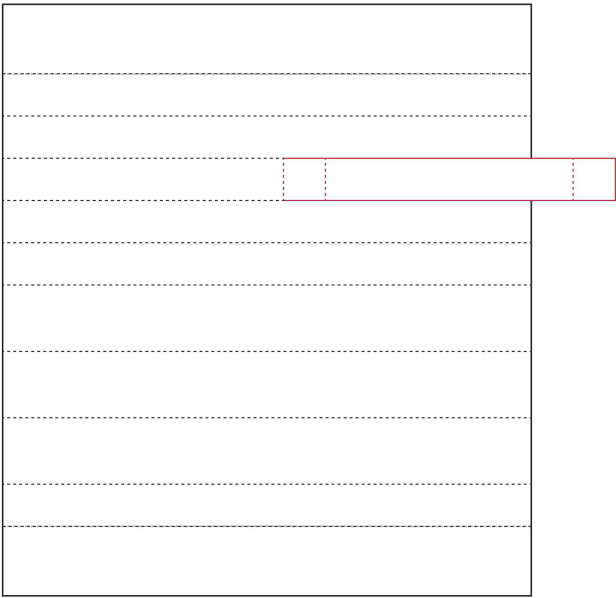
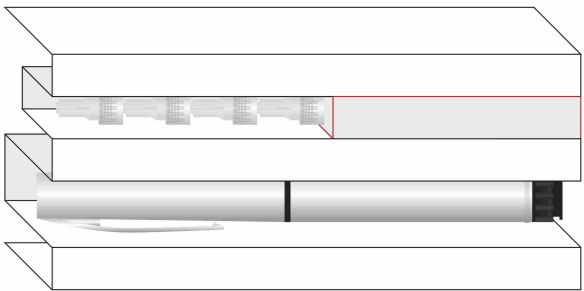

30mg减肥注射器-水剂款-双插盒外盒
尺寸:176x25x80mm
工艺:350g白卡过光膜, 四色印,指定位置激凸
内托:350g白卡纸折卡托



激凸版

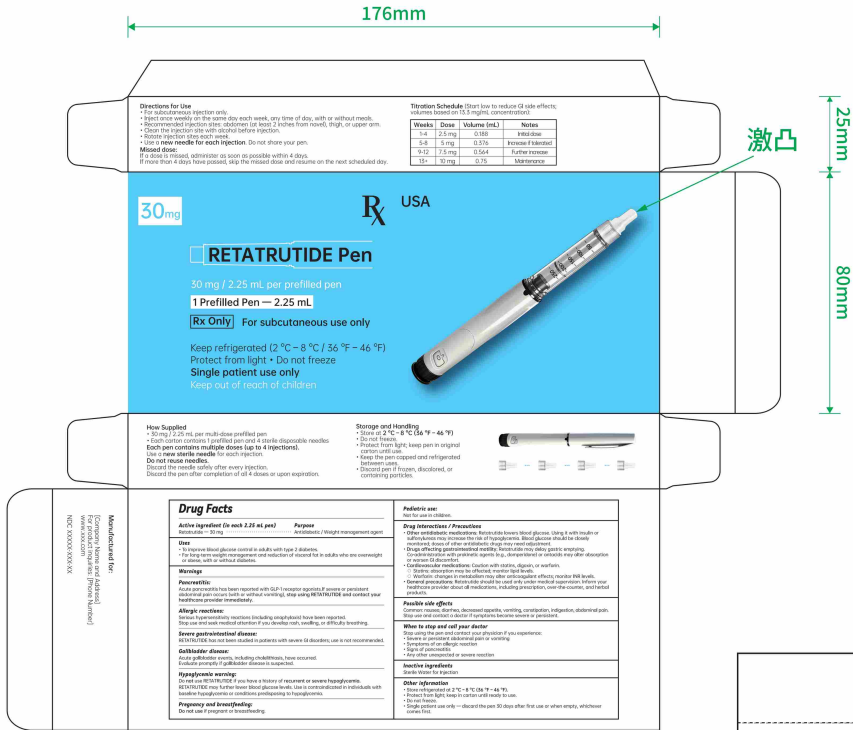

减肥注射器-水剂款-内包标贴
尺寸:40x15mm
工艺:合成纸不干胶, 四色印过光膜



内托:350g白卡
纸折摆放示意
尺寸根据外盒实际尺寸而定
槽尺寸深度按包材(可按实际大小调整)

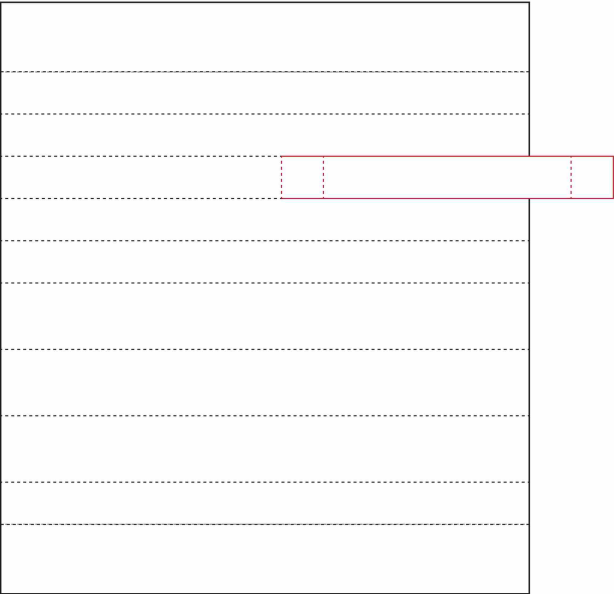
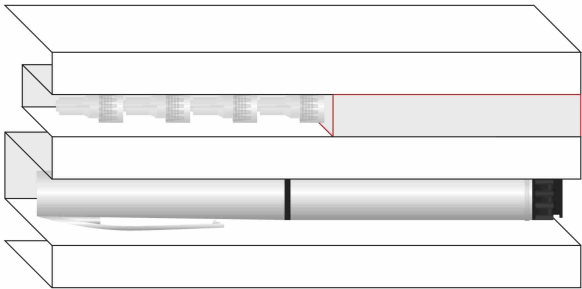

40mg减肥注射器-水剂款-双插盒外盒
尺寸:176x25x80mm
工艺:350g白卡过光膜, 四色印,指定位置激凸
内托:350g白卡纸折卡托



激凸版

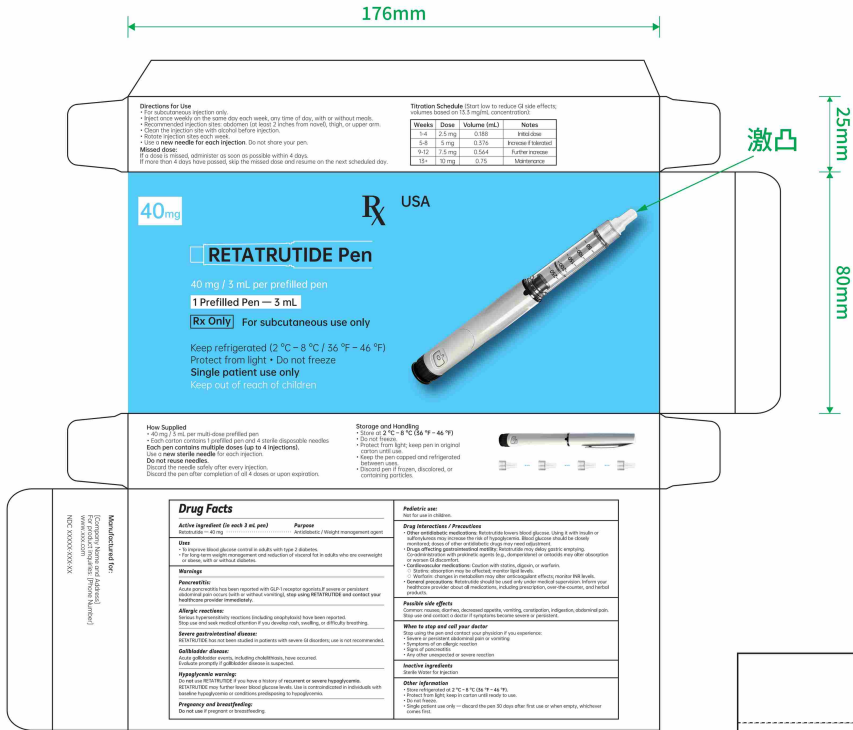

减肥注射器-水剂款-内包标贴
尺寸:40x15mm
工艺:合成纸不干胶, 四色印过光膜



内托:350g白卡
纸折摆放示意
尺寸根据外盒实际尺寸而定
槽尺寸深度按包材(可按实际大小调整)

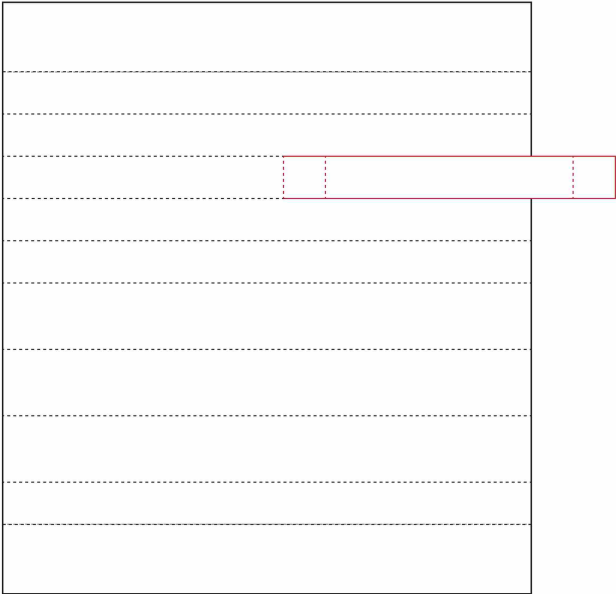
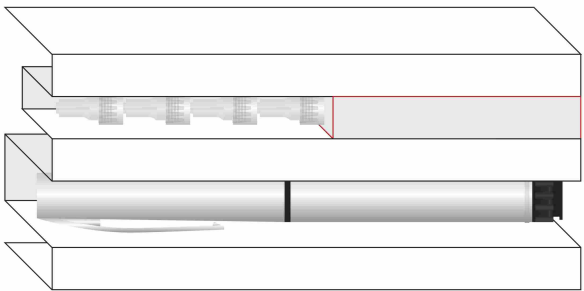

RETATRUTIDE PEN

retatrutide pen injection, solution

Product Information			
Product Type	HUMAN PRESCRIPTION DRUG	Item Code (Source)	NDC:84778-106
Route of Administration	SUBCUTANEOUS		

Active Ingredient/Active Moiety

Ingredient Name	Basis of Strength	Strength
RETATRUTIDE (UNII: NOP2Y096GV) (RETATRUTIDE - UNII:NOP2Y096GV)	RETATRUTIDE	10 mg in 100 mL

Inactive Ingredients

Ingredient Name	Strength
AQUA (UNII: 059QF0KO0R)	

Packaging

#	Item Code	Package Description	Marketing Start Date	Marketing End Date
1	NDC:84778-106-01	4 in 1 BOX	10/29/2025	
1		0.75 mL in 1 PAIL; Type 3: Prefilled Biologic Delivery Device/System (syringe, patch, etc.)		
2	NDC:84778-106-02	4 in 1 BOX	10/29/2025	
2		2.25 mL in 1 SYRINGE; Type 3: Prefilled Biologic Delivery Device/System (syringe, patch, etc.)		
3	NDC:84778-106-03	4 in 1 BOX	10/29/2025	
3		3 mL in 1 SYRINGE; Type 3: Prefilled Biologic Delivery Device/System (syringe, patch, etc.)		

Marketing Information

Marketing Category	Application Number or Monograph Citation	Marketing Start Date	Marketing End Date
Export only		10/29/2025	

Labeler - Guangzhou Yixin Cross-border E-commerce Co., Ltd. (455800881)

Registrant - Guangzhou Yixin Cross-border E-commerce Co., Ltd. (455800881)

Establishment

Name	Address	ID/FEI	Business Operations
Guangzhou Yixin Cross-border E-commerce Co., Ltd.		455800881	label(84778-106) , manufacture(84778-106)