

NATURAL CONCEPTS- ethyl alcohol gel
Apollo Health and Beauty Care Inc

NDC- 63148-522, Natural Concepts Hand Sanitizers.

Active Ingredients

Ethyl Alcohol (70%)

Purpose

Antiseptic

Uses

For Personal hand hygiene to help the spread of bacteria and can be used in place of hand washing if soap and water are not available.

Warnings

- For External use only
- Flammable
- Keep away from source of heat or fire.

When using this product

Avoid contact with eyes. If contact occurs, rinse thoroughly with water. Do not Inhale.

Do not use

- on children less than 2 months of age
- on open skin wounds
- on broken or damaged skin

Stop use and ask a doctor

If Irritation or redness develops and lasts.

Keep out of reach of children

In case of accidental ingestion, get medical help or contact a Poison Control Centre immediately

Directions

- For occasional and personal use
- Rub thoroughly into hands for at least 30 seconds. Allow to dry
- Children under 6 years should be supervised when using this product

Other Information

- Store at a temperature below 110 °F (43 °C)
- May discolor certain fabrics or surfaces

Inactive Ingredients

Water (Aqua), PEG-6, Fragrance (Parfum), Isopropyl Alcohol, Glycerin, Isopropyl Myristate, Aloe Barbadensis Leaf Juice, Tocopheryl Acetate, AMP-Acrylates/Vinyl Isodecanate Crosspolymer

Questions or comments ?

1-866-695-3030

Principal Display Panel 2 oz



FRONT
WHITE SUBSTRATE

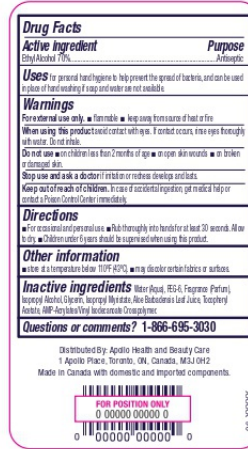

BACK
WHITE SUBSTRATE

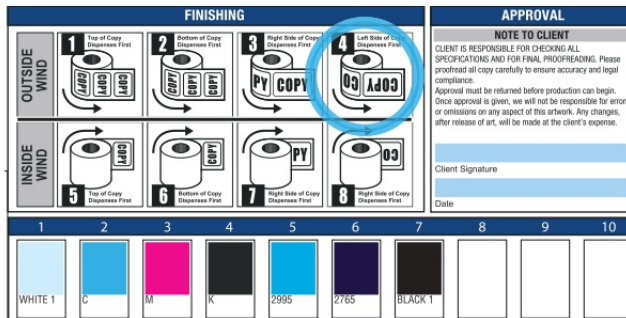

Principal Display Panel 8 oz



FRONT
CLEAR SUBSTRATE

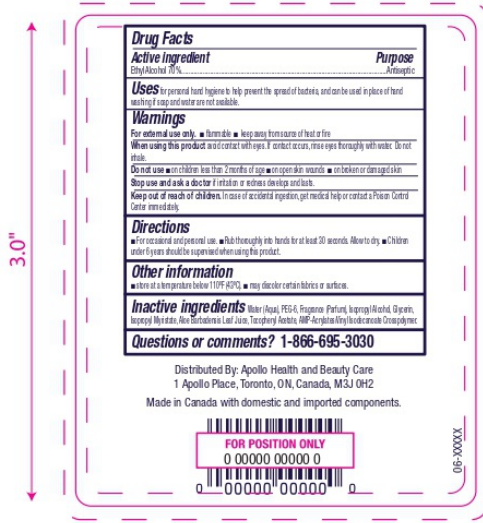

BACK
WHITE SUBSTRATE

FINISHING				APPROVAL						
OUTSIDE WIND	1 Top of Copy Dispenses First	2 Bottom of Copy Dispenses First	3 Right Side of Copy Dispenses First	4 Left Side of Copy Dispenses First	NOTE TO CLIENT CLIENT IS RESPONSIBLE FOR CHECKING ALL SPECIFICATIONS AND FOR FINAL PROOFREADING. Please proofread all copy carefully to ensure accuracy and legal compliance. Approval must be returned before production can begin. Once approval is given, we will not be responsible for errors or omissions on any aspect of this artwork. Any changes after release of art, will be made at the client's expense. Client Signature _____ Date _____					
	5 Top of Copy Dispenses First	6 Bottom of Copy Dispenses First	7 Right Side of Copy Dispenses First			8 Left Side of Copy Dispenses First				
1	2	3	4	5		6	7	8	9	10
WHITE 1	C	M	K	2995		2765	BLACK 1			

Principal Display Panel 15 oz

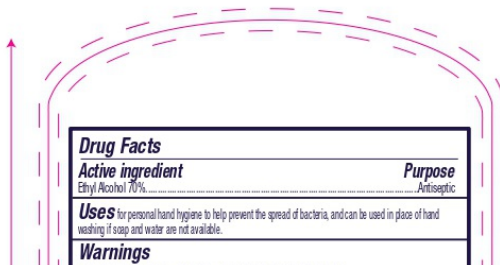



FRONT
CLEAR SUBSTRATE

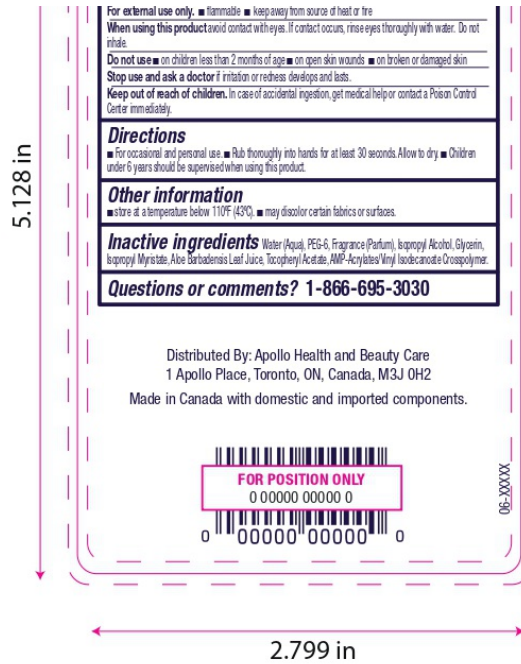

BACK
WHITE SUBSTRATE

FINISHING								APPROVAL	
OUTSIDE WIND	1	2	3	4	INSIDE WIND	5	6	NOTE TO CLIENT CLIENT IS RESPONSIBLE FOR CHECKING ALL SPECIFICATIONS AND FOR FINAL PROOFREADING. Please proofread all copy carefully to ensure accuracy and legal compliance. Approval must be returned before production can begin. Once approval is given, we will not be responsible for errors or omissions on any aspect of this artwork. Any changes, after release of art, will be made at the client's expense.	
	7	8	Client Signature _____ Date _____						
1	2	3	4	5	6	7	8	9	10
WHITE 1	C	M	K	2995	2765	BLACK 1			

Principal Display Panel 32 oz

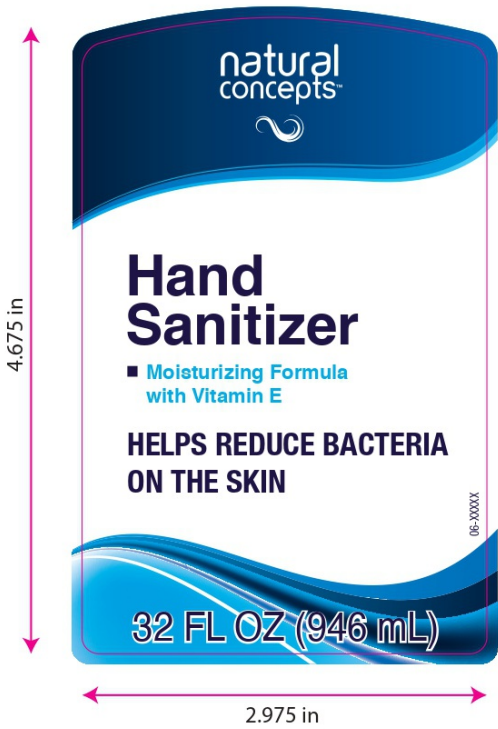

FRONT
WHITE SUBSTRATE

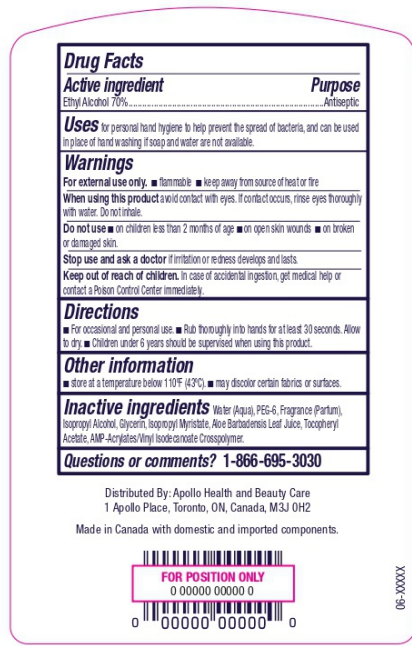

BACK
WHITE SUBSTRATE

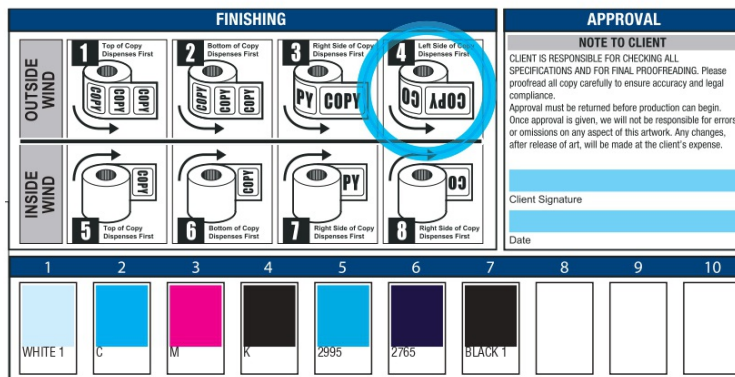

Principal Display Panel 40 oz



FRONT
CLEAR SUBSTRATE

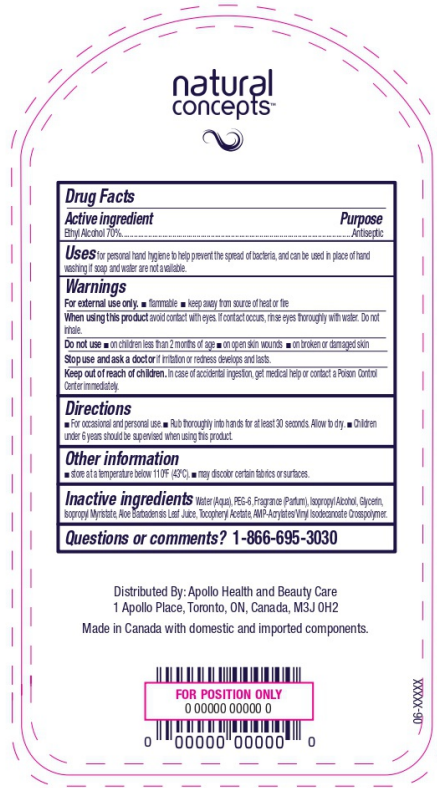

BACK
WHITE SUBSTRATE

FINISHING								APPROVAL	
OUTSIDE WIND	1	2	3	4	5	6	7	NOTE TO CLIENT CLIENT IS RESPONSIBLE FOR CHECKING ALL SPECIFICATIONS AND FOR FINAL PROOFREADING. Please proofread all copy carefully to ensure accuracy and legal compliance. Approval must be returned before production can begin. Once approval is given, we will not be responsible for errors or omissions on any aspect of the artwork. Any changes, after release of art, will be made at the client's expense.	
	Top of Copy Dispenses First	Bottom of Copy Dispenses First	Right Side of Copy Dispenses First	Left Side of Copy Dispenses First					
INSIDE WIND	5	6	7	8	Client Signature _____ Date _____				
	Top of Copy Dispenses First	Bottom of Copy Dispenses First	Right Side of Copy Dispenses First	Right Side of Copy Dispenses First					
1	2	3	4	5	6	7	8	9	10
WHITE 1	C	M	K	2995	2765	BLACK 1			

Principal Display Panel 64 oz



FINISHING								APPROVAL	
OUTSIDE WIND	1	2	3	4	INSIDE WIND	5	6	NOTE TO CLIENT CLIENT IS RESPONSIBLE FOR CHECKING ALL SPECIFICATIONS AND FOR FINAL PROOFREADING. Please proofread all copy carefully to ensure accuracy and legal compliance. Approval must be returned before production can begin. Once approval is given, we will not be responsible for errors or omissions on any aspect of this artwork. Any changes, after release of art, will be made at the client's expense.	
	7	8	Client Signature _____ Date _____						
1	2	3	4	5	6	7	8	9	10
WHITE 1	C	M	K	2395	2765	BLACK 1			

Principal Display Panel 128 oz

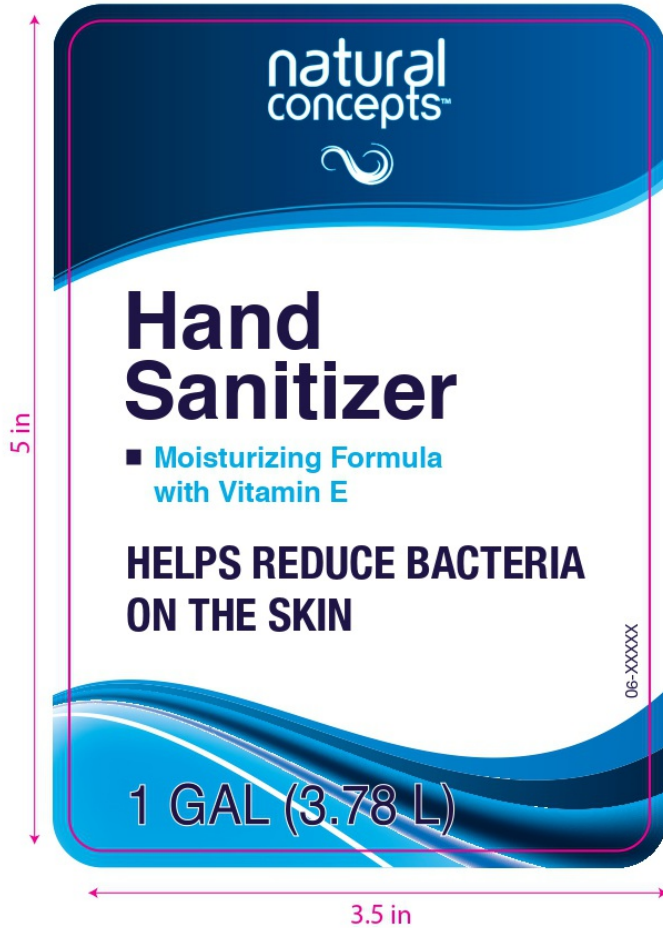

Drug Facts	
Active ingredient Ethyl Alcohol 70%.....	Purpose Antiseptic
Uses for personal hand hygiene to help prevent the spread of bacteria, and can be used in place of hand washing if soap and water are not available.	
Warnings	
For external use only. ■ flammable ■ keep away from source of heat or fire	
When using this product avoid contact with eyes. If contact occurs, rinse eyes thoroughly with water. Do not inhale.	
Do not use ■ on children less than 2 months of age ■ on open skin wounds ■ on broken or damaged skin	
Stop use and ask a doctor if irritation or redness develops and lasts.	
Keep out of reach of children. In case of accidental ingestion, get medical help or contact a Poison Control Center immediately.	
Directions	
■ For occasional and personal use. ■ Rub thoroughly into hands for at least 30 seconds. Allow to dry. ■ Children under 6 years should be supervised when using this product.	
Other information	
■ store at a temperature below 110°F (43°C). ■ may discolor certain fabrics or surfaces.	
Inactive ingredients Water (Aqua), PEG-6, Fragrance (Parfum), Isopropyl Alcohol, Glycerin, Isopropyl Myristate, Aloe Barbadensis Leaf Juice, Tocopheryl Acetate, AMP-Acrylates/Vinyl Isododecanoate Crosspolymer.	
Questions or comments? 1-866-695-3030	

Distributed By: Apollo Health and Beauty Care
1 Apollo Place, Toronto, ON, Canada, M3J 0H2
Made in Canada with domestic and imported components.

0 00000 00000 0

White Bopp

ethyl alcohol gel

Product Information

Product Type	HUMAN OTC DRUG	Item Code (Source)	NDC:63148-522
Route of Administration	TOPICAL		

Active Ingredient/Active Moiety

Ingredient Name	Basis of Strength	Strength
ALCOHOL (UNII: 3K9958V90M) (ALCOHOL - UNII:3K9958V90M)	ALCOHOL	700 mg in 1 mL

Inactive Ingredients

Ingredient Name	Strength
WATER (UNII: 059QF0KO0R)	
POLYETHYLENE GLYCOL 300 (UNII: 5655G9Y8AQ)	
ISOPROPYL ALCOHOL (UNII: ND2M416302)	
GLYCERIN (UNII: PDC6A3C0OX)	
ISOPROPYL MYRISTATE (UNII: 0RE8K4LNJS)	
ALOE VERA LEAF (UNII: ZY81Z83H0X)	
.ALPHA.-TOCOPHEROL ACETATE, DL- (UNII: WR1WPI7EW8)	
ACRYLATES/VINYL ISODECANOATE CROSSPOLYMER (10000 MPA.S NEUTRALIZED AT 0.5%) (UNII: 2N8MDB79NA)	

Packaging

#	Item Code	Package Description	Marketing Start Date	Marketing End Date
1	NDC:63148-522-10	59 mL in 1 BOTTLE, PLASTIC; Type 0: Not a Combination Product	11/02/2020	
2	NDC:63148-522-20	236 mL in 1 BOTTLE, PLASTIC; Type 0: Not a Combination Product	11/02/2020	
3	NDC:63148-522-30	443 mL in 1 BOTTLE, PLASTIC; Type 0: Not a Combination Product	11/02/2020	
4	NDC:63148-522-40	946 mL in 1 BOTTLE, PLASTIC; Type 0: Not a Combination Product	11/02/2020	
5	NDC:63148-522-50	1182 mL in 1 BOTTLE, PLASTIC; Type 0: Not a Combination Product	11/02/2020	
6	NDC:63148-522-60	1892 mL in 1 BOTTLE, PLASTIC; Type 0: Not a Combination Product	11/02/2020	
7	NDC:63148-522-70	3785 mL in 1 BOTTLE, PLASTIC; Type 0: Not a Combination Product	11/02/2020	

Marketing Information

Marketing Category	Application Number or Monograph Citation	Marketing Start Date	Marketing End Date
OTC Monograph Drug	505G(a)(3)	11/02/2020	

Labeler - Apollo Health and Beauty Care Inc (201901209)

Registrant - Apollo Health and Beauty Care Inc (201901209)

Establishment

Name	Address	ID/FEI	Business Operations
Apollo Health and Beauty Care Inc		201901209	manufacture(63148-522)

Revised: 1/2025

Apollo Health and Beauty Care Inc