

**LIDOCAINE 4% PAIN RELIEF GEL PATCH- lidocaine 4% pain relief gel patch patch**  
**ONE2ZEE LIMITED LIABILITY COMPANY**

-----  
**Lidocaine 4% Pain Relief Gel Patch**

**Active ingredient**

Lidocaine 4%

***Purpose***

Topical Anesthetic

*Use*

Temporarily relieves minor pain

*Warnings*

For external use only

***Do not use:***

- more than 1 patch on your body at a time
- on cut, irritated or swollen skin
- on puncture wounds
- for more than one week without consulting a doctor
- at the same time as other topical analgesics

***When using this product:***

- use only as directed.
- read and follow all directions and warnings on this label
- rare cases of serious burns have been reported with products of this type.
- do not apply to wounds or damaged, broken
- eyes and mucous membranes
- do not bandage tightly or apply local heat (such as
- the same time as other topical analgesics
- keeps product away from children and pets. used patches still contain the drug product that can produce serious adverse effects if a child or pet chews or ingests this patch.
- a transient burning sensation may occur upon application but generally disappears in several days
- if a severe burning sensation occurs, discontinue use immediately.
- discontinue use at least 1 hour before a bath or shower.
- do not use immediately after a bath or shower.

*Stop use and ask doctor if:*

- condition worsen
- redness is present
- irritation develops
- symptoms persist for more than 7 days or clear up and occur again within a few days
- you experience signs of skin injury, such as pain, swelling, or blistering where this product is applied

*if pregnant or breast feeding,*

ask a health professional before use.

*keep out of reach of children and pets*

If swallowed, get medical help or contact a Poison Control Center right away.

*Directions:*

**Adult and children over 12years:**

- Clean and dry affected area
- remove backing from patch by firmly grasping both ends and
- gently pulling until back separates in middle
- Carefully remove smaller portion of backing from the patch and apply exposed portion of
- patch to affected area
- use 1 patch for up to 12 hours

**children 12 years or younger: ask a doctor**

*Inactive ingredients:*

Alpha Tocopherol, Aluminum Sulphate, Borax, Carbomer, Colloidal Silicon Dioxide, DMDM Hydantoin, Glycerin, Kaolin, Polyacrylic Acid, Polyvinyl Alcohol, Polyvinylpyrrolidone , Propylene Glycol, Purified Water, Sodium Carboxymethyl Cellulose, Sodium Ethylenediaminetetraacetic Acid, Sodium Polyacrylate, Sorbitol, Sorbitol Monooleate , Tartaric Acid & Titanium Dioxide, Butylated Hydroxytoluene, Polysorbate

*Other Information:*

Store at room temperature 20-25°C (68-77°F)

Questions? call toll-free 1-844-912-4012

**Package Label Box**

Lidocaine 4% Carton



Carton of 15 individually packed pouches  
(to be packed without folding pouches)

- Applying your patch:
1. Gently remove smaller portion of backing from the middle of the patch.
  2. Apply exposed portion to affected area. Peel off the remaining backing layer and press the patch in place.

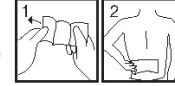

<b>Drug Facts</b>	
<b>Active ingredient</b> ..... <b>Purpose</b> Lidocaine 4%.....Topical anesthetic	with a few days ■ you experience signs of skin injury, such as pain, swelling, or blistering where the product was applied ■ if pregnant or breast feeding, ask a health professional before use.
<b>Use</b> temporarily relieves minor pain	■ <b>keep out of reach of children and pets.</b> If swallowed, get medical help or contact a Poison Control Center right away.
<b>Warnings:</b> For external use only	
<b>Do not use</b> ■ more than 1 patch on your body at a time ■ on cut, irritated or swollen skin ■ on puncture wounds ■ for more than one week without consulting a doctor ■ at the same time as other topical anesthetics	<b>Directions</b> <b>Adult and children over 12 years:</b> ■ Clean and dry affected area. ■ remove backing from patch by firmly grasping both ends and gently pulling until back separates in middle ■ Carefully remove smaller portion of backing from the patch and apply exposed portion of patch to affected area. ■ use 1 patch for up to 12 hours
<b>When using this product:</b> ■ use only as directed. ■ read and follow all directions and warnings on this label. ■ rare cases of serious burns have been reported with products of this type.	<b>Children 12 years or younger:</b> ask a doctor
■ do not apply to wounds or damaged, broken or irritated skin ■ do not allow contact with the eyes and mucous membranes ■ do not bandage tightly or apply local heat (such as heating pads) to the area of use ■ do not use at the same time as other topical anesthetics	<b>Other information:</b> Store in a clear, dry place. Protect from excessive moisture
■ dispose of used patch in manner that always keeps product away from children and pets. ■ used patches still contain the drug product that can produce serious adverse effects if a child or pet chews or ingests this patch.	<b>Inactive ingredients:</b> Aluminum Glycinate, Aluminum Hydroxide, Aluminum Borate, Carbomer, Sulfate, DMDM Hydantoin, Glycerine, Kadmim, Polyacrylic Acid, Polyvinyl Alcohol, Polyvinylpyrrolidone, Propylene Glycol, Purified Water, Sodium Carboxymethyl Cellulose, Sodium Ethylenediaminetetraacetate Acid, Sodium Polycrylate, Sorbitan Monoleate, Tartaric Acid, Titanium Dioxide, Tocopherol Acetate, Butylated Hydroxytoluene, Polysorbate.
■ a transient burning sensation may occur upon application but generally disappears in several days ■ if a severe burning sensation occurs, discontinue use immediately.	<b>Questions?</b> call toll-free 1-833-663-2933
<b>Stop use and ask a doctor if:</b> ■ condition worsens ■ redness is present ■ irritation develops ■ symptoms persist for more than 7 days or clear up and occur again	<small>Nettoal Code No. H9DmgzMM806248 *This product is not manufactured or distributed by Olanex, Inc., distributor of Aspercrem® Maximum Strength Lidocaine Patch.</small>

DISTRIBUTED BY: ONEZEE LLC  
EDISON, NJ 08837 MADE IN INDIA Child-Resistant Packaging

KEEP OUTER CARTON FOR COMPLETE WARNINGS AND PRODUCT INFORMATION.

MAXIMUM STRENGTH LIDOCAINE PAIN-RELIEF GEL PATCH

**LIDOCAINE 4% PAIN RELIEF GEL PATCH**

lidocaine 4% pain relief gel patch patch

**Product Information**

<b>Product Type</b>	HUMAN OTC DRUG	<b>Item Code (Source)</b>	NDC:55629-024
<b>Route of Administration</b>	TOPICAL		

**Active Ingredient/Active Moiety**

Ingredient Name	Basis of Strength	Strength
LIDOCAINE (UNII: 98PI200987) (LIDOCAINE - UNII:98PI200987)	LIDOCAINE	40 mg

**Inactive Ingredients**

Ingredient Name	Strength
ALUMINUM GLYCINATE (UNII: 1K713C615K)	
ALUMINUM HYDROXIDE (UNII: 5QB0T2IU0)	
ALUMINUM BORATE (UNII: 2C1HEM26VZ)	
CARBOMER (UNII: 0A5MM307FC)	
DMDM HYDANTOIN (UNII: BYR0546TOW)	
ALUMINUM SULFATE (UNII: 34S289N54E)	

<b>GLYCERIN</b> (UNII: PDC6A3C00X)
<b>KAOLIN</b> (UNII: 24H4NWX5CO)
<b>POLYACRYLIC ACID (250000 MW)</b> (UNII: 9G2MAD7J6W)
<b>POLYVINYL ALCOHOL (100000 MW)</b> (UNII: 949E52Z6MY)
<b>POVIDONE K27</b> (UNII: H7AGY1OJO8)
<b>PROPYLENE GLYCOL</b> (UNII: 6DC9Q167V3)
<b>WATER</b> (UNII: 059QF0KO0R)
<b>CARBOXYMETHYLCELLULOSE SODIUM</b> (UNII: K679OBS311)
<b>MAGNESIUM DISODIUM EDTA</b> (UNII: NDT563S5VZ)
<b>SODIUM POLYACRYLATE (2500000 MW)</b> (UNII: 05I15JN12J)
<b>SORBITOL</b> (UNII: 506T60A25R)
<b>SORBITOL MONOOLEATE</b> (UNII: 658271J00C)
<b>TARTARIC ACID</b> (UNII: W4888I119H)
<b>TITANIUM DIOXIDE</b> (UNII: 15FIX9V2JP)
<b>.ALPHA.-TOCOPHEROL ACETATE</b> (UNII: 9E8X80D2L0)
<b>BUTYLATED HYDROXYTOLUENE</b> (UNII: 1P9D0Z171K)
<b>POLYSORBATE 20</b> (UNII: 7T1F30V5YH)

### Product Characteristics

<b>Color</b>	white	<b>Score</b>	
<b>Shape</b>	RECTANGLE	<b>Size</b>	
<b>Flavor</b>		<b>Imprint Code</b>	
<b>Contains</b>			

### Packaging

#	Item Code	Package Description	Marketing Start Date	Marketing End Date
1	NDC:55629-024-15	15 in 1 BOX	03/03/2025	
1		1 in 1 POUCH; Type 0: Not a Combination Product		

### Marketing Information

Marketing Category	Application Number or Monograph Citation	Marketing Start Date	Marketing End Date
OTC Monograph Drug	M	03/03/2025	

**Labeler** - ONE2ZEE LIMITED LIABILITY COMPANY (078656111)

**Registrant** - ONE2ZEE LIMITED LIABILITY COMPANY (078656111)

### Establishment

Name	Address	ID/FEI	Business Operations
DR. SABHARWAL'S WOUND CARE		862184668	manufacture(55629-024)

