

**PLUM EMERGENCY EYEWASH/EYEWASH DUO/EYEWASH SHOWER ISS USA -
water liquid
Plum A/S**

Disclaimer: Most OTC drugs are not reviewed and approved by FDA, however they may be marketed if they comply with applicable regulations and policies. FDA has not evaluated whether this product complies.

Drug Facts

Active Ingredient

Purified water 99.1%

Purpose

Emergency eyewash

Uses

For rinsing the eyes and skin to reduce risk of severe injury caused by chemicals or particulate contamination.

Warnings

For external use only

Do not use

- for injection
- in intraocular surgery
- internally
- if solution changes color or becomes cloudy.

When using this product

- avoid contamination
- do not reuse. Once opened, discard.

Ask doctor if you have

- eye pain
- changes in vision
- redness or irritation of the eye after use
- an injury caused by an alkali

Keep out of reach of children

If swallowed, get medical help or contact a Poison Control Center right away.

Directions

- **do not dilute solution or reuse bottle**
- use only unopened bottle
- to open, twist cap in the direction of the arrow
- avoid contamination of the integrated eyecup
- place integrated eyecup over affected eye(s)
- tilt head backward
- open eyelid(s) wide
- control rate of flow by pressure on bottle
- thoroughly bathe eye(s) with solution
- allow solution to flow away from eye(s)
- rinse until the bottle is empty and continue rinsing with Plum Emergency Eyewash until you reach a doctor
- continue rinsing with water if necessary
- obtain medical treatment.

Other Information

- not for use as a contact lens solution
- do not use after bottle expiration
- store at room temperature, 5° to 35° C (41° to 95° F).

Inactive ingredients

sterile sodium chloride

Questions or Comments

Call toll-free number 1-844-405-7233

Imported and distributed by

Innovative Safety Supply Inc., 304 Edson St., Saskatoon, Saskatchewan S7J 0P9, Canada (CAN)

Principal Display Panel

NDC : 42659-011-20

Plum

Emergency Eyewash

Compliance: ANSI/ISEA Z358.1-2014

(As Personal Eyewash Only)

plum

Labeler: Plum A/S - Frederik plums Vej 2

DK - 5610 Assens - Denmark

Tel. +45 6471 2112

www.plum.eu

Sterile - 200 ml (6.8 fl oz)



Plum 

Emergency Eyewash
NDC 42659-011-20
Compliance: ANSI/ISEA Z358.1-2014
(As Personal Eyewash Only)

plum | Labeler:
Plum A/S - Frederik Plums Vej 2
DK-5610 Assens - Denmark
Tel. +45 6471 2112 - www.plum.eu

Sterile - 200 ml (6.8 fl oz)

Batch code:

LOT



Drug Facts	
Active ingredient Purified water 99.1%.....	Purpose Emergency eyewash
Uses For rinsing the eyes to reduce risk of severe injury caused by chemicals or particulate contamination.	
Warnings For external use only	
Do not use • for injection • for intraocular surgery • internally • if solution changes color or becomes cloudy.	
When using this product • avoid contamination • do not reuse. Once opened, discard.	
Ask doctor if you have • eye pain • changes in vision • redness or irritation of the eye after use • an injury caused by an alkali	
Keep out of reach of children • If swallowed, get medical help or contact a Poison Control Center right away	
Directions • do not dilute solution or reuse bottle	
<ul style="list-style-type: none"> • use only unopened bottle • to open, twist cap in the direction of the arrow • avoid contamination of integrated eyecup • place integrated eyecup over affected eye(s) • tilt head backward • open eyelid(s) wide • control rate of flow by pressure on bottle 	<ul style="list-style-type: none"> • thoroughly bathe eye(s) with solution • allow solution to flow away from eye(s) • rinse until the discomfort disappears and continue rinsing with Plum Emergency Eyewash until you reach a doctor • continue rinsing with water if necessary • obtain medical treatment
Other Information • not for use as a contact lens solution • do not use after bottle expiration • store at room temperature, 5° to 35° C (41° to 95° F).	
Inactive Ingredients sterile sodium chloride	
Questions or Comments? Call toll-free number 1-844-405-7233	

Imported and distributed by: Innovative Safety Supply Inc, 304 Edson St., Saskatoon, Saskatchewan S7J 0P9, Canada (CAN)

953533

NDC : 42659-011-23

Plum DUO

Emergency Eyewash

Compliance: ANSI/ISEA Z358.1-2014

(As Personal Eyewash Only)

plum

Labeler: Plum A/S - Frederik plums Vej 2

DK - 5610 Assens - Denmark

Tel. +45 6471 2112

www.plum.eu

Sterile - 500 ml (16.9 fl oz)



Plum 

Emergency Eyewash
NDC 42659-011-23
Compliance: ANSI/ISEA Z358.1-2014
(As Personal Eyewash Only)

plum | Labeler:
Plum A/S - Frederik Plums Vej 2
DK-5610 Assens - Denmark
Tel. +45 6471 2112 - www.plum.eu

Sterile - 500 ml (16.9 fl oz)

Batch code:

LOT

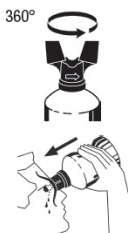

Drug Facts	
Active ingredient Purified water 99.1%.....	Purpose Emergency eyewash
Uses For rinsing the eyes to reduce risk of severe injury caused by chemicals or particulate contamination.	
Warnings For external use only	
Do not use • for injection • for intraocular surgery • internally • if solution changes color or becomes cloudy.	
When using this product • avoid contamination • do not reuse. Once opened, discard.	
Ask doctor if you have • eye pain • changes in vision • redness or irritation of the eye after use • an injury caused by an alkali	
Keep out of reach of children • If swallowed, get medical help or contact a Poison Control Center right away	
Directions • do not dilute solution or reuse bottle	
<ul style="list-style-type: none"> • use only unopened bottle • to open, twist cap in the direction of the arrow • avoid contamination of integrated eyecup • place integrated eyecup over affected eye(s) • tilt head backward • open eyelid(s) wide • control rate of flow by pressure on bottle 	<ul style="list-style-type: none"> • thoroughly bathe eye(s) with solution • allow solution to flow away from eye(s) • rinse until the discomfort disappears and continue rinsing with Plum Emergency Eyewash until you reach a doctor • continue rinsing with water if necessary • obtain medical treatment
Other Information not for use as a contact lens solution • do not use after bottle expiration • store at room temperature, 5° to 35° C (41° to 95° F).	
Inactive Ingredients sterile sodium chloride	
Questions or Comments? Call toll-free number 1-844-405-7233	

Imported and distributed by: Innovative Safety Supply Inc, 304 Edson St., Saskatoon, Saskatchewan S7J 0P9, Canada (CAN)

953530

NDC : 42659-011-26

Plum

Emergency Eyewash Shower

Compliance: ANSI/ISEA Z358.1-2014

(As Personal Eyewash Only)

plum

Labeler: Plum A/S - Frederik plums Vej 2

DK - 5610 Assens - Denmark

Tel. +45 6471 2112

www.plum.eu

Sterile - 500 ml (16.9 fl oz)

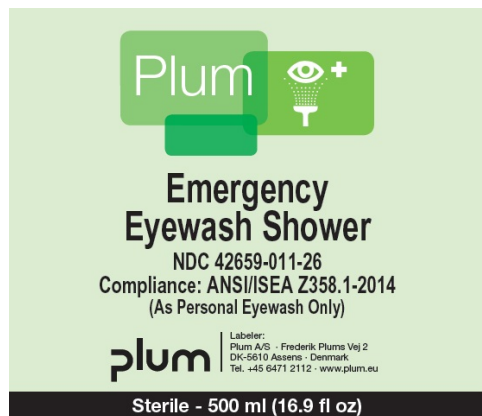

Drug Facts	
Active ingredient Purified water 99.1%	Purpose Emergency eyewash
Uses For rinsing the eyes to reduce risk of severe injury caused by chemicals or particulate contamination.	
Warnings For external use only	
Do not use • for injection • for intraocular surgery • internally • if solution changes color or becomes cloudy.	
When using this product • avoid contamination • do not reuse. Once opened, discard.	
Ask doctor if you have • eye pain • changes in vision • redness or irritation of the eye after use • an injury caused by an alkali	
Keep out of reach of children • If swallowed, get medical help or contact a Poison Control Center right away	
Directions • do not dilute solution or reuse bottle	
<ul style="list-style-type: none"> • use only unopened bottle • to open, twist cap in the direction of the arrow • avoid contamination of integrated eyecup • place integrated eyecup over affected eye(s) • tilt head backward • open eyelid(s) wide • control rate of flow by pressure on bottle 	<ul style="list-style-type: none"> • thoroughly bathe eye(s) with solution • allow solution to flow away from eye(s) • rinse until the discomfort disappears and continue rinsing with Plum Emergency Eyewash until you reach a doctor • continue rinsing with water if necessary • obtain medical treatment
Other Information not for use as a contact lens solution • do not use after bottle expiration • store at room temperature, 5° to 35° C (41° to 95° F).	
Inactive Ingredients sterile sodium chloride	
Questions or Comments? Call toll-free number 1-844-405-7233	

Imported and distributed by: Innovative Safety Supply Inc, 304 Edson St., Saskatoon, Saskatchewan S7J 0P9, Canada (CAN)

Batch code:

LOT



953628

PLUM EMERGENCY EYEWASH/EYEWASH DUO/EYEWASH SHOWER ISS USA

water liquid

Product Information

Product Type	HUMAN OTC DRUG	Item Code (Source)	NDC:42659-011
Route of Administration	OPHTHALMIC		

Active Ingredient/Active Moiety

Ingredient Name	Basis of Strength	Strength
Water (UNII: 059QF0KO0R) (Water - UNII:059QF0KO0R)	Water	99.1 mL in 100 mL

Inactive Ingredients

Ingredient Name	Strength
Sodium Chloride (UNII: 451W47IQ8X)	

Packaging

#	Item Code	Package Description	Marketing Start Date	Marketing End Date
1	NDC:42659-011-20	200 mL in 1 BOTTLE; Type 0: Not a Combination Product	06/17/2016	

2	NDC:42659-011-21	500 mL in 1 BOTTLE; Type 0: Not a Combination Product	06/17/2016	
3	NDC:42659-011-22	1000 mL in 1 BOTTLE; Type 0: Not a Combination Product	06/17/2016	
4	NDC:42659-011-23	500 mL in 1 BOTTLE; Type 0: Not a Combination Product	06/17/2016	
5	NDC:42659-011-24	1000 mL in 1 BOTTLE; Type 0: Not a Combination Product	06/17/2016	
6	NDC:42659-011-26	500 mL in 1 BOTTLE; Type 0: Not a Combination Product	06/17/2016	
7	NDC:42659-011-27	1000 mL in 1 BOTTLE; Type 0: Not a Combination Product	06/17/2016	

Marketing Information

Marketing Category	Application Number or Monograph Citation	Marketing Start Date	Marketing End Date
OTC monograph final	part349	06/17/2016	

Labeler - Plum A/S (305299489)

Establishment

Name	Address	ID/FEI	Business Operations
Plum A/S		305299489	label(42659-011)

Establishment

Name	Address	ID/FEI	Business Operations
Holopack Verpackungstechnik GmbH		343390324	manufacture(42659-011)

Revised: 6/2016

Plum A/S