



DOSAGE AND USE: See accompanying prescribing information.

Store at room temperature, 20°C to 25°C (68°F to 77°F). (See USP Controlled Room Temperature.) Dispense in tight (USP), light-resistant (USP), and child-resistant containers.

Distributed by
Wyeth Pharmaceuticals Inc
A subsidiary of Pfizer Inc
Philadelphia, PA 19101
MADE IN SWITZERLAND

ALWAYS DISPENSE WITH MEDICATION GUIDE
Pfizer NDC 0008-1040-05

Rapamune®
(sirolimus) Tablets

0.5 mg

For oral use only.

100 Tablets **Rx only**

12112101

FP0128 (60% x 5.5mm)
N3 0008-1040-05 7



DOSAGE AND USE: See accompanying prescribing information.

Store at room temperature, 20°C to 25°C (68°F to 77°F). [See USP Controlled Room Temperature.] Dispense in tight (USP), light-resistant (USP), and child-resistant containers.

Distributed by
Wyeth Pharmaceuticals Inc
A subsidiary of Pfizer Inc
Philadelphia, PA 19101
MADE IN SWITZERLAND

ALWAYS DISPENSE WITH MEDICATION GUIDE
Pfizer NDC 0008-1041-05

Rapamune®
(sirolimus) Tablets

1 mg

For oral use only.

100 Tablets **Rx only**

12112401

FP0128 (60% x 5.5mm)
N3 0008-1041-05

DOSAGE AND USE: See accompanying prescribing information.

Store at room temperature, 20°C to 25°C (68°F to 77°F). [See USP Controlled Room Temperature.] Dispense in tight (USP), light-resistant (USP), and child-resistant containers.

Distributed by
Wyeth Pharmaceuticals Inc
A subsidiary of Pfizer Inc
Philadelphia, PA 19101
MADE IN SWITZERLAND

ALWAYS DISPENSE WITH MEDICATION GUIDE
Pfizer NDC 0008-1042-05

Rapamune®
(sirolimus) Tablets

2 mg

For oral use only.

100 Tablets **Rx only**

FP0128 (60% x 5.5mm)
N3 0008-1042-05 1
12112601





ALWAYS DISPENSE WITH MEDICATION GUIDE
Pfizer NDC 0008-1030-04

Rapamune®
(sirolimus)
Oral Solution

1 mg/mL

For oral use only.
Each mL of RAPAMUNE contains 1 mg sirolimus,
1.5%-2.5% ethanol
Also contains a mixture of propylene glycol and
phosphatidylcholine derived from soy lecithin
(and other components) and polysorbate 80.

60 mL _____ Rx only

Store refrigerated at 2° to 8°C (36° to 46°F). Protect from light.
Use contents within 1 month after opening.

XXXXXXXXXX
LOT
EXP: ZZ

XXXXXXXXXX

MADE IN JAPAN

FPO
LOT 00300081030041

DOSAGE AND USE: See accompanying prescribing information.
Keep out of reach of children.
Distributed by
Wyeth Pharmaceuticals Inc
A subsidiary of Pfizer Inc
Philadelphia, PA 19101



Rapamune®
(sirolimus)
Oral Solution
1 mg/mL

12965902

Instructions for Use for RAPAMUNE® (sirolimus) Oral Solution



1 Open the solution bottle. Remove the safety cap by squeezing the tabs on the cap and twisting counterclockwise.



2 The first time you use a bottle of Rapamune Oral Solution, insert the oral syringe adapter (plastic tube with stopper) tightly into the bottle until it is even with the top of the bottle. Do not remove the oral syringe adapter from the bottle once inserted.



3 Use a new disposable amber oral syringe for each dose of Rapamune Oral Solution. Fully push down (depress) on the plunger of the disposable amber oral syringe. Then, tightly insert the oral syringe into the opening in the adapter.

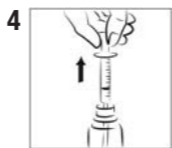

4 Withdraw the prescribed amount of Rapamune Oral Solution. Gently pull back the plunger of the syringe until the bottom of the black line of the plunger is even with the appropriate mark on the syringe. Always keep the bottle in an upright position. If bubbles form in the syringe, empty the syringe into the bottle and repeat steps 3 and 4.

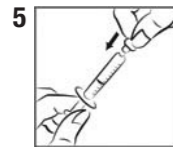

5 If your doctor tells you to carry your medicine with you: If you need to carry your Rapamune Oral Solution in a filled syringe, place a cap securely on the syringe. The cap should snap into place.

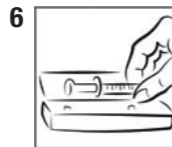

6 Place the capped syringe in the enclosed carrying case.



7 Taking a dose of Rapamune Oral Solution: Empty the syringe into a glass or plastic cup containing at least 2 ounces (1/4 cup; 60 mL) of water or orange juice, stir vigorously for 1 minute and drink right away. Refill the container with at least 4 ounces (1/2 cup; 120 mL) of water or orange juice, stir vigorously again and drink the rinse solution. Do not mix Rapamune Oral Solution with apple juice, grapefruit juice, or other liquids. Only glass or plastic cups should be used to mix Rapamune Oral Solution. The syringe and cap should be used only one time and then thrown away.

8 Always store the bottles of medication in the refrigerator. You may store RAPAMUNE Oral Solution that is in a syringe at room temperature up to 77°F (25°C) or in the refrigerator at 36°F to 46°F (2°C to 8°C) for up to 24 hours. See "How should I store RAPAMUNE?" at the end of Instructions for Use provided in the package insert.

LOT
EXP.

Distributed by
Wyeth Pharmaceuticals Inc
A subsidiary of Pfizer Inc
Philadelphia, PA 19101

60 mL Patient Kit

Rapamune®
(sirolimus)
Oral Solution

1 mg/mL

DOSAGE AND USE:
See accompanying prescribing information.
Refer to back of box for Instructions for Use for RAPAMUNE (sirolimus) Oral Solution
Keep out of reach of children.

ALWAYS DISPENSE WITH MEDICATION GUIDE



NDC 0008-1030-06

Rapamune®
(sirolimus)
Oral Solution

1 mg/mL

For oral use only.
Each mL of RAPAMUNE contains 1 mg sirolimus.
1.5%-2.5% ethanol
Also contains a mixture of propylene glycol and phosphatidylcholine derived from soy lecithin (and other components) and polysorbate 80.

60 mL Patient Kit

Rx only

Each Rapamune Oral Solution carton contains:

- a) A 2 oz. (60 mL fill) amber glass bottle of sirolimus (concentration of 1 mg/mL)
- b) 1 oral syringe adapter for fitting into the neck of the bottle
- c) 30 amber oral syringes and 30 caps for daily dosing
- d) 1 carrying case

Also contains: Package Insert and Medication Guide

You will also need:

- glass or plastic cup
- 6 oz. of water or orange juice only

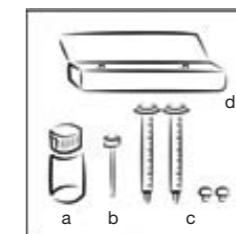

60 mL Patient Kit

Rapamune®
(sirolimus)
Oral Solution

1 mg/mL

Store refrigerated at
2° to 8°C (36° to 46°F).

PROTECT FROM LIGHT
Use contents of bottle
within 1 month after
opening.

MADE IN JAPAN



This label may not be the latest approved by FDA.
For current labeling information, please visit <https://www.fda.gov/drugsatfda>

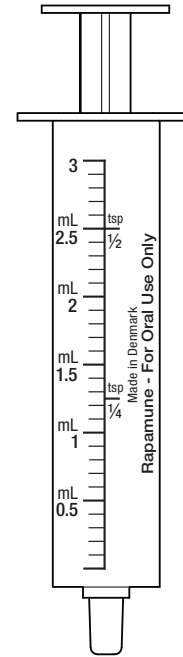

Reference ID: 3316582