

## HIGHLIGHTS OF PRESCRIBING INFORMATION

These highlights do not include all the information needed to use OMVOH safely and effectively. See full prescribing information for OMVOH.

**OMVOH (mirikizumab-mrkz) injection, for intravenous or subcutaneous use**  
Initial U.S. Approval: 2023

### RECENT MAJOR CHANGES

|   |         |
|---|---------|
| Indications and Usage (1)   | 1/2025  |
| Dosage and Administration   |         |
| Recommended Dosage for Ulcerative Colitis (2.2)                             | 10/2025 |
| Recommended Dosage for Crohn's Disease (2.3)                                | 1/2025  |
| Preparation and Administration Instructions for Intravenous Infusion (2.4)  | 1/2025  |
| Preparation and Administration Instructions for Subcutaneous Injection(2.5) | 10/2025 |

### INDICATIONS AND USAGE

OMVOH™ is an interleukin-23 antagonist indicated for the treatment of:

- moderately to severely active ulcerative colitis in adults (1)
- moderately to severely active Crohn's disease in adults (1)

### DOSAGE AND ADMINISTRATION

#### Prior to Treatment Initiation

- Evaluate patients for tuberculosis (TB) infection. (2.1, 5.3)
- Obtain liver enzymes and bilirubin levels. (2.1, 5.4)
- Complete all age-appropriate vaccinations according to current immunization guidelines. (2.1, 5.5)

#### Recommended Dosage for Ulcerative Colitis

- **Induction Dosage:** Week 0, Week 4, and Week 8: Infuse 300 mg intravenously over at least 30 minutes. (2.2)
- **Maintenance Dosage:** Week 12 and every 4 weeks thereafter: Inject 200 mg subcutaneously (given as either one injection of 200 mg or as two consecutive injections of 100 mg each). (2.2)

#### Recommended Dosage for Crohn's Disease

- **Induction Dosage:** Week 0, Week 4, and Week 8: Infuse 900 mg intravenously over at least 90 minutes. (2.3)
- **Maintenance Dosage:** Week 12 and every 4 weeks thereafter: Inject 300 mg subcutaneously (given as two consecutive injections of 100 mg and 200 mg in any order). (2.3)

#### Preparation and Administration Instructions

- See the full prescribing information for preparation, administration and storage information for intravenous infusion and subcutaneous injection. (2.2, 2.3, 2.4, 2.5, 2.6)

### DOSAGE FORMS AND STRENGTHS

#### Intravenous Infusion (3)

- Injection: 300 mg/15 mL (20 mg/mL) solution in a single-dose vial

#### Subcutaneous Injection (3):

- Injection: 100 mg/mL solution in a single-dose prefilled pen
- Injection: 100 mg/mL solution in a single-dose prefilled syringe
- Injection: 200 mg/2 mL solution in a single-dose prefilled pen
- Injection: 200 mg/2 mL (100 mg/mL) solution in a single-dose prefilled syringe

### CONTRAINDICATIONS

History of serious hypersensitivity reaction to mirikizumab-mrkz or any of the excipients. (4, 5.1).

### WARNINGS AND PRECAUTIONS

- **Hypersensitivity Reactions:** Serious hypersensitivity reactions, including anaphylaxis and infusion-related reactions, have been reported. If a severe hypersensitivity reaction occurs, discontinue and initiate appropriate treatment. (5.1)
- **Infections:** OMVOH may increase the risk of infection. Do not initiate treatment with OMVOH in patients with a clinically important active infection until the infection resolves or is adequately treated. If a serious infection develops, do not administer OMVOH until the infection resolves. (5.2)
- **Tuberculosis:** Do not administer OMVOH to patients with active TB infection. Monitor patients receiving OMVOH for signs and symptoms of active TB during and after treatment. (5.3)
- **Hepatotoxicity:** Drug-induced liver injury has been reported. Monitor liver enzymes and bilirubin levels at baseline and for at least 24 weeks of treatment and thereafter according to routine patient management. Interrupt treatment if drug-induced liver injury is suspected, until this diagnosis is excluded. (5.4)
- **Immunizations:** Avoid use of live vaccines. (5.5)

### ADVERSE REACTIONS

Most common adverse reactions are:

- **Ulcerative colitis (≥2%):**
  - **Induction:** upper respiratory tract infections and arthralgia. (6.1)
  - **Maintenance:** upper respiratory tract infections, injection site reactions, arthralgia, rash, headache, and herpes viral infection. (6.1)
- **Crohn's disease (≥5%):** upper respiratory tract infections, injection site reactions, headache, arthralgia, and elevated liver tests (6.1)

To report SUSPECTED ADVERSE REACTIONS, contact Eli Lilly and Company at 1-800-LillyRx (1-800-545-5979) or FDA at 1-800-FDA-1088 or [www.fda.gov/medwatch](http://www.fda.gov/medwatch).

See 17 for PATIENT COUNSELING INFORMATION and FDA-approved Medication Guide.

Revised: 10/2025

## FULL PRESCRIBING INFORMATION: CONTENTS\*

### 1 INDICATIONS AND USAGE

### 2 DOSAGE AND ADMINISTRATION

- 2.1 Recommended Evaluations and Immunizations Prior to Treatment Initiation
- 2.2 Recommended Dosage for Ulcerative Colitis
- 2.3 Recommended Dosage for Crohn's Disease
- 2.4 Preparation and Administration Instructions for Intravenous Infusion
- 2.5 Preparation and Administration Instructions for Subcutaneous Injection

### 3 DOSAGE FORMS AND STRENGTHS

### 4 CONTRAINDICATIONS

### 5 WARNINGS AND PRECAUTIONS

- 5.1 Hypersensitivity Reactions
- 5.2 Infections
- 5.3 Tuberculosis
- 5.4 Hepatotoxicity
- 5.5 Immunizations

### 6 ADVERSE REACTIONS

- 6.1 Clinical Trials Experience

### 7 DRUG INTERACTIONS

- 7.1 CYP450 Substrates

### 8 USE IN SPECIFIC POPULATIONS

- 8.1 Pregnancy
- 8.2 Lactation
- 8.4 Pediatric Use
- 8.5 Geriatric Use

### 11 DESCRIPTION

### 12 CLINICAL PHARMACOLOGY

- 12.1 Mechanism of Action
- 12.2 Pharmacodynamics
- 12.3 Pharmacokinetics
- 12.6 Immunogenicity

### 13 NONCLINICAL TOXICOLOGY

- 13.1 Carcinogenesis, Mutagenesis, Impairment of Fertility

### 14 CLINICAL STUDIES

- 14.1 Ulcerative Colitis
- 14.2 Crohn's Disease

### 16 HOW SUPPLIED/STORAGE AND HANDLING

### 17 PATIENT COUNSELING INFORMATION

\* Sections or subsections omitted from the full prescribing information are not listed.

## FULL PRESCRIBING INFORMATION

### 1 INDICATIONS AND USAGE

OMVOH is indicated for the treatment of:

- moderately to severely active ulcerative colitis in adults.
- moderately to severely active Crohn's disease in adults.

### 2 DOSAGE AND ADMINISTRATION

#### 2.1 Recommended Evaluations and Immunizations Prior to Treatment Initiation

- Evaluate patients for tuberculosis (TB) infection prior to initiating treatment with OMVOH [see *Warnings and Precautions* (5.3)].
- Obtain liver enzymes and bilirubin levels prior to initiating treatment with OMVOH [see *Warnings and Precautions* (5.4)].
- Complete all age-appropriate vaccinations according to current immunization guidelines [see *Warnings and Precautions* (5.5)].

#### 2.2 Recommended Dosage for Ulcerative Colitis

##### Induction Dosage

Week 0, Week 4, and Week 8: Infuse 300 mg intravenously over at least 30 minutes [see *Dosage and Administration* (2.4)].

##### Maintenance Dosage

Week 12 and every 4 weeks thereafter: Inject 200 mg subcutaneously (given as one injection of 200 mg or as two consecutive injections of 100 mg each) [see *Dosage and Administration* (2.5) and *How Supplied/Storage and Handling* (16)].

#### 2.3 Recommended Dosage for Crohn's Disease

##### Induction Dosage

Week 0, Week 4, and Week 8: Infuse 900 mg intravenously over at least 90 minutes [see *Dosage and Administration* (2.4)].

##### Maintenance Dosage

Week 12 and every 4 weeks thereafter: Inject 300 mg subcutaneously (given as two consecutive injections of 100 mg and 200 mg in any order) [see *Dosage and Administration* (2.6) and *How Supplied/Storage and Handling* (16)].

#### 2.4 Preparation and Administration Instructions for Intravenous Infusion

1. OMVOH for intravenous use is intended for administration by a healthcare provider using aseptic technique.
2. Parenteral drug products should be inspected visually for particulate matter and discoloration prior to administration, whenever solution and container permit. The solution should be a clear to opalescent, colorless to slightly yellow to slightly brown solution, and free of visible particles. Do not use OMVOH if it is cloudy or there are visible particles.
3. Prior to intravenous administration, determine the dose needed based on the patient's indication (see Table 1 below). For Crohn's disease, discard 45 mL of the infusion bag prior to adding vial contents. Withdraw the required amount of solution from the vial(s) using a 18 gauge to 21 gauge needle and transfer to an infusion bag containing 0.9% Sodium Chloride Injection or 5% Dextrose Injection (see Table 1 below). Do not mix with other drugs. Do not dilute or infuse through the same intravenous line with other solutions.

**Table 1: Intravenous Induction Dose and Volume of Diluent Required**

| Indication         | Intravenous Induction Dose | Number of OMVOH 300mg/15mL vials needed | Volume of 0.9% Sodium Chloride or 5% Dextrose Injection |
|--------------------|----------------------------|---|---|
| Ulcerative colitis | 300 mg                     | 1                                       | 50 mL, 100 mL, or 250 mL                                |
| Crohn's disease    | 900 mg                     | 3                                       | 100 mL or 250 mL  |

4. Gently invert the infusion bag to mix the contents. Do not shake the prepared infusion bag.
5. Connect the intravenous administration set (infusion line) to the prepared infusion bag and prime the line.
6. Infuse the diluted solution intravenously over a period of at least 30 minutes for the 300 mg dose; at least 90 minutes for the 900 mg dose. If stored refrigerated, allow the diluted solution in the infusion bag to warm to room temperature prior to the start of the intravenous infusion.
7. At the end of the infusion, flush the line with 0.9% Sodium Chloride Injection or 5% Dextrose Injection.
  - Administer the flush at the same infusion rate as used for OMVOH administration.
  - The time required to flush OMVOH solution from the infusion line is in addition to the minimum 30-minute infusion time.

#### Storage of Diluted Solution

- Start the infusion immediately after preparation. If not used immediately, store the diluted infusion solution in the refrigerator at 2°C to 8°C (36°F to 46°F). Use the diluted infusion solution within 48 total hours, of which not more than 5 hours are permitted at non-refrigerated temperatures not to exceed 25°C (77°F), starting from the time of vial puncture.
- Keep drug product away from direct heat or light. Do not freeze the diluted solution in the prepared infusion bag.

## 2.5 Preparation and Administration Instructions for Subcutaneous Injection

- OMVOH is intended for use under the guidance and supervision of a healthcare professional. Patients may self-inject OMVOH after training in subcutaneous injection technique. Provide proper training to patients and/or caregivers on the subcutaneous injection technique of OMVOH according to the "Instructions for Use", included with the packaged product.
- Before injection, remove OMVOH prefilled pens or OMVOH prefilled syringes from the refrigerator, and leave at room temperature for 45 minutes.
- Do not shake the prefilled pens or prefilled syringes.
- Parenteral drug products should be inspected visually for particulate matter and discoloration prior to administration, whenever solution and container permit. The solution should be a clear to opalescent, colorless to slightly yellow to slightly brown solution, and free of visible particles. Do not use OMVOH if it is cloudy, discolored, or there are visible particles.
- Sites for injection include the abdomen, thigh, and back of the upper arm. Instruct patients to inject in a different location (such as upper arms, thighs or any quadrant of abdomen) than the previous injection. Administration of OMVOH in the back of upper arm may only be performed by another person.
- Do not inject into areas where the skin is tender, bruised, erythematous, or indurated.
- OMVOH does not contain preservatives; therefore, discard any unused product. Do not reuse.
- If a dose is missed, administer the dose as soon as possible. Thereafter, resume dosing every 4 weeks.

## 3 DOSAGE FORMS AND STRENGTHS

OMVOH is a clear to opalescent, colorless to slightly yellow to slightly brown solution available as:

- Intravenous Infusion:  
Injection: 300 mg/15 mL (20 mg/mL) solution in a single-dose vial
- Subcutaneous Use:  
Injection: 100 mg/mL solution in a single-dose prefilled pen  
Injection: 100 mg/mL solution in a single-dose prefilled syringe  
Injection: 200 mg/2 mL solution in a single-dose prefilled pen

Injection: 200 mg/2 mL (100 mg/mL) solution in a single-dose prefilled syringe

## 4 CONTRAINDICATIONS

OMVOH is contraindicated in patients with a history of serious hypersensitivity reaction to mirikizumab-mrkz or any of the excipients [see *Warnings and Precautions* (5.1)].

## 5 WARNINGS AND PRECAUTIONS

### 5.1 Hypersensitivity Reactions

Serious hypersensitivity reactions, including anaphylaxis during intravenous infusion, have been reported with OMVOH administration. Infusion-related hypersensitivity reactions, including mucocutaneous erythema and pruritus, were reported during induction [see *Adverse Reactions* (6.1)]. If a severe hypersensitivity reaction occurs, discontinue OMVOH immediately and initiate appropriate treatment.

### 5.2 Infections

OMVOH may increase the risk of infection [see *Adverse Reactions* (6.1)].

Do not initiate treatment with OMVOH in patients with a clinically important active infection until the infection resolves or is adequately treated.

In patients with a chronic infection or a history of recurrent infection, consider the risks and benefits prior to prescribing OMVOH. Instruct patients to seek medical advice if signs or symptoms of clinically important acute or chronic infection occur. If a serious infection develops or an infection is not responding to standard therapy, monitor the patient closely and do not administer OMVOH until the infection resolves.

### 5.3 Tuberculosis

Evaluate patients for tuberculosis (TB) infection prior to initiating treatment with OMVOH.

Do not administer OMVOH to patients with active TB infection. Initiate treatment of latent TB prior to administering OMVOH. Consider anti-TB therapy prior to initiation of OMVOH in patients with a past history of latent or active TB in whom an adequate course of treatment cannot be confirmed. Monitor patients for signs and symptoms of active TB during and after OMVOH treatment.

In clinical trials, subjects were excluded if they had evidence of active TB, a past history of active TB, or were diagnosed with latent TB at screening.

### 5.4 Hepatotoxicity

A case of drug-induced liver injury (alanine aminotransferase [ALT] 18x the upper limit of normal (ULN), aspartate aminotransferase [AST] 10x ULN, and total bilirubin 2.4x ULN) in conjunction with pruritus was reported in a clinical trial subject following a longer than recommended induction regimen. OMVOH was discontinued. Liver test abnormalities eventually returned to baseline.

Evaluate liver enzymes and bilirubin at baseline and for at least 24 weeks of treatment. Monitor thereafter according to routine patient management.

Consider other treatment options in patients with evidence of liver cirrhosis. Prompt investigation of the cause of liver enzyme elevation is recommended to identify potential cases of drug-induced liver injury. Interrupt treatment if drug-induced liver injury is suspected, until this diagnosis is excluded. Instruct patients to seek immediate medical attention if they experience symptoms suggestive of hepatic dysfunction.

### 5.5 Immunizations

Avoid use of live vaccines in patients treated with OMVOH. Medications that interact with the immune system may increase the risk of infection following administration of live vaccines. Prior to initiating therapy with OMVOH, complete all age-appropriate vaccinations according to current immunization guidelines. No data are available on the response to live or non-live vaccines in patients treated with OMVOH.

## 6 ADVERSE REACTIONS

The following topics are also discussed in detail in the Warnings and Precautions section:

- Hypersensitivity Reactions [see *Warnings and Precautions (5.1)*]
- Infections [see *Warnings and Precautions (5.2)*]
- Tuberculosis [see *Warnings and Precautions (5.3)*]
- Hepatotoxicity [see *Warnings and Precautions (5.4)*]

### 6.1 Clinical Trials Experience

Because clinical trials are conducted under widely varying conditions, adverse reaction rates observed in the clinical trials of a drug cannot be directly compared to rates in the clinical trials of another drug and may not reflect the rates observed in practice.

#### Ulcerative Colitis

OMVOH was studied up to 12 weeks in subjects with moderately to severely active ulcerative colitis in a randomized, double-blind, placebo-controlled induction study (UC-1). In subjects who responded to induction therapy in UC-1, long term safety up to 52 weeks was evaluated in a randomized, double-blind, placebo-controlled maintenance study (UC-2) and a long-term extension study [see *Clinical Studies (14.1)*].

In the induction study (UC-1), 1279 subjects were enrolled of whom 958 received OMVOH 300 mg administered as an intravenous infusion at Weeks 0, 4, and 8. In the maintenance study (UC-2), 581 subjects were enrolled of whom 389 received OMVOH 200 mg administered as a subcutaneous injection every 4 weeks.

Table 2 summarizes the adverse reactions reported in at least 2% of subjects and at a higher frequency than placebo during UC-1.

**Table 2: Adverse Reactions<sup>a</sup> in Subjects with Ulcerative Colitis through Week 12 in a Placebo-Controlled Induction Study (UC-1)**

| Adverse Reactions                               | OMVOH<br>300 mg Intravenous Infusion <sup>b</sup><br>N=958<br>n (%) | Placebo<br>N=321<br>n (%) |
|---|---|---------------------------|
| Upper respiratory tract infections <sup>c</sup> | 72 (8%)   | 20 (6%)                   |
| Arthralgia                                      | 20 (2%)   | 4 (1%)                    |

<sup>a</sup> Reported in at least 2% of subjects and at a higher frequency than placebo.

<sup>b</sup> OMVOH 300 mg as an intravenous infusion at Weeks 0, 4, and 8.

<sup>c</sup> Upper respiratory tract infections includes related terms (e.g., COVID-19, nasopharyngitis, pharyngitis, rhinitis, sinusitis, and upper respiratory tract infection).

In the induction study (UC-1), infusion-related hypersensitivity reactions were reported by 4 (0.4%) subjects treated with OMVOH and 1 (0.3%) subject treated with placebo.

Table 3 summarizes the adverse reactions reported in at least 2% of subjects and at a higher frequency than placebo during the 40-week controlled period of UC-2.

**Table 3: Adverse Reactions<sup>a</sup> in Subjects with Ulcerative Colitis through Week 40 In a Placebo-Controlled Maintenance Study (UC-2)**

| Adverse Reactions                               | OMVOH<br>200 mg Subcutaneous Injection <sup>b</sup><br>N=389<br>n (%) | Placebo<br>N=192<br>n (%) |
|---|---|---------------------------|
| Upper respiratory tract infections <sup>c</sup> | 53 (14%)  | 23 (12%)                  |
| Injection site reactions <sup>d</sup>           | 34 (9%)   | 8 (4%)                    |

|                                     |         |        |
|-------------------------------------|---------|--------|
| Arthralgia                          | 26 (7%) | 8 (4%) |
| Rash <sup>e</sup>                   | 16 (4%) | 2 (1%) |
| Headache                            | 16 (4%) | 2 (1%) |
| Herpes viral infection <sup>f</sup> | 9 (2%)  | 1 (1%) |

<sup>a</sup> Reported in at least 2% of subjects and at a higher frequency than placebo

<sup>b</sup> OMVOH 200 mg as a subcutaneous injection at Week 12 and every 4 weeks thereafter for up to an additional 40 weeks.

<sup>c</sup> Upper respiratory tract infections includes related terms (e.g., COVID-19, nasopharyngitis, pharyngitis, rhinitis, sinusitis, and upper respiratory tract infection).

<sup>d</sup> Injection site reactions includes related terms (e.g., erythema, hypersensitivity, pain, reaction, and urticaria at the injection site).

<sup>e</sup> Rash is composed of several similar terms.

<sup>f</sup> Herpes viral infection includes related terms (e.g., herpes zoster, herpes simplex, and oral herpes).

### Infections

In UC-1 through Week 12, infections were reported by 145 (15%) subjects treated with OMVOH 300 mg and 45 (14%) subjects treated with placebo. Serious infections were reported by less than 1% in both groups. Serious infections in the OMVOH group included intestinal sepsis, listeria sepsis, and pneumonia.

In the maintenance study (UC-2) through Week 40 (a total of 52 weeks of treatment), infections were reported by 93 (24%) subjects treated with OMVOH 200 mg and 44 (23%) subjects treated with placebo. A case of COVID-19 pneumonia was reported as a serious infection in the OMVOH group.

### Hepatic Enzyme Elevations

In UC-1 through Week 12, alanine aminotransferase (ALT)  $\geq 5X$  ULN was reported by 1 (0.1%) subject treated with OMVOH 300 mg and 1 (0.3%) subject treated with placebo. Aspartate aminotransferase (AST)  $\geq 5X$  ULN was reported by 2 (0.2%) subjects treated with OMVOH 300 mg and no subject treated with placebo. These elevations have been noted with and without concomitant elevations in total bilirubin.

In UC-2 through Week 40 (a total of 52 weeks of treatment), 3 (0.8%) subjects treated with OMVOH 200 mg reported ALT  $\geq 5X$  ULN and 3 (0.8%) subjects reported AST  $\geq 5X$  ULN; with or without concomitant elevations in total bilirubin. No subjects treated with placebo experienced similar elevations [see *Warnings and Precautions (5.4)*].

### Crohn's Disease

OMVOH was studied up to 52 weeks in subjects with moderately to severely active Crohn's disease in a randomized, double-blind, placebo-controlled study (CD-1). The safety population consisted of 630 subjects who received OMVOH 900 mg administered as an intravenous infusion during induction at Weeks 0, 4, and 8 followed by OMVOH 300 mg administered as a subcutaneous injection every 4 weeks and 211 subjects who received placebo [see *Clinical Trials (14.2)*]. Eighty-five of the 211 placebo subjects in the safety population who did not achieve clinical response by patient-reported outcome at Week 12 were switched to blinded induction and maintenance treatment with OMVOH. Observed data from these 85 subjects are included in the placebo cohort up to Week 12 and in the OMVOH cohort after Week 12. In CD-1, OMVOH and placebo-treated subjects had different lengths of exposure, therefore, exposure adjusted incidence rates (EAIRs) are also displayed in Table 4 to compare adverse reactions.

### Common Adverse Reactions

Table 4 summarizes the frequencies and EAIRs per 100 person-years (PY) for adverse reactions reported in at least 5% of subjects treated with OMVOH and at a higher frequency than placebo during CD-1.

**Table 4: Adverse Reactions<sup>a</sup> in Subjects with Crohn's Disease through Week 52 In a Placebo-Controlled Study (CD-1)**

| Adverse Reactions                               | OMVOH <sup>b</sup><br>N=715, PY=655<br>n (%) [EAIR <sup>c</sup> ] | Placebo<br>N=211, PY=120<br>n (%) [EAIR <sup>c</sup> ] |
|---|---|--|
| Upper respiratory tract infections <sup>d</sup> | 199 (28) [37]   | 47 (22) [47]   |

|                                       |              |             |
|---------------------------------------|--------------|-------------|
| Injection site reactions <sup>e</sup> | 69 (10) [11] | 8 (4) [7]   |
| Headache <sup>f</sup>                 | 45 (6) [7]   | 9 (4) [8]   |
| Arthralgia                            | 44 (6) [7]   | 11 (5) [10] |
| Elevated liver tests <sup>g</sup>     | 36 (5) [6]   | 8 (4) [7]   |

Abbreviations: EAIR, exposure-adjusted incidence rate; PY, person-years

- <sup>a</sup> Reported in at least 5% of subjects and at a higher frequency than placebo
- <sup>b</sup> Following OMVOH 900 mg as an intravenous infusion at Week 0, Week 4, and Week 8, subjects received OMVOH 300 mg as a subcutaneous injection at Week 12 and every 4 weeks thereafter for up to an additional 40 weeks. In addition, eighty-five placebo subjects who did not achieve clinical response by patient-reported outcome at Week 12 were switched to blinded induction and maintenance treatment with OMVOH. The observed data after Week 12 from these eighty-five subjects were included in the OMVOH cohort.
- <sup>c</sup> EAIRs are per 100 PY. The EAIR per 100 PY can be interpreted as an estimated number of first occurrences of the adverse reaction of interest if 100 subjects were treated for one year.
- <sup>d</sup> Upper respiratory tract infections includes related terms (e.g., COVID-19, nasopharyngitis, pharyngitis, rhinitis, sinusitis, and upper respiratory tract infection).
- <sup>e</sup> Injection site reactions includes related terms (e.g., erythema, hematoma, induration, pain, pruritus, and reaction at the injection site).
- <sup>f</sup> Headache includes related terms (i.e., headache and migraine).
- <sup>g</sup> Elevated liver tests include related terms (e.g., ALT increased, AST increased, alkaline phosphatase increased, bilirubin increased, and GGT increased)

### *Hepatic Enzyme Elevations*

Of the subjects with reported adverse reactions of elevated liver tests (see Table 4), 3 subjects treated with OMVOH reported ALT  $\geq$ 5X ULN and 2 subjects reported AST  $\geq$ 5X ULN. Neither subject had a concomitant elevation in total bilirubin. No subjects treated with placebo experienced similar elevations.

### *Less Common Adverse Reactions (<5%)*

In CD-1 through Week 52, urticaria was reported by 13 (2%, 2 per 100 PY) subjects treated with OMVOH and no subjects treated with placebo.

### *Infections*

In CD-1 through Week 52, infections were reported by 282 (39%, 58 per 100 PY) subjects treated with OMVOH and 73 (35%, 81 per 100 PY) subjects treated with placebo. Serious infections in the OMVOH group included abscess (including abdominal abscess, anal abscess, gluteal abscess, and perineal abscess), cellulitis, pneumonia, and sepsis.

## **7 DRUG INTERACTIONS**

### **7.1 CYP450 Substrates**

Increased concentrations of cytokines (e.g., IL-1, IL-6, IL-10, TNF $\alpha$ , IFN) during chronic inflammation associated with certain diseases including Crohn's disease may suppress the formation of CYP450 enzymes. Therapeutic proteins, including mirikizumab-mrkz, that decrease the concentrations of these pro-inflammatory cytokines may increase the formation of CYP450 enzymes resulting in decreased CYP450 substrate exposure. Upon initiation or discontinuation of OMVOH in patients treated with concomitant CYP450 substrates, monitor drug concentrations or other therapeutic parameters, and adjust the dosage of the CYP450 substrate as needed. See the prescribing information of specific CYP450 substrates.

## **8 USE IN SPECIFIC POPULATIONS**

### **8.1 Pregnancy**

#### Pregnancy Exposure Registry

There will be a pregnancy exposure registry that monitors pregnancy outcomes in women exposed to OMVOH during pregnancy. Pregnant women exposed to OMVOH and healthcare providers are encouraged to call Eli Lilly and Company at 1-800-Lilly-Rx (1-800-545-5979).

## Risk Summary

Available data from case reports of mirikizumab-mrkz use in pregnant women are insufficient to evaluate for a drug-associated risk of major birth defects, miscarriage, or other adverse maternal or fetal outcomes. Although there are no data on mirikizumab-mrkz, monoclonal antibodies can be actively transported across the placenta, and mirikizumab-mrkz may cause immunosuppression in the in utero-exposed infant. An enhanced pre- and post-natal development study conducted in pregnant monkeys at a dose 20 times the maximum recommended human dose (MRHD) revealed no adverse developmental effects to the developing fetus, or harm to infant monkeys from birth through 6 months of age. There are risks of adverse pregnancy outcomes associated with increased disease activity in women with inflammatory bowel disease (see *Clinical Considerations*).

The background risk of major birth defects and miscarriage for the indicated population is unknown. All pregnancies have a background risk of birth defects, loss, or other adverse outcomes. In the U.S. general population, the estimated background risk of major birth defects and miscarriage in clinically recognized pregnancies is 2% to 4% and 15% to 20%, respectively.

## Clinical Considerations

### *Disease-Associated Maternal and Embryo/Fetal Risk*

Published data suggest that the risk of adverse pregnancy outcomes in women with inflammatory bowel disease (IBD) is associated with increased disease activity. Adverse pregnancy outcomes include preterm delivery (before 37 weeks gestation), low birth weight (less than 2500 g) infants, and small for gestational age at birth.

### *Fetal/Neonatal Adverse Reactions*

Transport of endogenous IgG antibodies across the placenta increases as pregnancy progresses, and peaks during the third trimester. It is unclear whether mirikizumab-mrkz may interfere with an infant's immune response to infections. Therefore, monitoring for the development of serious infection during the first 2 months of life in infants exposed in utero is recommended.

## Data

### *Animal Data*

An enhanced pre- and postnatal development study was conducted in cynomolgus monkeys administered mirikizumab-mrkz by intravenous injection during organogenesis to parturition at a dose of 300 mg/kg twice weekly (20 times the MRHD based on exposure comparisons). Mirikizumab-mrkz crossed the placenta in monkeys. No maternal toxicity was noted in this study. No mirikizumab-mrkz-related effects on morphological, functional or immunological development were observed in infant monkeys from birth through 6 months of age. However, incidences of embryo/fetal loss were higher in the treated groups compared to control (6.7% [1 of 15] in controls vs 26.7% [4 of 15] at 300 mg/kg (20 times the MRHD, based on exposure comparisons) but were within the range of historical control data. Following delivery, most adult female cynomolgus monkeys and all infants from the mirikizumab-mrkz-treated group had measurable serum concentrations up to 28 days postpartum. In the infant monkeys, mean serum concentrations were approximately 4.8 times the respective mean maternal concentrations.

## **8.2 Lactation**

### Risk Summary

There are no data on the presence of mirikizumab-mrkz in human milk, the effects on the breastfed infant, or the effects on milk production. Endogenous maternal IgG and monoclonal antibodies are transferred in human milk. The effects of local gastrointestinal exposure and limited systemic exposure in the breastfed infant to mirikizumab-mrkz are unknown. The developmental and health benefits of breastfeeding should be considered along with the mother's clinical need for OMVOH and any potential adverse effects on the breastfed infant from OMVOH or from the underlying maternal condition.

## **8.4 Pediatric Use**

The safety and effectiveness of OMVOH have not been established in pediatric patients.

## **8.5 Geriatric Use**

Of the 795 OMVOH-treated subjects in the two ulcerative colitis clinical studies, 64 subjects (8%) were 65 years of age and older, while 10 subjects (1%) were 75 years of age and older. Of the 715 OMVOH-treated subjects in the Crohn's

disease clinical study, 22 subjects (3%) were 65 years of age and older, while 6 subjects (1%) were 75 years of age and older). These clinical studies did not include sufficient numbers of subjects aged 65 and over to determine whether they respond differently from younger adult subjects. Other reported clinical experience has not identified differences in responses between the elderly and younger subjects. No clinically meaningful differences in the pharmacokinetics of mirikizumab-mrkz were observed in subjects 65 years of age and older compared to younger adult subjects [see *Clinical Pharmacology* (12.3)].

## 11 DESCRIPTION

Mirikizumab-mrkz is a humanized immunoglobulin G4 (IgG4) variant monoclonal antibody that is directed against the p19 subunit of IL-23 and does not bind IL-12. Mirikizumab-mrkz is produced in Chinese Hamster Ovary (CHO) cells by recombinant DNA technology and it is composed of two identical light chain polypeptides and two identical heavy chain polypeptides with an overall molecular weight of approximately 147 kDa.

### OMVOH for intravenous infusion for ulcerative colitis and Crohn's disease

OMVOH (mirikizumab-mrkz) injection is a sterile, preservative-free, clear to opalescent, colorless to slightly yellow to slightly brown solution in a single-dose vial for intravenous infusion after dilution. Each mL contains 20 mg of mirikizumab-mrkz, anhydrous citric acid (0.4 mg), polysorbate 80 (0.5 mg), sodium chloride (8.8 mg), sodium citrate (2.1 mg), and Water for Injection. The OMVOH solution has a pH range of 5.0 to 6.0.

### OMVOH (mirikizumab-mrkz) injection 100 mg/mL prefilled pen or prefilled syringe for subcutaneous use for ulcerative colitis and Crohn's disease

OMVOH (mirikizumab-mrkz) injection is a sterile, preservative free, clear to opalescent, colorless to slightly yellow to slightly brown solution for subcutaneous use available as 100 mg of mirikizumab-mrkz in a 1 mL single-dose prefilled pen or single-dose prefilled syringe. The prefilled pen and prefilled syringe contain a 1 mL glass syringe with a fixed 27-gauge ½ inch needle. The OMVOH 100 mg prefilled pen and prefilled syringe are manufactured to deliver 100 mg of mirikizumab-mrkz.

Each mL is composed of 100 mg mirikizumab-mrkz, histidine (0.1 mg), L-histidine hydrochloride monohydrate (0.9 mg), mannitol (33 mg), polysorbate 80 (0.3 mg), sodium chloride (2.9 mg), and Water for Injection. The OMVOH solution has a pH range of 5.0 to 5.8.

### OMVOH (mirikizumab-mrkz) injection 200 mg/2 mL prefilled pen or 200 mg/2 mL (100 mg/mL) prefilled syringe for subcutaneous use for ulcerative colitis and Crohn's disease

OMVOH (mirikizumab-mrkz) injection is a sterile, preservative free, clear to opalescent, colorless to slightly yellow to slightly brown solution for subcutaneous use. The 2 mL prefilled pen and prefilled syringe each contain a 2 mL glass syringe with a fixed 27-gauge 8 mm needle. The OMVOH 200 mg prefilled pen and prefilled syringe are manufactured to deliver 200 mg of mirikizumab-mrkz.

Each mL is composed of 100 mg mirikizumab-mrkz, histidine (0.1 mg), L-histidine hydrochloride monohydrate (0.9 mg), mannitol (33 mg), polysorbate 80 (0.3 mg), sodium chloride (2.9 mg), and Water for Injection. The OMVOH solution has a pH range of 5.0 to 5.8.

## 12 CLINICAL PHARMACOLOGY

### 12.1 Mechanism of Action

Mirikizumab-mrkz is a humanized IgG4 monoclonal antibody that selectively binds to the p19 subunit of human IL-23 cytokine and inhibits its interaction with the IL-23 receptor.

IL-23 is involved in mucosal inflammation and affects the differentiation, expansion, and survival of T cell subsets, and innate immune cell subsets, which represent sources of pro-inflammatory cytokines. Research in animal models has shown that pharmacologic inhibition of IL-23p19 can ameliorate intestinal inflammation.

Mirikizumab-mrkz inhibits the release of pro-inflammatory cytokines and chemokines.

## 12.2 Pharmacodynamics

In both study UC-1 (induction) and study UC-2 (maintenance), a positive relationship was observed between Mirikizumab-mrkz average concentration and rates of clinical remission and clinical response [see *Clinical Studies (14.1)*].

Mirikizumab exposure response relationships have not been fully characterized in subjects with Crohn's disease.

## 12.3 Pharmacokinetics

Mirikizumab-mrkz exhibited linear pharmacokinetics with dose-proportional increase in exposure over a dose range of 60 to 2400 mg given as an intravenous injection or over a dose range of 200 to 400 mg given as a subcutaneous injection, in healthy volunteers. There was no apparent accumulation of mirikizumab-mrkz concentrations in serum over time when administered as a subcutaneous injection every 4 weeks to subjects with ulcerative colitis or Crohn's disease. The estimated exposure parameters of mirikizumab-mrkz at steady state are summarized in Tables 5 for ulcerative colitis and 6 for Crohn's disease.

**Table 5: Mirikizumab-mrkz Estimated Systemic Exposure at Steady State in Subjects with Ulcerative Colitis**

|  | <b>OMVOH<br/>300 mg Intravenous Infusion<sup>a</sup></b><br>Geometric mean (CV%) | <b>OMVOH<br/>200 mg Subcutaneous Injection<sup>b</sup></b><br>Geometric mean (CV%) |
|--|--|--|
| $C_{max, ss}$ (µg/mL) <sup>c</sup>       | 99.7 (22.7%)   | 10.1 (52.1%)   |
| $AUC_{tau, ss}$ (µg*day/mL) <sup>c</sup> | 538 (34.4%)  | 160 (57.6%)  |
| $C_{trough, ss}$ (µg/mL) <sup>c</sup>    | 2.75 (101%)  | 1.70 (83.3%)   |

<sup>a</sup> OMVOH 300 mg as an intravenous infusion over at least 30 minutes at Weeks 0, 4, and 8.

<sup>b</sup> OMVOH 200 mg as 2 subcutaneous injections (100 mg/mL each) at Week 12 and every 4 weeks thereafter for up to an additional 40 weeks.

<sup>c</sup>  $AUC_{tau, ss}$  = area under the concentration-versus-time curve over one dosing interval at steady state;  $C_{max, ss}$  = maximum concentration at steady state;  $C_{trough, ss}$  = concentration at the end of the dosing interval at steady state; CV = geometric coefficient of variation.

**Table 6: Mirikizumab-mrkz Estimated Systemic Exposure at Steady State in Subjects with Crohn's Disease**

|  | <b>OMVOH<br/>900 mg Intravenous Infusion<sup>a</sup></b><br>Geometric mean (CV%) | <b>OMVOH<br/>300 mg Subcutaneous Injection<sup>b</sup></b><br>Geometric mean (CV%) |
|--|--|--|
| $C_{max, ss}$ (µg/mL) <sup>c</sup>       | 332 (21%)  | 13.6 (48%)   |
| $AUC_{tau, ss}$ (µg*day/mL) <sup>c</sup> | 1820 (38%)   | 220 (56%)  |
| $C_{trough, ss}$ (µg/mL) <sup>c</sup>    | 10.4 (108%)  | 2.52 (88%)   |

<sup>a</sup> OMVOH 900 mg as an intravenous infusion over at least 90 minutes at Weeks 0, 4, and 8.

<sup>b</sup> OMVOH 300 mg as 2 subcutaneous injections (100 mg/mL and 200 mg/2 mL) at Week 12 and every 4 weeks thereafter up to Week 52.

<sup>c</sup>  $AUC_{tau, ss}$  = area under the concentration-versus-time curve over one dosing interval at steady state;  $C_{max, ss}$  = maximum concentration at steady state;  $C_{trough, ss}$  = concentration at the end of the dosing interval at steady state; CV = geometric coefficient of variation.

### Absorption

Following subcutaneous dosing of OMVOH for ulcerative colitis median (range)  $T_{max}$  was 5 (3.08 to 6.75) days post dose and geometric mean (CV%) absolute bioavailability was 44% (34%).

Following subcutaneous dosing of OMVOH for Crohn's disease, median (range)  $T_{max}$  was 5 (3 to 6.83) days post dose and geometric mean (CV%) absolute bioavailability was 36.3% (31%).

Injection site location (abdomen, upper arm, or thigh) did not significantly influence bioavailability of mirikizumab-mrkz following subcutaneous injection.

### Distribution

In subjects with ulcerative colitis, the geometric mean (CV%) total volume of distribution was 4.83 L (21%).

In subjects with Crohn's disease, the geometric mean (CV%) total volume of distribution was 4.4 L (14%).

### Metabolism/Elimination

Mirikizumab-mrkz is a humanized IgG4 monoclonal antibody and is expected to be degraded into small peptides and amino acids via catabolic pathways in the same manner as endogenous IgG.

In subjects with ulcerative colitis, the geometric mean (CV%) clearance was 0.0229 L/hours (34%) and the geometric mean (CV%) elimination half-life was 9.3 days (40%). Clearance is independent of dose.

In subjects with Crohn's disease, the geometric mean (CV%) clearance was 0.0202 L/hours (38%) and the geometric mean (CV%) elimination half-life was 9.3 days (26%). Clearance is independent of dose.

### Specific Populations

There were no clinically significant differences in the pharmacokinetics of mirikizumab-mrkz based on age (18 to 79 years), sex, race (White or Asian), or mild and moderate renal impairment (i.e., estimated creatinine clearance by Cockcroft-Gault equation: 30 to 89 mL/min).

### *Body Weight*

Following intravenous administration of 300 mg, the recommended induction dose, in subjects with ulcerative colitis weighing 90 kg or greater, the estimated geometric mean mirikizumab-mrkz average concentration ( $C_{avg}$ ) was 20% lower compared with subjects weighing less than 90 kg. Following subcutaneous administration of 200 mg, the recommended maintenance dose, in subjects with ulcerative colitis weighing 90 kg or greater, the estimated geometric mean  $C_{avg}$  was 38% lower compared with subjects weighing less than 90 kg. In Study UC-2 (maintenance), the rate of clinical remission and clinical response did not differ significantly between subjects weighing 90 kg or greater and subjects weighing less than 90 kg.

Following intravenous administration of 900 mg, the recommended induction dose, in subjects with Crohn's disease weighing 90 kg or greater, the estimated geometric mean mirikizumab-mrkz  $C_{avg}$  was 13% lower compared with subjects weighing less than 90 kg. Following subcutaneous administration of 300 mg, the recommended maintenance dose, in subjects with Crohn's disease weighing 90 kg or greater, the estimated geometric mean  $C_{avg}$  was 34% lower compared with subjects weighing less than 90 kg. The rate of clinical remission and clinical response in Crohn's disease did not differ significantly between subjects weighing 90 kg or greater and subjects weighing less than 90 kg.

### Drug Interaction Studies

Population pharmacokinetic analyses indicated that the clearance of OMVOH was not impacted by concomitant administration of aminosalicylates, corticosteroids, or oral immunomodulators (6-MP, AZA, MTX, tioguanine) in subjects with ulcerative colitis or Crohn's disease.

No drug-drug interaction studies were conducted in subjects with ulcerative colitis or Crohn's disease at the recommended dosage. Based on a clinical drug-drug interaction study conducted in subjects with another condition, multiple subcutaneous doses of 250 mg every 4 weeks of mirikizumab-mrkz did not result in changes in the exposure of midazolam (CYP3A substrate), warfarin (CYP2C9 substrate), dextromethorphan (CYP2D6 substrate), omeprazole (CYP2C19 substrate), or caffeine (CYP1A2 substrate).

## **12.6 Immunogenicity**

The observed incidence of anti-drug antibodies is highly dependent on the sensitivity and specificity of the assay. Differences in assay methods preclude meaningful comparisons of the incidence of anti-drug antibodies in the studies described below with the incidence of anti-drug antibodies in other studies, including those of mirikizumab-mrkz or of other mirikizumab products.

During the 52-week treatment period in studies UC-1 and UC-2, 23% (88/378) of OMVOH-treated subjects at the recommended dosage and evaluable for assessment, developed anti-mirikizumab-mrkz antibodies (referred to as anti-drug antibodies (ADA)). Of those who developed ADA, 33/88 (38%) developed titers  $\geq 1:160$ . Of these 33 OMVOH-treated

subjects, 10 had reduced serum trough concentrations of mirikizumab-mrkz compared to subjects who did not develop anti-mirikizumab-mrkz antibodies, and 5 of these 10 subjects did not achieve clinical response at Week 52. There is insufficient data to assess whether the observed ADA-associated pharmacokinetic changes reduced effectiveness. There is no identified clinically significant effect of ADA on the safety of OMVOH over the treatment duration of 52-weeks.

During the 52-week treatment period in study CD-1, 13% (79/622) of OMVOH-treated subjects at the recommended dosage and evaluable for assessment developed ADA. There is no identified clinically significant effect of ADA on the pharmacokinetics, effectiveness, or safety of OMVOH over the treatment duration of 52-weeks.

## 13 NONCLINICAL TOXICOLOGY

### 13.1 Carcinogenesis, Mutagenesis, Impairment of Fertility

Animal studies have not been conducted to evaluate the carcinogenic or mutagenic potential of mirikizumab-mrkz.

No organ weight or histopathology effects were observed in the male or female reproductive tract in sexually mature cynomolgus monkeys that received subcutaneous mirikizumab-mrkz once weekly for 26 weeks, at a dose of 100 mg/kg (at least 2 times the MRHD of mirikizumab-mrkz, based on exposure comparisons).

## 14 CLINICAL STUDIES

### 14.1 Ulcerative Colitis

The safety and efficacy of OMVOH was evaluated in two randomized, double-blind, placebo-controlled clinical studies, one induction study [UC-1 (NCT03518086)] and one maintenance study [UC-2 (NCT03524092)], in adult subjects with moderately to severely active ulcerative colitis who had inadequate response, loss of response, or failed to tolerate any of the following: corticosteroids, 6-mercaptopurine, azathioprine, biologic therapy (TNF blocker, vedolizumab), or tofacitinib. The 12-week intravenous induction study (UC-1) was followed by the 40-week subcutaneous randomized withdrawal maintenance study (UC-2).

#### Study UC-1

In UC-1, efficacy was evaluated in 1062 subjects who were randomized 3:1 at Week 0 to receive 300 mg OMVOH or placebo by intravenous infusion at Week 0, Week 4, and Week 8. Subjects had a mean age of 43 years (range 18 to 79 years); 40% were female; and 71% identified as White, 25% as Asian, 1% as American Indian or Alaska Native, 1% as Black or African American, and <2% as another racial group or did not report their racial group. Subjects were permitted to use stable doses of aminosalicylates, immunomodulators (6-mercaptopurine, azathioprine, methotrexate), and oral corticosteroids (prednisone  $\leq$ 20 mg/day or equivalent, extended-release budesonide 9 mg/day, beclomethasone dipropionate 5 mg/day). At baseline, 41% of subjects were receiving oral corticosteroids, 24% were receiving immunomodulators, and 75% were receiving aminosalicylates.

At baseline, 57% were biologic and Janus Kinase inhibitor (JAKi) naive, 41% had failed at least one biologic, 3% had failed a JAKi, and 2% had previously received but had not failed a biologic or JAKi.

Disease activity was assessed based on the modified Mayo score (mMS), which ranges from 0 to 9 and has three subscores that are each scored from 0 (normal) to 3 (most severe): stool frequency, rectal bleeding, and findings on centrally read endoscopy subscore. At baseline, subjects had a mMS of 5 to 9, including a centrally read endoscopy subscore of 2 or 3. An endoscopy subscore of 2 was defined by marked erythema, absent vascular pattern, friability, and erosions; and a subscore of 3 was defined by spontaneous bleeding and ulceration. Subjects had a median mMS of 7, and 58% had severely active disease (mMS of 7 to 9).

The primary endpoint was clinical remission at Week 12. The secondary endpoints were clinical response, endoscopic improvement, and histologic-endoscopic mucosal improvement (see Table 7).

**Table 7: Proportion of Subjects with Ulcerative Colitis Meeting Efficacy Endpoints in UC-1 at Week 12**

| Endpoint                        | Placebo | OMVOH 300 mg Intravenous Infusion <sup>a</sup> | Treatment Difference <sup>b</sup> (95% CI) |
|---------------------------------|---------|--|--|
| Clinical remission <sup>c</sup> |         |  |  |

|  |                |                |                              |
|--|----------------|----------------|------------------------------|
| Total Population                                       | N = 267<br>15% | N = 795<br>24% | 10% <sup>d</sup><br>(5, 15)  |
| Biologic and JAKi naive                                | N = 155<br>18% | N = 450<br>31% |                              |
| Prior biologic or JAKi failure <sup>e</sup>            | N = 107<br>8%  | N = 331<br>15% |                              |
| Clinical response <sup>f</sup>                         |                |                |                              |
| Total Population                                       | N = 267<br>43% | N = 795<br>65% | 22% <sup>d</sup><br>(15, 28) |
| Biologic and JAKi naive                                | N = 155<br>52% | N = 450<br>71% |                              |
| Prior biologic or JAKi failure <sup>d, e</sup>         | N = 107<br>31% | N = 331<br>56% |                              |
| Endoscopic improvement <sup>g</sup>                    |                |                |                              |
| Total Population                                       | N = 267<br>21% | N = 795<br>34% | 14% <sup>d</sup><br>(8, 20)  |
| Biologic and JAKi naive                                | N = 155<br>28% | N = 450<br>44% |                              |
| Prior biologic or JAKi failure <sup>e</sup>            | N = 107<br>10% | N = 331<br>22% |                              |
| Histologic-endoscopic mucosal improvement <sup>h</sup> |                |                |                              |
| Total Population                                       | N = 267<br>14% | N = 795<br>25% | 11% <sup>d</sup><br>(6, 16)  |
| Biologic and JAKi naive                                | N = 155<br>19% | N = 450<br>34% |                              |
| Prior biologic or JAKi failure <sup>e</sup>            | N = 107<br>7%  | N = 331<br>13% |                              |

JAKi = Janus Kinase inhibitor

<sup>a</sup> OMVOH 300 mg as an intravenous infusion at Week 0, Week 4, and Week 8.

<sup>b</sup> Adjusted treatment difference based on Cochran-Mantel-Haenszel method adjusted for randomization stratification factors.

<sup>c</sup> Clinical remission based on mMS is defined as: stool frequency subscore = 0 or 1, rectal bleeding subscore = 0, and centrally read endoscopy subscore = 0 or 1 (excluding friability).

<sup>d</sup> Tested at an alpha level of 0.00125, with a p-value <0.001.

<sup>e</sup> Prior biologic or JAKi failure includes loss of response, inadequate response, or intolerance to one or more biologic therapy (TNF blocker or vedolizumab), or tofacitinib.

<sup>f</sup> Clinical response is defined as a decrease in the mMS of  $\geq 2$  points with  $\geq 30\%$  decrease from baseline, and either a decrease of  $\geq 1$  point in the rectal bleeding subscore from baseline or a rectal bleeding subscore of 0 or 1.

<sup>g</sup> Endoscopic improvement is defined as a centrally read endoscopy subscore of 0 or 1 (excluding friability).

<sup>h</sup> Histologic-endoscopic mucosal improvement is defined as achieving both endoscopic improvement (centrally read endoscopy subscore of 0 or 1, excluding friability) and histologic improvement (neutrophil infiltration in <5% of crypts, no crypt destruction, and no erosions, ulcerations, or granulation tissue based on the Geboes scoring system).

Study UC-1 was not designed to evaluate the relationship of histologic-endoscopic mucosal improvement at Week 12 to disease progression and long-term outcomes.

#### *Rectal Bleeding and Stool Frequency Subscores*

Decreases in rectal bleeding and stool frequency subscores were observed as early as Week 3 in subjects treated with OMVOH compared to subjects on placebo.

### Study UC-2

The maintenance study (UC-2) evaluated 506 subjects who achieved clinical response at Week 12 in Study UC-1. These subjects were randomized 2:1 to receive 200 mg OMVOH or placebo subcutaneously every 4 weeks for 40 weeks in UC-2, for a total of 52 weeks of treatment. Subjects who were on concomitant ulcerative colitis therapies during UC-1 were required to continue on stable doses of oral aminosalicylates and immunomodulators (6-mercaptopurine, azathioprine, methotrexate). Corticosteroid tapering was required for subjects who were receiving corticosteroids at baseline and achieved clinical response in UC-1.

The primary endpoint was clinical remission at Week 40. The secondary endpoints were endoscopic improvement, maintenance of clinical remission in subjects who achieved clinical remission at Week 12, corticosteroid-free clinical remission, and histologic-endoscopic mucosal improvement (see Table 8).

**Table 8: Proportion of Subjects with Ulcerative Colitis Meeting Efficacy Endpoints in UC-2 at Week 40 (a total of 52 weeks of treatment)**

| Endpoint  | Placebo <sup>a</sup> | OMVOH<br>200 mg<br>Subcutaneous Injection <sup>b</sup> | Treatment Difference <sup>c</sup><br>(95% CI) |
|---|----------------------|--|---|
| Clinical remission <sup>d, e</sup>  |                      |  |   |
| Total Population  | N = 169<br>27%       | N = 337<br>51%   | 22% <sup>f</sup><br>(14, 31)                  |
| Biologic and JAKi naive   | N = 109<br>33%       | N = 208<br>53%   |   |
| Prior biologic or JAKi failure <sup>g</sup>   | N = 59<br>15%        | N = 121<br>45%   |   |
| Endoscopic improvement <sup>d, h</sup>  |                      |  |   |
| Total Population  | N = 169<br>30%       | N = 337<br>58%   | 27% <sup>f</sup><br>(19, 36)                  |
| Biologic and JAKi naive   | N = 109<br>35%       | N = 208<br>62%   |   |
| Prior biologic or JAKi failure <sup>g</sup>   | N = 59<br>20%        | N = 121<br>50%   |   |
| Maintenance of clinical remission in patients who achieved clinical remission at Week 12 <sup>i</sup> |                      |  |   |
| Total Population  | N = 62<br>40%        | N = 128<br>66%   | 23% <sup>j</sup><br>(8, 38)                   |
| Biologic and JAKi naive   | N = 48<br>48%        | N = 91<br>66%  |   |
| Prior biologic or JAKi failure <sup>g</sup>   | N = 14<br>14%        | N = 34<br>65%  |   |
| Corticosteroid-free clinical remission <sup>d, k</sup>  |                      |  |   |
| Total Population  | N = 169<br>27%       | N = 337<br>50%   | 22% <sup>f</sup><br>(13, 30)                  |
| Biologic and JAKi naive   | N = 109<br>33%       | N = 208<br>52%   |   |
| Prior biologic or JAKi failure <sup>g</sup>   | N = 59<br>15%        | N = 121<br>45%   |   |
| Histologic-endoscopic mucosal improvement <sup>d, l</sup>   |                      |  |   |
| Total Population  | N = 169              | N = 337  | 19% <sup>f</sup>                              |

| Endpoint                                    | Placebo <sup>a</sup> | OMVOH 200 mg Subcutaneous Injection <sup>b</sup> | Treatment Difference <sup>c</sup> (95% CI) |
|---|----------------------|--|--|
|   | 22%                  | 43%  | (11, 27)                                   |
| Biologic and JAKi naive                     | N = 109<br>27%       | N = 208<br>47%                                   |  |
| Prior biologic or JAKi failure <sup>g</sup> | N = 59<br>14%        | N = 121<br>36%                                   |  |

JAKi = Janus Kinase inhibitor

- <sup>a</sup> The placebo arm includes subjects treated with OMVOH during the induction study (UC-1) and were randomized to receive placebo through Week 40.
- <sup>b</sup> OMVOH 200 mg as a subcutaneous injection at Week 12 and every 4 weeks thereafter for up to an additional 40 weeks.
- <sup>c</sup> Adjusted treatment difference (95% CI) based on Cochran-Mantel-Haenszel method adjusted for randomization stratification factors.
- <sup>d</sup> Among subjects who achieved clinical response at Week 12 in UC-1 with OMVOH induction treatment.
- <sup>e</sup> Clinical remission based on mMS is defined as: stool frequency subscore = 0 or 1, rectal bleeding subscore = 0, and centrally read endoscopy subscore = 0 or 1 (excluding friability).
- <sup>f</sup>  $p < 0.001$ .
- <sup>g</sup> Prior biologic or JAKi failure includes loss of response, inadequate response, or intolerance to one or more biologic therapy (TNF blocker or vedolizumab), or tofacitinib.
- <sup>h</sup> Endoscopic improvement is defined as a centrally read endoscopy subscore of 0 or 1 (excluding friability).
- <sup>i</sup> Among subjects who achieved clinical remission at Week 12 in UC-1 with OMVOH induction treatment.
- <sup>j</sup>  $p < 0.01$ .
- <sup>k</sup> Corticosteroid-free clinical remission is defined as clinical remission at Week 40 and no corticosteroid use for  $\geq 12$  weeks prior to Week 40 assessment.
- <sup>l</sup> Histologic-endoscopic mucosal improvement is defined as achieving both endoscopic improvement (centrally read endoscopy subscore of 0 or 1, excluding friability) and histologic improvement (no neutrophils in crypts or lamina propria, no crypt destruction, and no erosions, ulcerations, or granulation tissue based on the Geboes scoring system).

Study UC-2 was not designed to evaluate the relationship of histologic-endoscopic mucosal improvement at Week 40 to disease progression and long-term outcomes.

### *Bowel Urgency*

Bowel urgency was assessed during UC-1 and UC-2 with an Urgency Numeric Rating Scale (NRS) of 0 to 10. A greater proportion of subjects with a baseline Urgency NRS weekly average score  $\geq 3$  treated with OMVOH compared to placebo reported an Urgency NRS weekly average score of 0 or 1 (39% versus 23%) at Week 40. Urgency NRS weekly average scores of 0 to 1 were also observed in a greater proportion of subjects treated with OMVOH compared to placebo at Week 12.

### *Endoscopic Assessment*

Normalization of the endoscopic appearance of the mucosa (endoscopic remission) was defined as a Mayo endoscopic subscore of 0. At Week 40 in UC-2, endoscopic remission was observed in a greater proportion of subjects treated with OMVOH compared to placebo (22% versus 14%).

## **14.2 Crohn's Disease**

The safety and efficacy of OMVOH was evaluated in a randomized, double-blind, placebo-controlled study [CD-1 (NCT03926130)] in adult subjects with moderately to severely active Crohn's disease who had an inadequate response, loss of response, or intolerance to corticosteroids, immunomodulators (azathioprine, 6-mercaptopurine, and methotrexate), and/or biologics (TNF blockers, integrin receptor antagonists).

In CD-1, the efficacy population consisted of 679 subjects who were randomized 3:1 at Week 0 to receive OMVOH 900 mg by intravenous infusion at Week 0, Week 4, and Week 8 followed by a dosage of 300 mg by subcutaneous injection at Week 12 and then every 4 weeks for 40 weeks, or placebo. Subjects had a mean age of 36 years (range 18 to 74 years); 42% were female; and 71% identified as White, 25% as Asian, <1% as American Indian or Alaska Native, 1%

as Black or African American, and 2% as another racial group or did not report their racial group. Subjects were permitted to use stable doses of oral corticosteroids (prednisone  $\leq$ 30 mg/day or equivalent, extended-release budesonide 9 mg/day), immunomodulators (6-mercaptopurine, azathioprine, or methotrexate) and/or aminosalicylates. At baseline, 31% of subjects were receiving oral corticosteroids, 26% were receiving immunomodulators, and 44% were receiving aminosalicylates.

At baseline, 47% had a loss of response, inadequate response, or intolerance to one or more biologic therapy.

Disease activity at baseline was assessed by the Crohn's Disease Activity Index (CDAI) and the Simple Endoscopic Score for Crohn's disease (SES-CD). Moderately to severely active CD was defined by a CDAI of  $\geq$ 220 and an SES-CD  $\geq$ 7 (centrally read) for subjects with ileal-colonic disease or  $\geq$ 4 for subjects with isolated ileal disease. At baseline, subjects had a median CDAI of 329 and SES-CD of 12.

The coprimary endpoints of clinical remission by CDAI and endoscopic response by SES-CD were assessed at Week 52. Secondary efficacy endpoints included endoscopic response at Week 12 and endoscopic remission and corticosteroid-free clinical remission at Week 52 (see Table 9).

**Table 9: Proportion of Subjects with Crohn's Disease Meeting Efficacy Endpoints in CD-1**

|  | Placebo <sup>a</sup> | OMVOH <sup>b</sup> | Treatment Difference <sup>c</sup><br>(95% CI) |
|--|----------------------|--------------------|---|
| <b>Coprimary Endpoints</b>                                     |                      |                    |   |
| Clinical remission <sup>d</sup> at Week 52                     |                      |                    |   |
| Total population   | N = 168<br>36%       | N = 511<br>53%     | 17% <sup>e</sup><br>(9%, 25%)                 |
| Without prior biologic failure                                 | N = 89<br>45%        | N = 268<br>56%     |   |
| Prior biologic failure <sup>f</sup>                            | N = 79<br>25%        | N = 243<br>49%     |   |
| Endoscopic response <sup>g</sup> at Week 52                    |                      |                    |   |
| Total population   | N = 168<br>23%       | N = 511<br>46%     | 23% <sup>e</sup><br>(15%, 30%)                |
| Without prior biologic failure                                 | N = 89<br>27%        | N = 268<br>49%     |   |
| Prior biologic failure <sup>f</sup>                            | N = 79<br>18%        | N = 243<br>43%     |   |
| <b>Additional Endpoints</b>                                    |                      |                    |   |
| Endoscopic response <sup>g</sup> at Week 12                    |                      |                    |   |
| Total population   | N = 168<br>11%       | N = 511<br>32%     | 22% <sup>e</sup><br>(16%, 28%)                |
| Without prior biologic failure                                 | N = 89<br>12%        | N = 268<br>37%     |   |
| Prior biologic failure <sup>f</sup>                            | N = 79<br>9%         | N = 243<br>28%     |   |
| Corticosteroid-free clinical remission <sup>i</sup> at Week 52 |                      |                    |   |
| Total population   | N = 168<br>35%       | N = 511<br>50%     | 16% <sup>e</sup><br>(7%, 24%)                 |
| Without prior biologic failure                                 | N = 89<br>43%        | N = 268<br>54%     |   |
| Prior biologic failure <sup>f</sup>                            | N = 79<br>25%        | N = 243<br>46%     |   |

| Endoscopic remission <sup>h</sup> at Week 52 |               |                |                               |
|--|---------------|----------------|-------------------------------|
| Total population                             | N = 168<br>8% | N = 511<br>19% | 11% <sup>e</sup><br>(6%, 16%) |
| Without prior biologic failure               | N = 89<br>10% | N = 268<br>22% |                               |
| Prior biologic failure <sup>f</sup>          | N = 79<br>5%  | N = 243<br>16% |                               |

CI = confidence interval

- <sup>a</sup> The placebo group includes all 168 subjects randomized to placebo at baseline. Of those, 67 (40%) subjects who did not achieve clinical response by patient-reported outcome at Week 12 were switched to treatment with OMVOH and their efficacy data are included here with the remaining subjects randomized to placebo who did not receive OMVOH.
- <sup>b</sup> Following OMVOH 900 mg as an intravenous infusion at Week 0, Week 4, and Week 8, subjects received OMVOH 300 mg as a subcutaneous injection at Week 12 and every 4 weeks thereafter for up to an additional 40 weeks.
- <sup>c</sup> Adjusted treatment difference was based on Cochran-Mantel-Haenszel method adjusted for randomization stratification factors.
- <sup>d</sup> Clinical remission is defined as CDAI <150.
- <sup>e</sup> p-value <0.001.
- <sup>f</sup> Prior biologic failure includes loss of response, inadequate response, or intolerance to one or more biologic therapy (TNF blockers, and integrin receptor antagonists).
- <sup>g</sup> Endoscopic response is defined as >50% reduction from baseline in SES-CD total score, based on central reading.
- <sup>h</sup> Endoscopic remission is defined as SES-CD total score ≤4 and at least a 2-point reduction from baseline, with no segment subscore >1, based on central reading.
- <sup>i</sup> Corticosteroid-free clinical remission is defined as subjects who were corticosteroid-free from Week 40 to Week 52, and had a CDAI <150 at Week 52.

### Stool Frequency and Abdominal Pain

In CD-1, reductions in abdominal pain were observed as early as Week 6 and in stool frequency as early as Week 12 in subjects treated with OMVOH compared to placebo.

### Fatigue

In CD-1, subjects treated with OMVOH experienced a clinically meaningful improvement in fatigue, assessed by the change from baseline in the Functional Assessment of Chronic Illness Therapy Fatigue Scale (FACIT-Fatigue), at Week 12, compared to placebo-treated subjects. The effect of OMVOH to improve fatigue after 12 weeks has not been established.

### Other Assessments at Week 12

In CD-1, a greater proportion of subjects treated with OMVOH compared to placebo achieved clinical remission (34% versus 23%) and endoscopic remission (10% versus 4%) at Week 12.

## 16 HOW SUPPLIED/STORAGE AND HANDLING

OMVOH (mirikizumab-mrkz) injection is a sterile, preservative-free, clear to opalescent, colorless to slightly yellow to slightly brown solution for intravenous infusion or subcutaneous injection.

OMVOH is supplied in indication specific packaging as:

**Table 10: Packaging Information for OMVOH**

| Presentation            | Indication                             | Package Size | NDC Code     |
|-------------------------|--|--------------|--------------|
| Single-dose Vial        |  |              |              |
| 300 mg/15 mL (20 mg/mL) | Ulcerative colitis and Crohn's disease | Carton of 1  | 0002-7575-01 |

| Single-dose Prefilled Pen              |                    |                            |              |
|--|--------------------|----------------------------|--------------|
| 100 mg/mL + 100 mg/mL                  | Ulcerative colitis | Carton of 2                | 0002-8011-27 |
| 200 mg/2 mL                            | Ulcerative colitis | Carton of 1                | 0002-3116-11 |
| 200 mg/2 mL + 100 mg/mL                | Crohn's disease    | Carton of 2<br>(1 of each) | 0002-7717-11 |
| Single-dose Prefilled Syringe          |                    |                            |              |
| 100 mg/mL + 100 mg/mL                  | Ulcerative colitis | Carton of 2                | 0002-8870-27 |
| 200 mg/2 mL (100 mg/mL)                | Ulcerative colitis | Carton of 1                | 0002-1442-11 |
| 200 mg/2 mL (100 mg/mL)<br>+ 100 mg/mL | Crohn's disease    | Carton of 2<br>(1 of each) | 0002-7722-11 |

Note to Pharmacist: The entire carton of 2 prefilled pen or 2 prefilled syringes are to be dispensed as a unit.

Each 100 mg/mL single-dose prefilled pen or prefilled syringe consists of a 1 mL glass syringe with a fixed 27-gauge ½ inch needle.

Each 200 mg/2 mL single-dose prefilled pen or 200 mg/2 mL (100 mg/mL) prefilled syringe consists of a 2 mL glass syringe with a fixed 27-gauge 8 mm needle.

#### Storage and Handling

- Store refrigerated at 2°C to 8°C (36°F to 46°F).
- Do not freeze. Do not use OMVOH if it has been frozen.
- Do not shake.
- Keep OMVOH in the original carton to protect from light until the time of use.
- OMVOH is sterile and preservative-free. Discard any unused portion.
- If needed, the prefilled pen or prefilled syringe may be stored at room temperature up to 30°C (86°F) for up to 2 weeks in the original carton to protect from light. Once OMVOH has been stored at room temperature, do not return to the refrigerator. If these conditions are exceeded, OMVOH must be discarded.
- The vial, prefilled pen, and prefilled syringe are not made with dry natural rubber latex.

## **17 PATIENT COUNSELING INFORMATION**

Advise the patient and/or caregiver to read the FDA-approved patient labeling (Medication Guide and Instructions for Use).

#### Hypersensitivity Reactions

Advise patients to discontinue OMVOH and seek immediate medical attention if they experience any symptoms of serious hypersensitivity reactions [see *Warnings and Precautions* (5.1)].

#### Infections

Advise patients that OMVOH may lower the ability of their immune system to fight infections and to contact their healthcare provider immediately if they develop any symptoms of infection [see *Warnings and Precautions* (5.2)].

#### Tuberculosis

Advise patients to contact their healthcare provider if they experience symptoms suggestive of TB (e.g., unexplained fever, cough, or difficulty breathing) [see *Warnings and Precautions* (5.3)].

### Hepatotoxicity

Inform patients that OMVOH may cause liver injury. Advise patients to seek immediate medical attention if they experience symptoms suggestive of liver dysfunction (e.g., unexplained rash, nausea, vomiting, abdominal pain, fatigue, anorexia, or jaundice and/or dark urine) [see *Warnings and Precautions (5.4)*].

### Immunizations

Advise patients that vaccination with live vaccines is not recommended during OMVOH treatment and immediately prior to or after OMVOH treatment. Medications that interact with the immune system may increase the risk of infection following administration of live vaccines. Instruct patients to inform their healthcare provider that they are taking OMVOH prior to receiving a vaccination [see *Warnings and Precautions (5.5)*].

### Pregnancy

Advise patients who are exposed to OMVOH during pregnancy to contact Eli Lilly and Company [see *Use in Specific Populations (8.1)*].

### Administration

Instruct patients in preparation and administration of OMVOH, including choosing anatomical sites for subcutaneous administration, and proper subcutaneous injection technique. Instruct patients in the technique of prefilled pen or prefilled syringe disposal [see *Instructions for Use*].

Instruct ulcerative colitis patients or caregivers to administer either:

- Two 100 mg prefilled pens or two 100 mg prefilled syringes to achieve the full 200 mg dose of OMVOH.
- One 200 mg prefilled pen or one 200 mg prefilled syringe to achieve the full 200 mg dose of OMVOH.

Instruct Crohn's disease patients or caregivers to administer a 100 mg prefilled pen or prefilled syringe and a 200 mg prefilled pen or prefilled syringe in any order to achieve the full 300 mg dose of OMVOH.

**Eli Lilly and Company, Indianapolis, IN 46285, USA**  
**US License No. 1891**

Copyright © 2023, 2025, Eli Lilly and Company. All rights reserved.

Pat.: [www.lilly.com/patents](http://www.lilly.com/patents)

A2.0-OMV-0003-USPI-YYYYMMDD

## Medication Guide

OMVOH™ (ahm-VOH)

(mirikizumab-mrkz)

injection, for intravenous or subcutaneous use

### What is the most important information I should know about OMVOH?

#### OMVOH can cause serious side effects, including:

- **Serious allergic reactions.** OMVOH may cause serious allergic reactions that may need to be treated in a hospital and may be life-threatening. Stop using OMVOH and get emergency medical help right away if you develop any of the following symptoms of a serious allergic reaction:
  - fainting, dizziness, feeling lightheaded (low blood pressure)
  - trouble breathing, throat tightening or wheezing
  - fast heartbeat or pounding in your chest (tachycardia)
  - swelling of your face, eyelids, lips, mouth, tongue, throat, or trouble swallowing
  - chest tightness
  - severe itching, hives, or redness all over your body
  - sweating
- **Infections.** OMVOH may lower the ability of your immune system to fight infections and may increase your risk of infections. Your healthcare provider should not start treatment with OMVOH until your infection is gone.
  - Before starting your treatment with OMVOH, your healthcare provider should test you for tuberculosis (TB).
  - If your healthcare provider feels that you are at risk for TB, you may be treated with medicine for TB before you begin treatment with OMVOH.
  - Your healthcare provider should watch you closely for signs and symptoms of TB while you are being treated with OMVOH and after treatment.
  - Before starting OMVOH, tell your healthcare provider if you think you have an infection or have symptoms of an infection such as:
    - fever, sweating, or chills
    - flu-like symptoms
    - diarrhea or stomach pain
    - muscle aches and pain
    - headache
    - weight loss
    - cough or shortness of breath
    - warm, red, or painful skin or sores on your body
    - nausea or vomiting
    - blood in your mucus (phlegm)
    - pain during urination

After starting OMVOH, tell your healthcare provider right away if you have any symptoms of an infection.

- **Liver problems.** OMVOH may cause liver problems. Your healthcare provider will do blood tests to check your liver enzyme and bilirubin levels before treatment, for at least 24 weeks during treatment, and possibly after treatment with OMVOH. Your healthcare provider may hold or stop your treatment if needed. Tell your healthcare provider right away if you develop any signs and symptoms of liver problems, including:
  - unexplained rash
  - feeling tired
  - nausea
  - loss of appetite
  - vomiting
  - yellowing of the skin or the whites of your eyes
  - stomach-area (abdominal) pain
  - dark urine

### What is OMVOH?

OMVOH is a prescription medicine used to treat:

- adults with moderately to severely active ulcerative colitis
- adults with moderately to severely active Crohn's disease

It is not known if OMVOH is safe and effective in children.

### Do not use OMVOH if you:

- are allergic to mirikizumab-mrkz or any of the ingredients in OMVOH. See the end of this Medication Guide for a complete list of ingredients in OMVOH.

### Before you use OMVOH, tell your healthcare provider about all your medical conditions, including if you:

- have any of the conditions or symptoms listed in the section **"What is the most important information I should know about OMVOH?"**
- have recently received or are scheduled to receive any vaccinations. Medicines that affect your immune system may increase your risk of getting an infection after receiving live vaccines.
  - You should be brought up to date with all age required vaccines before starting treatment with OMVOH.
  - You should avoid receiving 'live' vaccines right before, during, or right after treatment with OMVOH. Tell your healthcare provider that you are taking OMVOH before receiving a vaccine.
- are pregnant, or plan to become pregnant. It is not known if OMVOH will harm your unborn baby. There will be a pregnancy registry to collect information about women who are exposed to OMVOH during pregnancy. If you become pregnant while taking OMVOH, you are encouraged to report your pregnancy to Eli Lilly and Company at 1-800-Lilly-Rx (1-800-545-5979).

- are breastfeeding or plan to breastfeed. It is not known if OMVOH passes into your breast milk. Talk to your healthcare provider about the best way to feed your baby while using OMVOH.

**Tell your healthcare provider about all the medicines you take**, including prescription and over-the-counter medicines, vitamins, and herbal supplements.

#### **How should I use OMVOH?**

- Use OMVOH exactly as your healthcare provider tells you to.
- You will receive your first 3 doses of OMVOH through a vein in your arm (intravenous infusion) in a healthcare facility by a healthcare provider every 4 weeks.
  - For ulcerative colitis, each infusion will last about 30 minutes.
  - For Crohn's disease, each infusion will last about 90 minutes.
- After your intravenous infusions, you will continue to receive OMVOH as an injection under the skin (subcutaneous injection) every 4 weeks as described below.
- **See the detailed Instructions for Use that comes with OMVOH for information on how to prepare and inject a dose of OMVOH, and how to properly throw away (dispose of) used OMVOH prefilled pens or prefilled syringes.**
- OMVOH comes as 2 different types of 1-time use devices:
  - a prefilled pen,
  - a prefilled syringe.Your healthcare provider will decide which type of device is best for you.
- For ulcerative colitis, you will need to inject one 200 mg/2 mL prefilled pen or 200 mg/2mL (100 mg/mL) prefilled syringe, or two 100 mg/mL prefilled pens or prefilled syringes for your full dose.
  - If 2 injections are required for your full dose, inject 1 OMVOH prefilled pen or prefilled syringe followed right away by the other OMVOH prefilled pen or prefilled syringe.
- For Crohn's disease, you will need 2 injections either with 2 prefilled pens or 2 prefilled syringes for your full dose.
  - You will need to inject one OMVOH 100 mg/mL prefilled pen or prefilled syringe and one 200 mg/2 mL prefilled pen or 200 mg/2 mL (100 mg/mL) prefilled syringe in any order.
- **Injecting OMVOH under your skin:**
  - OMVOH is intended for use under the guidance and supervision of your healthcare provider. If your healthcare provider decides that you or a caregiver may give your injections of OMVOH at home, you should receive training on the correct way to prepare and inject OMVOH. **Do not** try to inject OMVOH yourself until you or your caregiver have been shown how to inject OMVOH.
  - Inject OMVOH under the skin in your stomach area (abdomen), upper legs (thighs), or back of the upper arms.
  - **Do not** give an injection in an area that is tender, bruised, red, or hard.
  - Use a different injection site each time you use OMVOH.
- If you miss a dose of OMVOH, inject the missed dose as soon as possible. Then take your next dose in 4 weeks. If you have questions about how often you should use OMVOH, talk to your healthcare provider.

#### **What are the possible side effects of OMVOH?**

**OMVOH can cause serious side effects, including:**

- See **"What is the most important information I should know about OMVOH?"**

**The most common side effects of OMVOH in people treated for ulcerative colitis include:**

- upper respiratory infections
- joint pain
- rash
- injection site reactions
- headache
- herpes viral infections

**The most common side effects of OMVOH in people treated for Crohn's disease include:**

- upper respiratory infections
- elevated liver blood tests
- joint pain
- injection site reactions
- headache

Tell your healthcare provider if you have any side effect that bothers you or that does not go away.

These are not all the possible side effects of OMVOH. For more information, ask your healthcare provider or pharmacist.

Call your doctor for medical advice about side effects. You may report side effects to FDA at 1-800-FDA-1088.

#### **How should I store OMVOH?**

- In the original carton, store OMVOH prefilled pens and prefilled syringes in a refrigerator between 36°F to 46°F (2°C to 8°C).
- **Do not** freeze. **Do not** use OMVOH if it has been frozen.
- **Do not** shake.
- Keep OMVOH in the original carton to protect from light until the time of use.
- If needed, your prefilled pens or prefilled syringes may be stored at room temperature for up to 2 weeks in the original carton. **Do not** store above 86°F (30°C).
  - When OMVOH has been stored at room temperature, **do not** return it to the refrigerator.
- **Do not** use and throw away (dispose of) your prefilled pens and prefilled syringes if they:
  - have been frozen.

- have been shaken.
- have not been protected from light in the original carton.
- have been stored at room temperature more than 2 weeks.

**Keep OMVOH and all medicines out of the reach of children.**

**General information about the safe and effective use of OMVOH.**

Medicines are sometimes prescribed for purposes other than those listed in a Medication Guide. Do not use OMVOH for a condition for which it was not prescribed. Do not give OMVOH to other people, even if they have the same symptoms that you have. It may harm them.

You can ask your pharmacist or healthcare provider for information about OMVOH that is written for health professionals.

**What are the ingredients in OMVOH?**

**Active ingredient:** mirikizumab-mrkz.

**Inactive ingredients:**

- **Intravenous infusion:** anhydrous citric acid, polysorbate 80, sodium chloride, sodium citrate, and Water for Injection.
- **Subcutaneous injection for ulcerative colitis and Crohn's disease:** histidine, L-histidine hydrochloride monohydrate, mannitol, polysorbate 80, sodium chloride, and Water for Injection.

OMVOH prefilled pens and prefilled syringes are not made with dry natural rubber latex.

OMVOH™ is a trademark of Eli Lilly and Company.

**Eli Lilly and Company, Indianapolis, IN 46285, USA**

**US License No. 1891**

Copyright © 2023, 2025, Eli Lilly and Company. All rights reserved.

For more information, go to [www.OMVOH.com](http://www.OMVOH.com) or call 1-800-545-5979.

This Medication Guide has been approved by the U.S. Food and Drug Administration.

Revised: 10/2025

A2.0-OMV-0003-MG-YYYYMMDD

**INSTRUCTIONS FOR USE**  
**OMVOH™ (ahm-voh)**  
**(mirikizumab-mrkz)**  
**injection, for subcutaneous use**  
**Prefilled Pens**

**One 200 mg/2 mL Prefilled Pen and one 100 mg/mL Prefilled Pen for a full dose of 300 mg**



*Lilly*

**This Instructions for Use contains information on how to inject OMVOH.**

**Before you use the OMVOH prefilled Pens, read and carefully follow all the step-by-step instructions.**

**Important information you need to know before injecting OMVOH**

- 2 OMVOH injections, using the provided 100 mg/mL and 200 mg/2 mL prefilled Pens, are required for a full 300 mg dose.
  - The prefilled Pens may be used in any order.
  - Inject 1 OMVOH prefilled Pen followed right away by the other OMVOH prefilled Pen.
- 
- Your healthcare provider should show you how to prepare and inject OMVOH using the prefilled Pens. **Do not** inject yourself or someone else until you have been shown how to inject OMVOH.
  - Keep this Instructions for Use and read it as needed.
  - Each OMVOH prefilled Pen is for **one-time use only**.
  - The OMVOH prefilled Pen contains glass parts. Handle it carefully. If you drop it on a hard surface, **do not** use it. Use a new OMVOH prefilled Pen for your injection.
  - Your healthcare provider can help you decide where on your body to inject your dose. Read the **Choose and clean your injection sites** section of these instructions to help you choose which area can work best for you.
  - If you have vision or hearing problems, **do not** use OMVOH prefilled Pens without help from a caregiver.
  - See **Storing OMVOH Prefilled Pens** for important storage information.

## INSTRUCTIONS FOR USE

Before you use the OMVOH prefilled Pens, read and carefully follow all the step-by-step instructions.

---

### 2 Prefilled Pens = full 300 mg dose

After your first injection, **choose** a new injection site at least 2 inches (5 centimeters) away and clean it.

With your second prefilled Pen, **repeat steps 1 to 3** right away after your first injection.

**You must inject 2 prefilled Pens to complete your full 300 mg dose.**

### Parts of the OMVOH Prefilled Pens

Inject both prefilled Pens in any order for a full 300 mg dose.

The 200 mg/2 mL prefilled Pen is larger than the 100 mg/mL prefilled Pen.

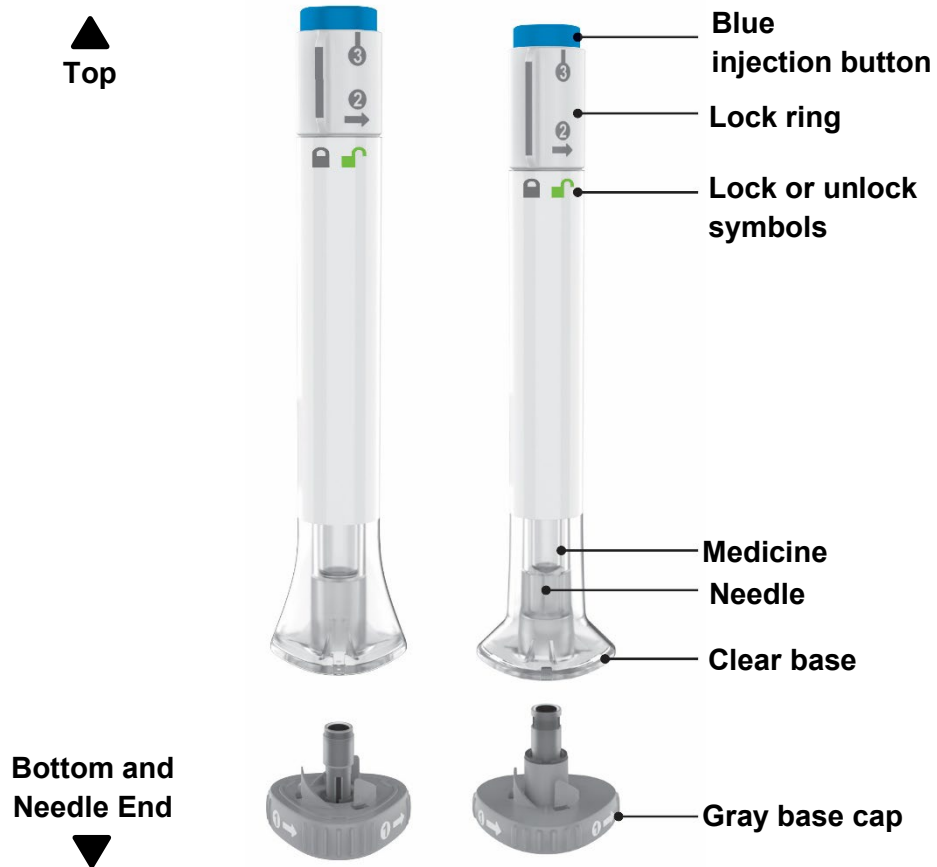

## Preparing to inject OMVOH

### Gather supplies

- a carton containing 2 OMVOH prefilled Pens from the refrigerator
- 2 alcohol wipes
- 2 cotton balls
- sharps disposal container

### Inspect the prefilled Pens and the medicine

Remove both prefilled Pens from the carton.

Make sure you have the right medicine.

The medicine inside should be clear. It may be colorless to slightly yellow to slightly brown.

#### Expiration date

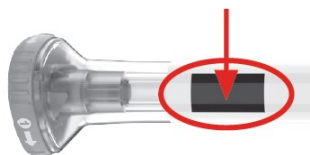

**Do not** use the prefilled Pens (see **Throwing away (disposing of) OMVOH Prefilled Pens**) if:

- one or both prefilled Pens looks damaged
- the medicine is cloudy, discolored, or has particles
- the expiration date printed on the label has passed
- the medicine is or has been frozen.

### Wait 45 minutes

**Do not** warm up the prefilled Pens with a microwave, hot water, or direct sunlight.

With the gray base cap on, allow the prefilled Pens to warm up to room temperature for 45 minutes before injecting.

### Choose and clean your injection sites

Your healthcare provider can help you choose the injection sites that are best for you. **Clean the injection sites with an alcohol wipe and let them dry.**

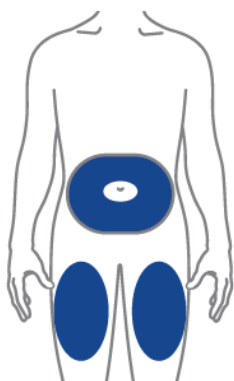

You or another person may inject into these areas.

**Do not** inject into areas where the skin is tender, bruised, red, or hard.

- **Stomach area (abdomen)**  
At least 2 inches away from the belly button (navel).
- **Front of thigh**  
At least 2 inches above the knee and 2 inches below the groin.

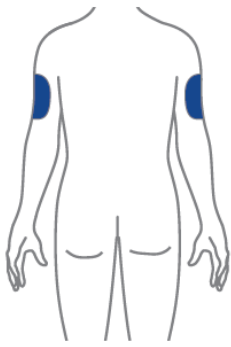

Another person should inject into this area.

- **Back of upper arm**  
Another person should inject into the back of your upper arm.

**Injections should be at least 2 inches apart.**

## Injecting OMVOH

### 1. Uncap the first prefilled Pen (the prefilled Pens may be used in any order)

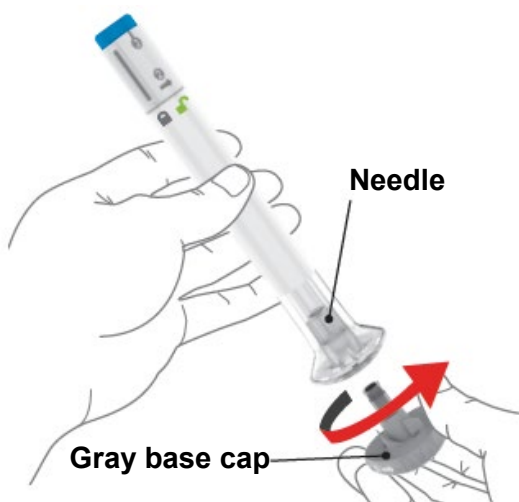

Make sure the prefilled Pen is **locked**.



**Twist off** the gray base cap and **throw the cap away** in the trash when you are ready to inject.

**Do not** put the gray base cap back on – this could damage the needle.

**Do not** touch the needle inside the clear base.

### 2. Place and unlock

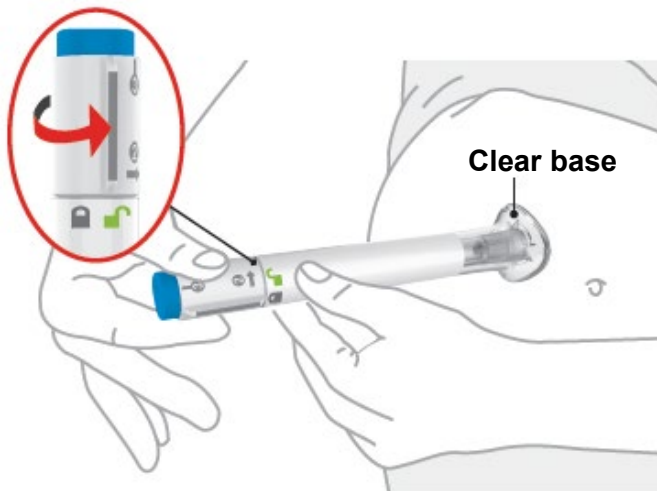

**Place** and hold the clear base flat against the skin.



Keep the clear base on the skin, then turn the lock ring to the **unlock** position.

### 3. Press and hold for 15 seconds

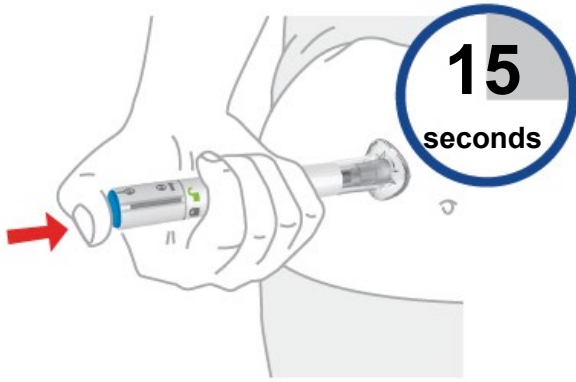

**Press and Hold** the blue injection button and **listen** for 2 loud clicks:

- first click = injection started
- second click = injection completed

The injection may take up to 15 seconds.

You will know the injection is complete when the gray plunger is visible.



Remove the prefilled Pen from the skin.

If you have bleeding at the injection site, press a cotton ball over the injection site.

**Do not** rub the injection site.

### 4. Inject the second prefilled Pen

**Choose** a new injection site at least 2 inches away and clean it.

With your second prefilled Pen, **repeat steps 1 to 3** right away after your first injection.

**You must inject 2 prefilled Pens to complete your full 300 mg dose.**

### Throwing away (disposing of) OMVOH Prefilled Pens

**Throw away both used prefilled Pens**



Put the used OMVOH prefilled Pens in an FDA-cleared sharps disposal container right away after use.

**Do not** throw away (dispose of) the OMVOH prefilled Pens in your household trash.

**Do not** recycle your sharps disposal container.

For more information, see **Used OMVOH prefilled Pen disposal**.

### Storing OMVOH Prefilled Pens

#### Refrigeration

- In the original carton, store your prefilled pens in the refrigerator between 36°F to 46°F (2°C to 8°C) until the expiration date.
- Do not freeze. Do not use OMVOH if it has been frozen.

## Room Temperature

- If needed, your prefilled Pens may be stored at room temperature for up to 2 weeks in the original carton. **Do not** store above 86°F (30°C).
- When OMVOH has been stored at room temperature, do not return it to the refrigerator.
- Throw away (dispose of) OMVOH if not used within 2 weeks at room temperature.
- Protect your prefilled Pens from light until use.

**Do not** use the prefilled Pens and throw away (see **Throwing away (disposing of) OMVOH Prefilled Pens**) if they have been:

- frozen
- microwaved
- warmed with hot water
- left in direct sunlight
- shaken

**Keep OMVOH and all medicines out of the reach of children.**

## Commonly asked questions

**Q. The prefilled Pens are different sizes. Should I take one before the other?**

A. You can inject the prefilled Pens in any order. Inject both prefilled Pens for a full 300 mg dose.

**Q. What if I see air bubbles in the prefilled Pens?**

A. Air bubbles are normal. They will not harm you or affect your dose.

**Q. What if there is a drop of liquid on the tip of the needle when I remove the gray base cap?**

A. A drop of liquid on the tip of the needle is normal. This will not harm you or affect your dose. **Do not** touch the needle.

**Q. What if I unlock the prefilled Pen and press the blue injection button before twisting off the gray base cap?**

A. Do not remove the gray base cap. Throw away (dispose of) the prefilled Pen and get a new one.

**Q. Do I need to hold the blue injection button down until the injection is complete?**

A. You do not need to hold the blue injection button down, but it may help you keep the prefilled Pen steady against your skin.

**Q. What if the needle did not retract after my injection?**

A. **Do not** touch the needle or replace the gray base cap. Store the prefilled Pen in a safe place to avoid an accidental needlestick and contact 1-800-Lilly-Rx (1-800-545-5979) for instructions on how to return the prefilled Pen.

**Q. What if there is a drop of liquid or blood on my skin after my injection?**

A. This is normal. Press a cotton ball over the injection site. **Do not** rub the injection site.

**Q. How can I tell if my injection is complete?**

A. After you press the blue injection button, you will hear 2 loud clicks. The second loud click tells you that your injection is complete. You will also see the gray plunger at the top of the clear base. The injection may take up to 15 seconds.

**Q. What if I remove the prefilled Pen before the second loud click or before the gray plunger stops moving?**

A. You may not have received your full dose. **Do not** give another injection. Call your healthcare provider for help.

**Q. What if I heard more than 2 clicks during my injection – 2 loud clicks and 1 soft one. Did I get my complete injection?**

- A. Some people may hear a soft click right before the second loud click. That is the normal operation of the prefilled Pen. **Do not** remove the prefilled Pen from your skin until you hear the second loud click.

**Additional Information:**

**If you have more questions about how to use the OMVOH prefilled Pens:**

- Call your healthcare provider
- Call 1-800-Lilly-Rx (1-800-545-5979)
- Visit [www.OMVOH.com](http://www.OMVOH.com)



Scan this code to launch  
[www.OMVOH.COM](http://www.OMVOH.COM)

**Used OMVOH Prefilled Pen disposal**

Put the used OMVOH prefilled Pens in an FDA-cleared sharps disposal container right away after use. **Do not** throw away (dispose of) the OMVOH prefilled Pens in your household trash.

If you do not have an FDA-cleared sharps disposal container, you may use a household container that is:

- made of a heavy-duty plastic,
- can be closed with a tight-fitting, puncture-resistant lid, without sharps being able to come out,
- upright and stable during use,
- leak-resistant, and
- properly labeled to warn of hazardous waste inside the container.

When your sharps disposal container is almost full, you will need to follow your community guidelines for the right way to dispose of your sharps disposal container.

There may be state or local laws about how you should throw away needles and syringes.

For more information about safe sharps disposal, and for specific information about sharps disposal in the state you live in, go to the FDA's website at: <http://www.fda.gov/safesharpsdisposal>.

**Do not** recycle your used sharps disposal container.

**Read the Medication Guide for OMVOH inside this box to learn more about your medicine.**

**Manufactured by:**

**Eli Lilly and Company**  
**Indianapolis, IN 46285, USA**  
**US License Number 1891**

OMVOH™ is a trademark of Eli Lilly and Company.

Copyright © 2025, Eli Lilly and Company. All rights reserved.

This Instructions for Use has been approved by the U.S. Food and Drug Administration. Approved: January 2025

The OMVOH prefilled Pen meets the current dose accuracy and functional requirements of ISO 11608-1 and 11608-5.

OMV-0001-300MG-PEN-IFU-20250115

**INSTRUCTIONS FOR USE**  
**OMVOH™ (ahm-voh)**  
**(mirikizumab-mrkz)**  
**injection, for subcutaneous use**  
**Prefilled Syringes**

**One 200 mg/2 mL (100 mg/mL) Prefilled Syringe and One 100 mg/mL Prefilled Syringe for a Full Dose of 300 mg.**



*Lilly*

**This Instructions for Use contains information on how to inject OMVOH.**

**Before you use the OMVOH prefilled Syringes, read and carefully follow all the step-by-step instructions.**

**Important information you need to know before injecting OMVOH**

- 2 OMVOH injections, using the provided 100 mg/mL and 200 mg/2 mL (100 mg/mL) prefilled Syringes, are required for a full 300 mg dose.
  - The prefilled Syringes may be used in any order.
  - Inject 1 OMVOH prefilled Syringe followed right away by the other OMVOH prefilled Syringe.
- 
- Your healthcare provider should show you how to prepare and inject OMVOH using the prefilled Syringes. **Do not** inject yourself or someone else until you have been shown how to inject OMVOH.
  - Keep this Instructions for Use and read it as needed.
  - Each OMVOH prefilled Syringe is for **one-time use only**.
  - Your healthcare provider can help you decide where on your body to inject your dose. Read the **Choose and clean your injection sites** section of these instructions to help you choose which area can work best for you.
  - If you have vision problems, **do not** use OMVOH prefilled Syringes without help from a caregiver.
  - See **Storing OMVOH prefilled Syringes** for important storage information.

## INSTRUCTIONS FOR USE

Before you use the OMVOH prefilled Syringes, read and carefully follow all the step-by-step instructions.

---

### 2 Prefilled Syringes = full 300 mg dose

After your first injection, **choose** a new injection site at least 2 inches away and clean it.

With your second prefilled Syringe, **repeat steps 1 to 3** right away after your first injection.

**You must inject 2 prefilled Syringes to complete your full 300 mg dose.**

### Parts of the OMVOH prefilled Syringes

Inject both prefilled Syringes in any order for a full 300 mg dose.

The 200 mg/2 mL (100 mg/mL) prefilled Syringe is larger than the 100 mg/mL prefilled Syringe.

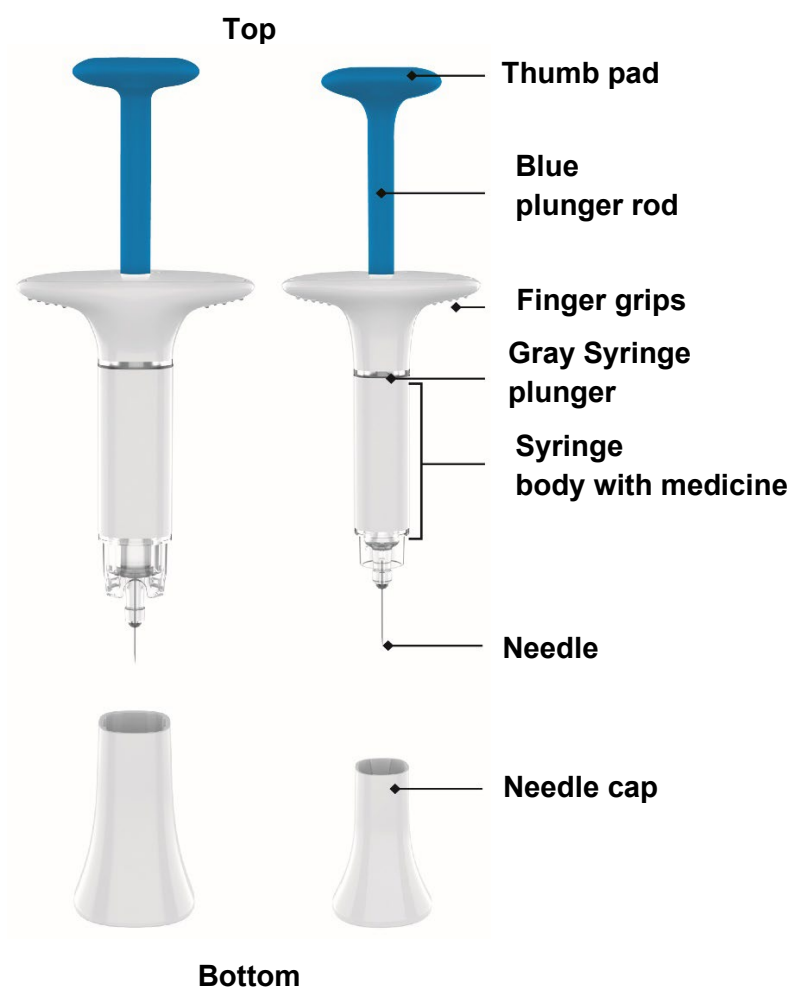

## Preparing to inject OMVOH

### Gather supplies

- a carton containing 2 OMVOH prefilled Syringes from the refrigerator
- 2 alcohol wipes
- 2 cotton balls
- sharps disposal container

### Inspect the prefilled Syringes and the medicine

Remove both prefilled Syringes from the carton.

Make sure you have the right medicine.

The medicine inside should be clear. It may be colorless to slightly yellow to slightly brown.

#### Expiration Date



**Do not** use the prefilled Syringes (see **Throwing away (disposing of) OMVOH Prefilled Syringes**) if:

- one or both prefilled Syringes looks damaged
- the medicine is cloudy, discolored, or has particles
- the expiration date printed on the label has passed
- the medicine is or has been frozen.

### Wait 45 minutes

**Do not** warm up the prefilled Syringes with a microwave, hot water, or direct sunlight.

With the needle cap on, allow the prefilled Syringes to warm up to room temperature for 45 minutes before injecting.

### Choose and clean your injection sites

Your healthcare provider can help you choose the injection sites that are best for you. **Clean the injection sites with an alcohol wipe and let them dry.**

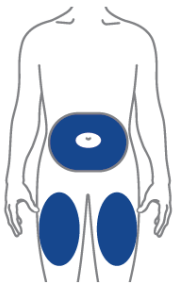

You or another person may inject into these areas.

**Do not** inject into areas where the skin is tender, bruised, red, or hard.

- **Stomach area (abdomen)**  
At least 2 inches away from the belly button (navel).
- **Front of thigh**  
At least 2 inches above the knee and 2 inches below the groin.

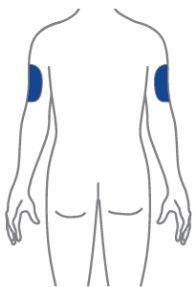

Another person should inject into this area.

- **Back of upper arm**  
Another person should inject into the back of your upper arm.

**Injections should be at least 2 inches apart.**

## Injecting OMVOH

### 1. Uncap the first prefilled Syringe (the prefilled Syringes may be used in any order)

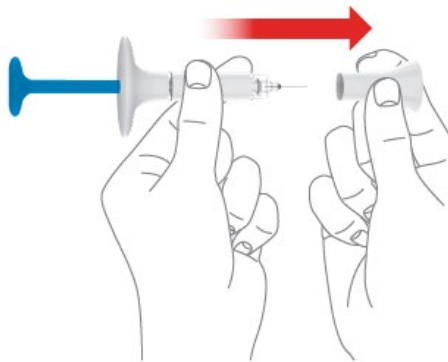

**Hold the prefilled syringe body** and **pull off** the needle cap when you are ready to inject. **Throw away** the needle cap in the trash.

**Do not** put the needle cap back on — this could damage the needle.

**Do not** touch the needle.

### 2. Pinch the injection site and insert the needle

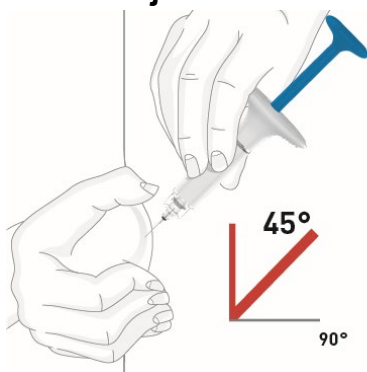

Gently **pinch and hold** a fold of skin where you will inject.

**Insert** the needle at a 45-degree angle.

Gently **let go** of the skin while keeping the needle in place.

### 3. Inject the medicine

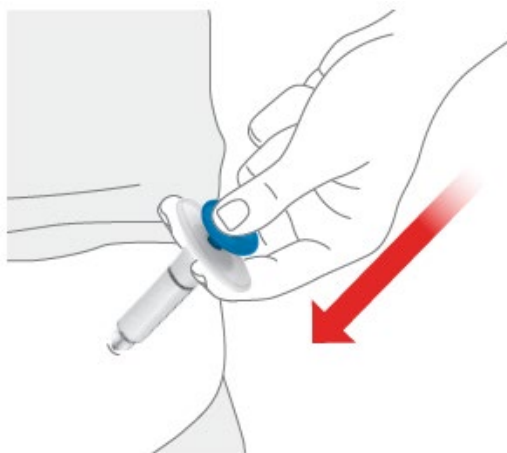

**Slowly push** on the thumb pad to push the blue plunger rod all the way in until all the medicine is injected.

The gray syringe plunger should be pushed all the way to the needle end of the prefilled Syringe.

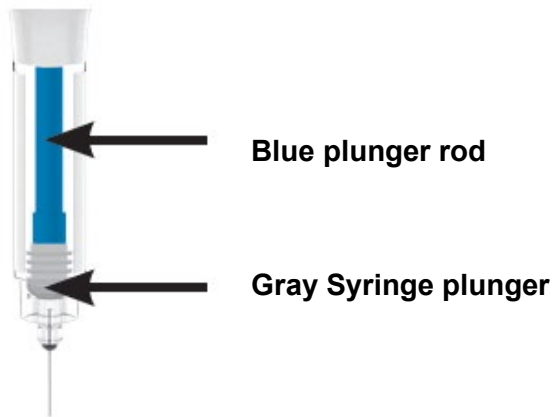

You should see the blue plunger rod show through the prefilled Syringe body when the injection is complete as shown.

Remove the needle from your skin.

**Do not** put the needle cap back on the prefilled Syringe.

If you have bleeding at the injection site, press a cotton ball over the injection site. **Do not** rub the injection site.

#### 4. Inject the second prefilled Syringe

**Choose** a new injection site at least 2 inches away and clean it.

With your second prefilled Syringe, **repeat steps 1 to 3** right away after your first injection.

**You must inject 2 prefilled Syringes to complete your full 300 mg dose.**

### Throwing away (disposing of) OMVOH Prefilled Syringes

#### Throw away both used prefilled Syringes



Put the used OMVOH prefilled Syringes in an FDA-cleared sharps disposal container right away after use.

**Do not** throw away (dispose of) the OMVOH prefilled Syringes in your household trash.

**Do not** recycle your used sharps disposal container.

For more information, see **Used OMVOH prefilled Syringe disposal**.

### Storing OMVOH Prefilled Syringes

#### Refrigeration

- In the original carton, store your prefilled Syringes in the refrigerator between 36°F to 46°F (2°C to 8°C) until the expiration date.
- **Do not** freeze. **Do not** use OMVOH if it has been frozen.

#### Room Temperature

- If needed, your prefilled Syringes may be stored at room temperature for up to 2 weeks in the original carton. **Do not** store above 86°F (30°C).
- When OMVOH has been stored at room temperature, do not return it to the refrigerator.
- Throw away (dispose of) OMVOH if not used within 2 weeks at room temperature.
- Protect your prefilled Syringes from light until use.

**Do not** use the prefilled Syringes and throw away (see **Throwing away (disposing of) OMVOH Prefilled Syringes**) if they have been:

- frozen
- microwaved
- warmed with hot water
- left in direct sunlight
- shaken

**Keep OMVOH and all medicines out of the reach of children.**

## Commonly asked questions

**Q. The prefilled Syringes are different sizes. Should I take one before the other?**

A. You can inject the prefilled Syringes in any order. Inject both prefilled Syringes for a full 300 mg dose.

**Q. What if I see air bubbles in the prefilled Syringes?**

A. Air bubbles are normal. They will not harm you or affect your dose.

**Q. What if there is a drop of liquid on the tip of the needle when I remove the needle cap?**

A. A drop of liquid on the tip of the needle is normal. This will not harm you or affect your dose. **Do not** touch the needle.

**Q. What if I cannot push in the plunger?**

- A. If the plunger is stuck or damaged:
- **Do not** continue to use the prefilled Syringe
  - Remove the needle from your skin
  - Dispose of the prefilled Syringe and get a new one

**Q. What if there is a drop of liquid or blood on my skin after my injection?**

A. This is normal. Press a cotton ball over the injection site. **Do not** rub the injection site.

**Q. How can I tell if my injection is complete?**

- A. When your injection is complete:
- The blue plunger rod should show through the body of the prefilled Syringe.
  - The gray syringe plunger should be pushed all the way to the needle end of the prefilled Syringe.

### Additional Information:

**If you have more questions about how to use the OMVOH prefilled Syringes:**

- Call your healthcare provider
- Call 1-800-Lilly-Rx (1-800-545-5979)
- Visit [www.OMVOH.com](http://www.OMVOH.com)



Scan this code to launch  
[www.OMVOH.COM](http://www.OMVOH.COM)

## Used OMVOH Prefilled Syringe disposal

Put the used OMVOH prefilled Syringes in an FDA-cleared sharps disposal container right away after use. **Do not** throw away (dispose of) the OMVOH prefilled Syringes in your household trash.

If you do not have an FDA-cleared sharps disposal container, you may use a household container that is:

- made of a heavy-duty plastic,
- can be closed with a tight-fitting, puncture-resistant lid, without sharps being able to come out,
- upright and stable during use,
- leak-resistant, and

- properly labeled to warn of hazardous waste inside the container.

When your sharps disposal container is almost full, you will need to follow your community guidelines for the right way to dispose of your sharps disposal container.

There may be state or local laws about how you should throw away needles and syringes.

For more information about safe sharps disposal, and for specific information about sharps disposal in the state you live in, go to the FDA's website at: <http://www.fda.gov/safesharpsdisposal>.

**Do not** recycle your used sharps disposal container.

**Read the Medication Guide for OMVOH inside this box to learn more about your medicine.**

**Manufactured by:  
Eli Lilly and Company  
Indianapolis, IN 46285, USA  
US License Number 1891**

OMVOH™ is a trademark of Eli Lilly and Company.

Copyright © 2025, Eli Lilly and Company. All rights reserved.

This Instructions for Use has been approved by the U.S. Food and Drug Administration.

Approved: January 2025

OMV-0001-300MG-PFS-IFU-20250115

# INSTRUCTIONS FOR USE

OMVOH™ (ahm-voh)  
(mirikizumab-mrkz)

injection, for subcutaneous use

200 mg/2 mL (100 mg/mL) prefilled Syringe



*Lilly*

This Instructions for Use contains information on how to inject OMVOH.

Before you use the OMVOH prefilled Syringe, read and carefully follow all the step-by-step instructions.

## Important information you need to know before injecting OMVOH

- **For injection under the skin (subcutaneous injection) only.**
- Your healthcare provider should show you how to prepare and inject OMVOH using the prefilled Syringe. **Do not** inject yourself or someone else until you have been shown how to inject OMVOH.
- Keep this Instructions for Use and read it as needed.
- The OMVOH prefilled Syringe contains 1 full dose of OMVOH. **The prefilled Syringe is for 1-time use only.**
- The OMVOH prefilled Syringe contains glass parts. Handle it carefully. If you drop it on a hard surface, **do not** use it. Use a new OMVOH prefilled Syringe for your injection.
- Your healthcare provider may help you decide where on your body to inject your dose. You can also read the **Choose and clean your injection site** section of these instructions to help you choose which area can work best for you.
- If you have vision problems, **do not** use OMVOH prefilled Syringe without help from a caregiver.
- See **Storing OMVOH** for important storage information.

# INSTRUCTIONS FOR USE

Before you use the OMVOH prefilled Syringe, read and carefully follow all the step-by-step instructions.

## Parts of the OMVOH prefilled Syringe

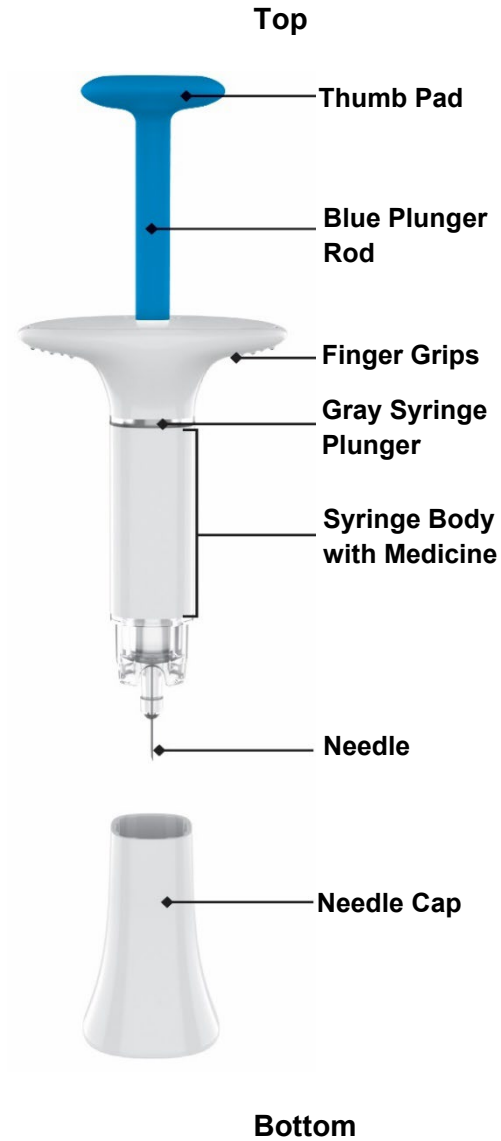

# Preparing to inject OMVOH

## Gather supplies

- OMVOH prefilled Syringe from the refrigerator
- 1 alcohol wipe
- 1 cotton ball or piece of gauze
- 1 sharps disposal container

## Inspect the prefilled Syringe and the medicine

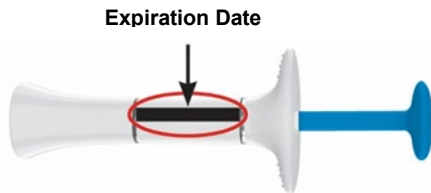

## Remove prefilled Syringe from the carton.

Make sure you have the right medicine. The medicine inside should be clear. It may be colorless to slightly yellow to slightly brown.

## Do not use the prefilled Syringe (see **Throwing away (disposing of) OMVOH prefilled Syringe**) if the:

- prefilled Syringe looks damaged
- medicine is cloudy, discolored, or has particles
- expiration date printed on the label has passed
- medicine has been frozen

## Wait 45 minutes

**Do not** warm up the prefilled Syringe with a microwave, hot water, or direct sunlight.

**With the needle cap on**, allow the prefilled Syringe to warm up to room temperature for 45 minutes before injecting.

## Prepare for injection

### Choose and clean your injection site

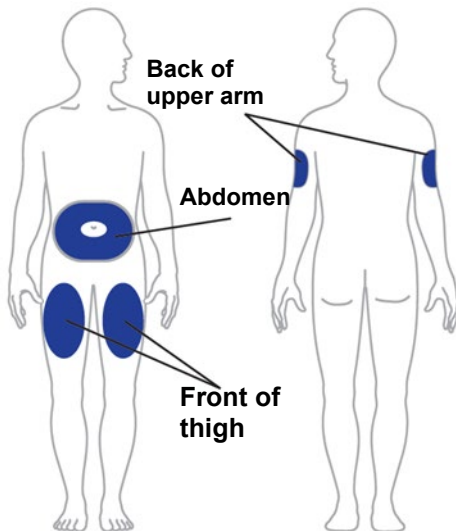

Wash your hands with soap and water before you inject OMVOH.

Your healthcare provider can help you choose the injection site that is best for you.

- **You or another person** may inject the medicine into your stomach area (abdomen). **Do not** inject within 2 inches of the belly button (navel).
- **You or another person** may inject the medicine in the front of your thighs. This area should be at least 2 inches above the knee and 2 inches below the groin.
- **Another person** may give you the injection in the back of your upper arm.
- **Do not** inject in the exact same spot every time.
- **Do not** inject into areas where the skin is tender, bruised, red, or hard.

**Clean the injection site with an alcohol wipe. Let the injection site dry before you inject the medicine.**

# Injecting OMVOH

## 1 Uncap the prefilled Syringe

- **Hold the** prefilled Syringe **body and pull off** the needle cap when you are ready to inject. **Throw away** the needle cap in the household trash.
- **Do not** put the needle cap back on, this could damage the needle.
- **Do not** touch the needle.

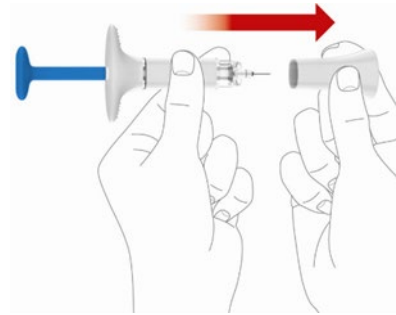

## 2 Pinch the injection site and insert the needle

- Gently **pinch and hold** a fold of skin where you will inject.
- **Insert** the needle at a 45-degree angle.
- Gently **let go** of the skin while keeping the needle in place.

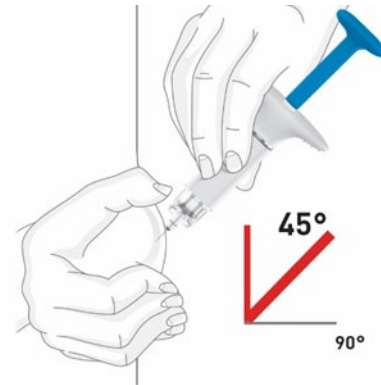

## 3 Inject the medicine

- **Slowly push** on the thumb pad to push the blue plunger rod all the way in until all the medicine is injected.
- The gray Syringe plunger should be pushed all the way to the needle end of the prefilled Syringe.
- You should see the blue plunger rod show through the prefilled Syringe body when the injection is complete as shown.
- Remove the needle from your skin.
- **Do not** put the needle cap back on the prefilled Syringe.

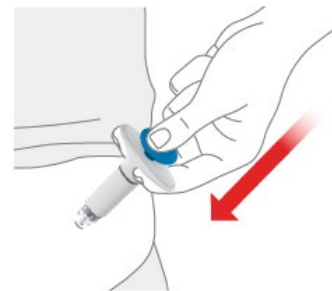

If you have bleeding at the injection site, press a cotton ball or gauze over the injection site. **Do not** rub the injection site, as this may cause bruising.

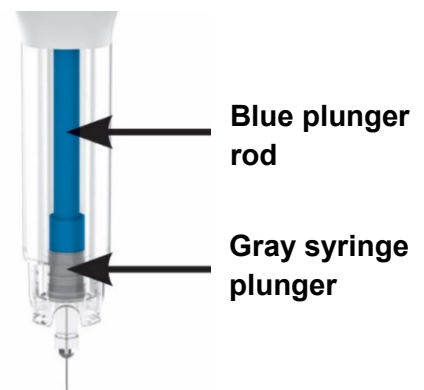

# Throwing away (disposing of) OMVOH prefilled Syringe

## Throw away the used prefilled Syringe

Put the used OMVOH prefilled Syringe in an FDA-cleared sharps disposal container right away after use.

**Do not** throw away (dispose of) the OMVOH prefilled Syringe in the household trash.

For more information, see **Used OMVOH prefilled Syringe disposal**.



## Storing OMVOH

### Refrigeration

- In the original carton, store your prefilled Syringe in the refrigerator between 36°F to 46°F (2°C to 8°C) until the expiration date.
- **Do not** freeze. **Do not** use OMVOH if it has been frozen.

### Room Temperature

- If needed, your prefilled Syringe may be stored at room temperature for up to 2 weeks in the original carton. **Do not** store above 86°F (30°C).
- When OMVOH has been stored at room temperature, do not return it to the refrigerator.
- Throw away (dispose of) OMVOH if not used within 2 weeks at room temperature.
- Protect your prefilled Syringe from light until use.

**Do not** use the prefilled Syringe and throw away (see **Throwing away (disposing of) OMVOH prefilled Syringe**) if it has been:

- frozen
- microwaved
- warmed with hot water
- left in direct sunlight
- shaken

**Keep your prefilled Syringe and all medicines out of the sight and reach of children.**

## Commonly Asked Questions

**Q. What if I see air bubbles in the OMVOH prefilled Syringe?**

**A.** It is normal to have air bubbles in the prefilled Syringe. They will not harm you or affect your dose.

**Q. What if there is a drop of liquid on the tip of the needle when I remove the needle cap?**

**A.** It is okay to see a drop of liquid on the tip of the needle. This will not harm you or affect your dose.

**Q. What if I cannot push in the plunger?**

- A.** If the plunger is stuck or damaged:
- **Do not** continue to use the prefilled Syringe
  - Remove the needle from your skin
  - Throw away (dispose of) the prefilled Syringe and get a new one

**Q. What if there is a drop of liquid or blood on my skin after my injection?**

**A.** This is normal. Press a cotton ball or gauze over the injection site. **Do not** rub the injection site.

**Q. How can I tell if my injection is complete?**

**A.** When your injection is complete:

- The blue plunger rod should show through the body of the prefilled Syringe.
- The gray Syringe plunger should be pushed all the way to the needle end of the prefilled Syringe.

**Q. How many prefilled Syringes do I need to inject in order to get my full dose?**

**A.** For this medicine, one 2 mL prefilled Syringe equals a full dose. If your prescription previously required more injections and you would like to confirm your dose, or you have any questions about your dose, contact your healthcare provider.

**Additional Information:**

**If you have more questions about how to use the OMVOH prefilled Syringe:**

- Call your healthcare provider
- Call 1-800-Lilly-Rx (1-800-545-5979)
- Visit [www.OMVOH.com](http://www.OMVOH.com)



Scan this code to  
launch  
[www.OMVOH.com](http://www.OMVOH.com)

**Used OMVOH prefilled Syringe disposal**

Put the used OMVOH prefilled Syringe in an FDA-cleared sharps disposal container right away after use. **Do not** throw away (dispose of) the OMVOH prefilled Syringe in the household trash.

If you do not have an FDA-cleared sharps disposal container, you may use a household container that is:

- made of a heavy-duty plastic,
- can be closed with a tight-fitting, puncture-resistant lid, without sharps being able to come out,
- upright and stable during use,
- leak-resistant, and
- properly labeled to warn of hazardous waste inside the container.

When your sharps disposal container is almost full, you will need to follow your community guidelines for the right way to dispose of your sharps disposal container.

There may be state or local laws about how you should throw away needles and syringes.

For more information about safe sharps disposal, and for specific information about sharps disposal in the state you live in, go to the FDA's website at: <http://www.fda.gov/safesharpsdisposal>.

**Do not** recycle your used sharps disposal container.

**Read the Medication Guide for OMVOH inside this box to learn more about your medicine.**

**Manufactured by:**  
**Eli Lilly and Company**  
**Indianapolis, IN 46285, USA**  
**US License Number 1891**

OMVOH is a trademark of Eli Lilly and Company.

Copyright © 2025, Eli Lilly and Company. All rights reserved.

This Instructions for Use has been approved by the U.S. Food and Drug Administration.

Approved: October 2025

A3.0-OMV-NL0000-200MG-PFS-IFU-YYYYMMDD

# INSTRUCTIONS FOR USE

OMVOH™ (ahm-voh)

(mirikizumab-mrkz)

injection, for subcutaneous use

200 mg/2 mL prefilled Pen



*Lilly*

This Instructions for Use contains information on how to inject OMVOH.

Before you use the OMVOH prefilled Pen, read and carefully follow all the step-by-step instructions.

## Important information you need to know before injecting OMVOH

- **For injection under the skin (subcutaneous injection) only.**
- Your healthcare provider should show you how to prepare and inject OMVOH using the prefilled Pen. **Do not** inject yourself or someone else until you have been shown how to inject OMVOH.
- Keep this Instructions for Use and read it as needed.
- The OMVOH prefilled Pen contains 1 full dose of OMVOH. **The prefilled Pen is for 1-time use only.**
- The OMVOH prefilled Pen contains glass parts. Handle it carefully. If you drop it on a hard surface, **do not** use it. Use a new OMVOH prefilled Pen for your injection.
- Your healthcare provider may help you decide where on your body to inject your dose. You can also read the **Choose and clean your injection site** section of these instructions to help you choose which area can work best for you.
- If you have vision or hearing problems, **do not** use OMVOH prefilled Pen without help from a caregiver.
- See **Storing OMVOH** for important storage information.

# INSTRUCTIONS FOR USE

Before you use the OMVOH prefilled Pen, read and carefully follow all the step-by-step instructions.

## Parts of the OMVOH prefilled Pen

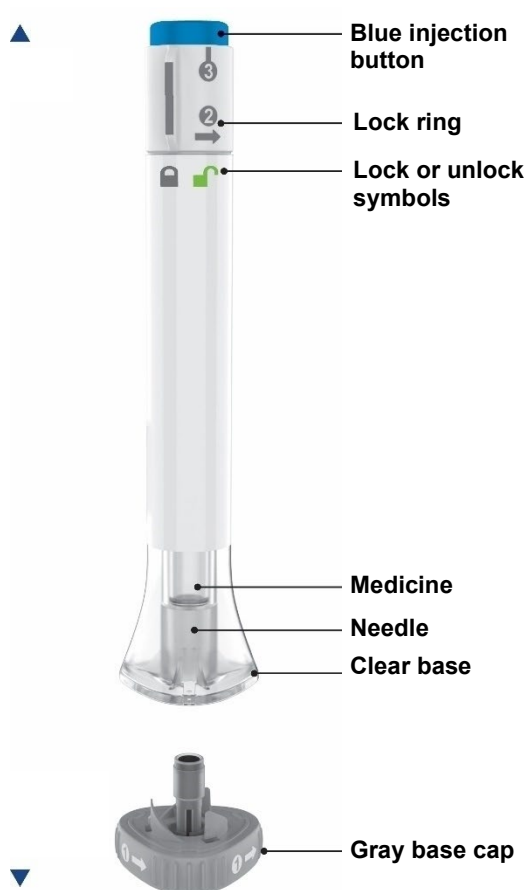

# Preparing to inject OMVOH

## Gather supplies

- OMVOH prefilled Pen from the refrigerator
- 1 alcohol wipe
- 1 cotton ball or piece of gauze
- 1 sharps disposal container

## Inspect the prefilled Pen and the medicine

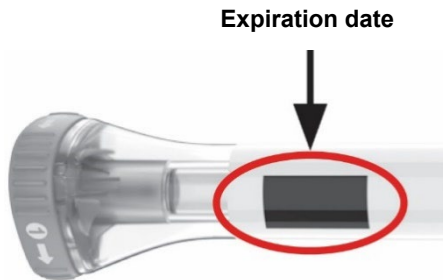

Make sure you have the right medicine. The medicine inside should be clear. It may be colorless to slightly yellow to slightly brown.

### **Do not** use the prefilled Pen (see **Throwing away (disposing of) OMVOH prefilled Pen**) if the:

- prefilled Pen looks damaged
- medicine is cloudy, is discolored, or has particles
- expiration date printed on the label has passed

## Wait 45 minutes

**With the gray base cap on**, allow the prefilled Pen to warm up to room temperature for 45 minutes before injecting.

- **Do not** warm up the prefilled Pen with a microwave, hot water, or direct sunlight.
- **Do not** use the prefilled Pen if the medicine has been frozen.

## Prepare for injection

Wash your hands with soap and water before you inject OMVOH.

## Choose and clean your injection site

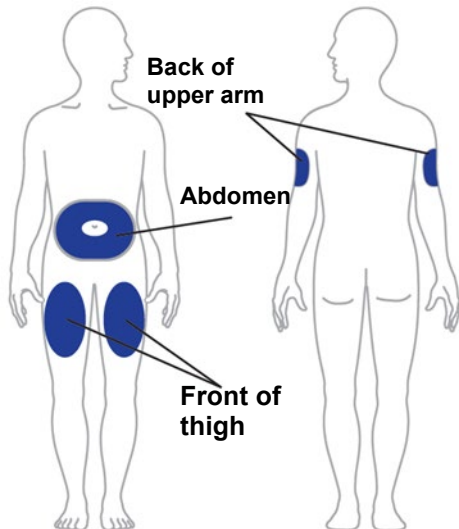

Your healthcare provider can help you choose the injection site that is best for you.

- **You or another person** may inject the medicine into your stomach area (abdomen). **Do not** inject within 2 inches of the belly button (navel).
- **You or another person** may inject the medicine in the front of your thighs. This area should be at least 2 inches above the knee and 2 inches below the groin.
- **Another person** may give you the injection in the back of your upper arm.
- **Do not** inject in the exact same spot every time.
- **Do not** inject into areas where the skin is tender, bruised, red, or hard.

**Clean the injection site with an alcohol wipe. Let the injection site dry before you inject the medicine.**

## Injecting OMVOH

### 1 Uncap the prefilled Pen

 Make sure the prefilled Pen is **locked**.



When you are ready to inject, **twist off** the gray base cap and **throw the cap away** in your household trash.

**Do not** put the gray base cap back on. This could damage the needle.

**Do not** touch the needle inside the clear base.

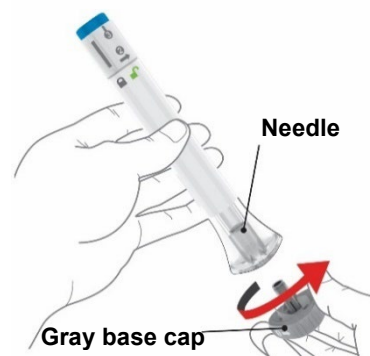

### 2 Place and unlock

**Place** and hold the clear base flat and firmly against the skin.

 Keep the clear base on the skin, then turn the lock ring to the **unlock** position.

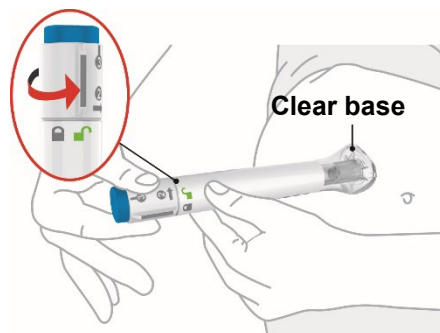

# 3 Press and Hold for 15 Seconds

Press and hold the blue injection button and listen for 2 loud clicks:

- First click: injection started
- Second click: injection completed

The injection may take up to 15 seconds.

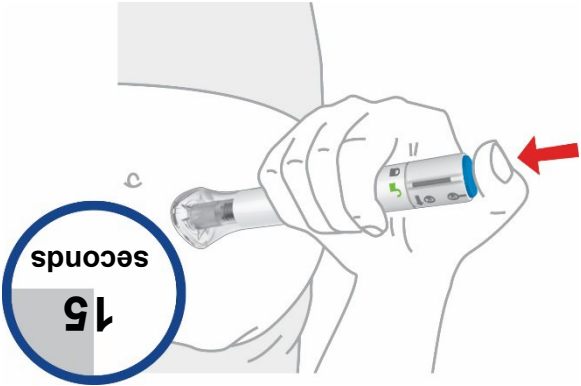

You will know the injection is complete when the gray plunger is visible.

Remove the prefilled Pen from the skin.

If you have bleeding at the injection site, press a cotton ball or gauze over the injection site. **Do not** rub the injection site, as this may cause bruising.



## Throwing away (disposing of) OMVOH prefilled Pen

Throw away the used prefilled Pen

Put the used OMVOH prefilled Pen in an FDA-cleared sharps disposal container right away after use.

**Do not** throw away (dispose of) the OMVOH prefilled Pen in the household trash.

For more information, see **Used OMVOH prefilled Pen disposal**.



## Storing OMVOH

Refrigeration

- In the original carton, store your prefilled Pen in the refrigerator between 36°F to 46°F (2°C to 8°C) until the expiration date.
- **Do not** freeze. **Do not** use OMVOH if it has been frozen.

## Room Temperature

- If needed, your prefilled Pen may be stored at room temperature for up to 2 weeks in the original carton. **Do not** store above 86°F (30°C).
- When OMVOH has been stored at room temperature, do not return it to the refrigerator.
- Throw away (dispose of) OMVOH if not used within 2 weeks at room temperature.
- Protect your prefilled Pen from light until use.

**Do not** use the prefilled Pen and throw away (see **Throwing away (disposing of) OMVOH prefilled Pen**) if it has been:

- frozen
- microwaved
- warmed with hot water
- left in direct sunlight
- shaken

**Keep your prefilled Pen and all medicines out of the sight and reach of children.**

## Commonly Asked Questions

**Q. What if I see bubbles in the prefilled Pen?**

**A.** Air bubbles are normal. They will not harm you or affect your dose.

**Q. What if I unlock the prefilled Pen and press the blue injection button before twisting off the gray base cap?**

**A.** **Do not** remove the gray base cap. Throw away (dispose of) the prefilled Pen and use a new one.

**Q. Do I need to hold the blue injection button down until the injection is complete?**

**A.** You do not need to hold the blue injection button down, but it may help you keep the prefilled Pen steady and firm against your skin.

**Q. What if the needle did not retract after my injection?**

**A.** **Do not** touch the needle or replace the gray base cap. Store the prefilled Pen in a safe place to avoid an accidental needlestick and contact 1-800-Lilly Rx (1-800-545-5979) for instructions on how to return the prefilled Pen.

**Q. What if there is a drop of liquid or blood on my skin after my injection?**

**A.** This is normal. Press a cotton ball or gauze over the injection site. **Do not** rub the injection site.

**Q. How can I tell if my injection is complete?**

**A.** After you press the blue injection button, you will hear 2 loud clicks. The second loud click tells you that your injection is complete. You will also see the gray plunger at the top of the clear base. The injection may take up to 15 seconds.

**Q. What if I remove the prefilled Pen before the second loud click or before the gray plunger stops moving?**

**A.** You may not have received your full dose. **Do not** give another injection. Call your healthcare provider for help.

**Q. What if I hear more than 2 clicks during my injection – 2 loud clicks and 1 soft one. Did I get my complete injection?**

**A.** Some people may hear a soft click right before the second loud click. That is the normal operation of the prefilled Pen. **Do not** remove the prefilled Pen from your skin until you hear the second loud click.

**Q. How many prefilled Pens do I need to inject in order to get my full dose?**

**A.** For this medicine, one 2 mL prefilled Pen equals a full dose. If your prescription previously required more injections and you would like to confirm your dose, or you have any questions about your dose, contact your healthcare provider.

**Additional Information:**

**If you have more questions about how to use the OMVOH prefilled Pen:**

- Call your healthcare provider
- Call 1-800-Lilly-Rx (1-800-545-5979)
- Visit [www.OMVOH.com](http://www.OMVOH.com)



Scan this code to launch  
[www.OMVOH.com](http://www.OMVOH.com)

## Used OMVOH prefilled Pen disposal

Put the used OMVOH prefilled Pen in an FDA-cleared sharps disposal container right away after use. **Do not** throw away (dispose of) the OMVOH prefilled Pen in the household trash.

If you do not have an FDA-cleared sharps disposal container, you may use a household container that is:

- made of a heavy-duty plastic,
- can be closed with a tight-fitting, puncture-resistant lid, without sharps being able to come out,
- upright and stable during use,
- leak-resistant, and
- properly labeled to warn of hazardous waste inside the container.

When your sharps disposal container is almost full, you will need to follow your community guidelines for the right way to dispose of your sharps disposal container.

There may be state or local laws about how you should throw away needles and syringes.

For more information about safe sharps disposal, and for specific information about sharps disposal in the state you live in, go to the FDA's website at <http://www.fda.gov/safesharpsdisposal>.

**Do not** recycle your used sharps disposal container.

**Read the Medication Guide for OMVOH inside this box to learn more about your medicine.**

**Manufactured by:**  
**Eli Lilly and Company**  
**Indianapolis, IN 46285, USA**  
**US License Number 1891**

OMVOH™ is a trademark of Eli Lilly and Company.

Copyright © 2025, Eli Lilly and Company. All rights reserved.

This Instructions for Use has been approved by the U.S. Food and Drug Administration.

Approved: October 2025

The OMVOH prefilled Pen meets the current dose accuracy and functional requirements of ISO 11608-1 and 11608-5.

A3.0-OMV-NL0000-200MG-PEN-IFU-YYYYMMDD

**INSTRUCTIONS FOR USE  
OMVOH™ (ahm-VOH)  
(mirikizumab-mrkz)  
injection, for subcutaneous use  
100 mg/mL prefilled Pens**

This Instructions for Use contains information on how to inject OMVOH.



**Before you use the OMVOH prefilled Pens, read and carefully follow all the step-by-step instructions. Two injections are required for a full dose.**

**Important information you need to know before injecting OMVOH:**

- **For injections under the skin (subcutaneous injection) only.**
- Your healthcare provider should show you how to prepare and inject OMVOH using the prefilled Pen. **Do not** inject yourself or someone else until you have been shown how to inject OMVOH.
- Keep this Instructions for Use and read it as needed.
- **2 OMVOH injections are required for a full dose.**
- **Inject 1 OMVOH prefilled Pen followed right away by the other OMVOH prefilled Pen.**
- Each OMVOH prefilled Pen is for **1-time use only**.
- The OMVOH prefilled Pen contains glass parts. Handle it carefully. If you drop it on a hard surface do not use it. Use a new OMVOH prefilled Pen for your injection.
- Your healthcare provider may help you decide where on your body to inject your dose. You can also read the **Choose your injection site** section of these instructions to help you choose which area can work best for you.
- If you have vision or hearing problems, **do not** use OMVOH prefilled Pen without help from a caregiver.
- See **Storing OMVOH Prefilled Pens** for important storage information.

## INSTRUCTIONS FOR USE

Before you use the OMVOH prefilled Pens, read and carefully follow all the step-by-step instructions.

### Parts of the OMVOH prefilled Pen

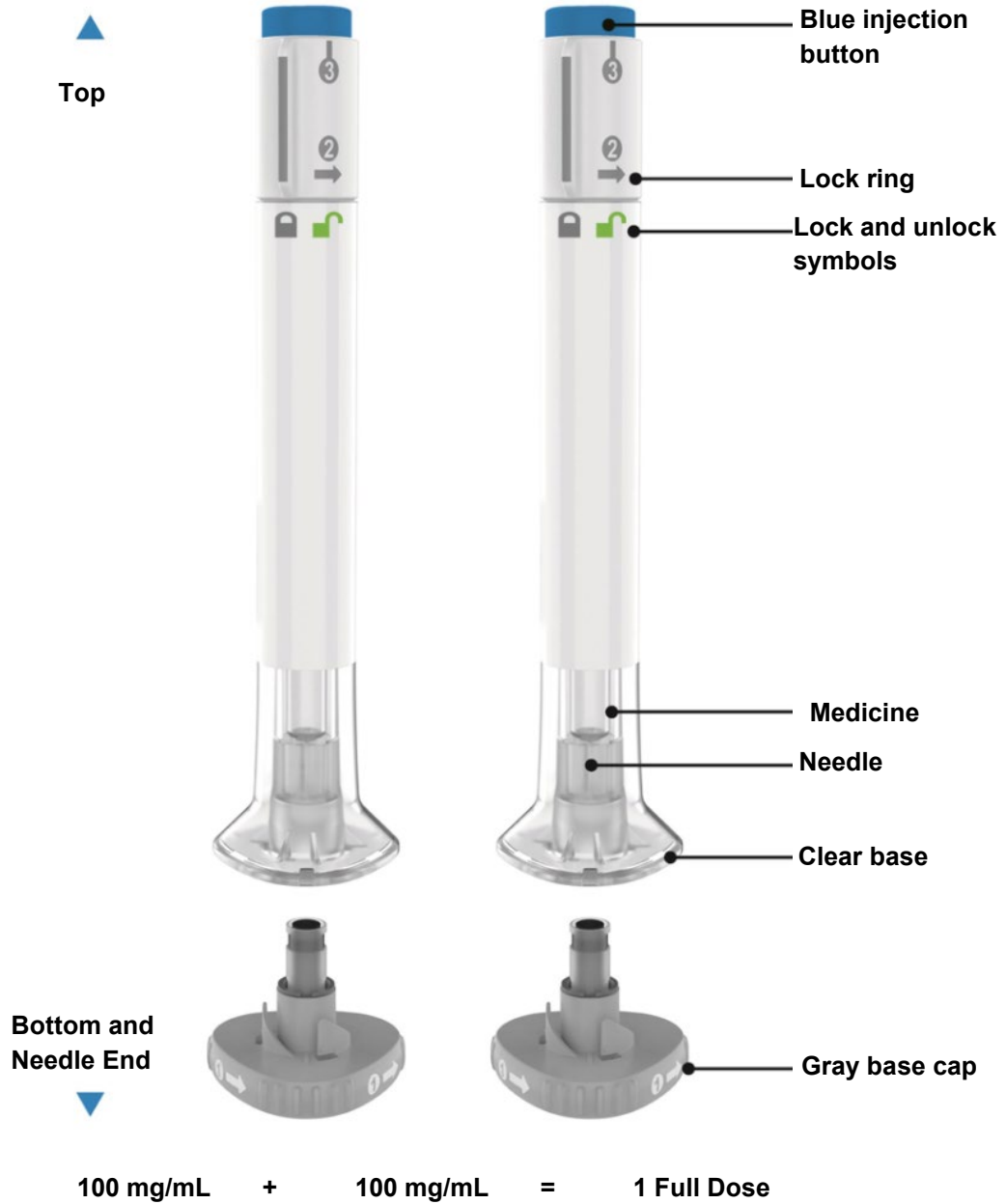

#### Important:

- 2 OMVOH injections are required for a full dose.
- Inject 1 OMVOH prefilled Pen followed right away by the other OMVOH prefilled Pen.

**2 injections are required for a full dose. Inject one prefilled Pen immediately followed by the other prefilled Pen.**

### Preparing to inject OMVOH

**Take the prefilled Pens from the refrigerator**

Take 2 OMVOH prefilled Pens from the refrigerator.

**Leave the gray base caps on until you are ready to inject.**

Leave the prefilled Pens at room temperature for 45 minutes before injecting.

**Do not** microwave the prefilled Pens, or run hot water over them, or leave them in direct sunlight.

**Do not** shake the prefilled Pens.

### Gather supplies

Supplies:

- 2 alcohol wipes
- 2 cotton balls or pieces of gauze
- 1 sharps container (see **Throwing away (disposing of) OMVOH Prefilled Pens**)

**Inspect the prefilled Pens and the medicine**

Make sure you have the right medicine. The medicine inside should be clear. It may be colorless to slightly yellow to slightly brown.

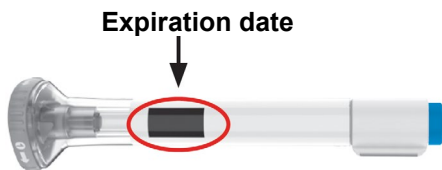

**Do not** use the prefilled Pens and throw away (dispose of) as directed by your healthcare provider or pharmacist if:

- one or both prefilled Pens look damaged
- the medicine is cloudy, is discolored, or has particles
- the expiration date printed on the label has passed
- the medicine is frozen

### Prepare for injection

Wash your hands with soap and water before you inject OMVOH.

### Choose your injection site

Your healthcare provider can help you choose the injection site that is best for you.

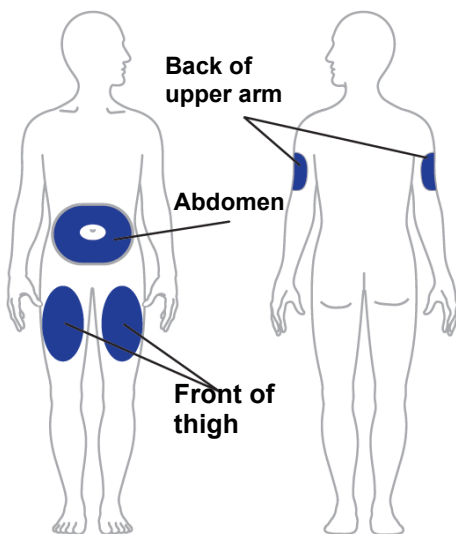

- **You or another person** may inject the medicine into your stomach area (abdomen). **Do not** inject within 2 inches of the belly button (navel).
- **You or another person** may inject the medicine in the front of your thighs. This area should be at least 2 inches above the knee and 2 inches below the groin.
- **Another person** may give you the injection in the back of your upper arm.
- **Do not** inject in the exact same spot every time. For example, if your first injection was in your abdomen, your second injection (to complete a full dose) should be in another spot in your abdomen, or upper arm, or thigh.
- **Do not** inject into areas where the skin is tender, bruised, red, or hard.

**Clean the injection sites with an alcohol wipe. Let the injection sites dry before you inject the medicine.**

## Injecting OMVOH

### 1 Uncap the prefilled Pen

 Make sure the prefilled Pen is **locked**.

Leave the gray base cap on until you are ready to inject.

- Twist off the gray base cap and throw it away in your household trash.
- **Do not** put the gray base cap back on. This could damage the needle.
- **Do not** touch the needle.

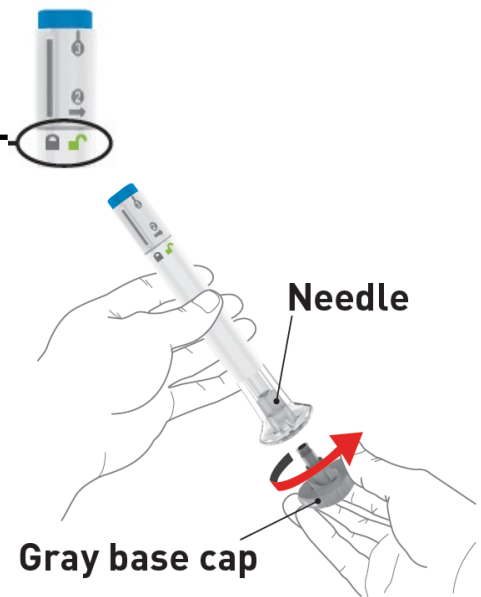

### 2 Place and unlock

- Place and hold the clear base flat and firmly against the skin.

 Keep the clear base on the skin, then turn the lock ring to the **unlock** position.

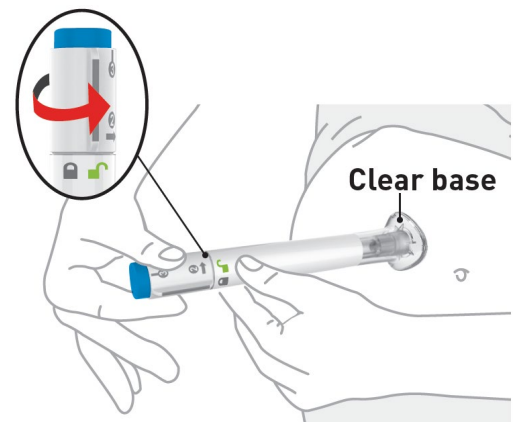

### 3 Press and hold for up to 10 seconds

- Press and hold the blue injection button. You will hear a loud click (injection started).
- **Keep holding the clear base firmly against the skin.** You will hear a second loud click in about 10 seconds after the first one (injection completed).
- You will know the injection is complete when the gray plunger is visible.
- Remove the prefilled Pen from the skin.
- If you have bleeding at the injection site, press a cotton ball or gauze over the injection site.
- **Do not** rub the injection site, as this may cause bruising.

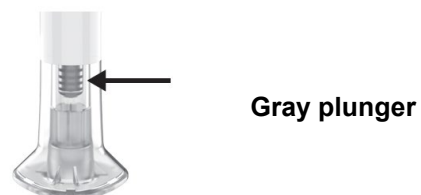
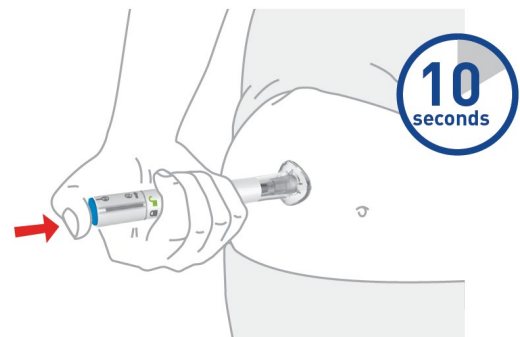

#### 4 Inject the second prefilled Pen

- **Choose** a new injection site at least 2 inches away and clean it.
- With your second prefilled Pen, **repeat steps 1 to 3** right away after your first injection.
- **You must inject 2 prefilled Pens to complete your full 200 mg dose.**

#### Throwing away (disposing of) OMVOH Prefilled Pens

##### Throw away the used prefilled Pens

- Put the used OMVOH prefilled Pens in an FDA-cleared sharps disposal container right away after use. **Do not** throw away (dispose of) the OMVOH prefilled Pens in your household trash.

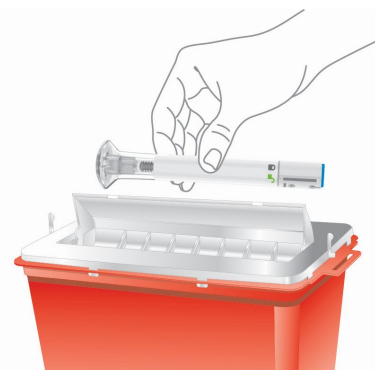

- If you do not have an FDA-cleared sharps disposal container, you may use a household container that is:
  - made of a heavy-duty plastic,
  - can be closed with a tight-fitting, puncture-resistant lid, without sharps being able to come out,
  - upright and stable during use,
  - leak-resistant, and
  - properly labeled to warn of hazardous waste inside the container.
- When your sharps disposal container is almost full, you will need to follow your community guidelines for the right way to dispose of your sharps disposal container. There may be local laws about how you should throw away needles and syringes.
- For more information about safe sharps disposal, and for specific information about sharps disposal in the state you live in, go to the FDA's website at: <http://www.fda.gov/safesharpsdisposal>.
- **Do not** recycle your used sharps disposal container.

#### Commonly asked questions

**Q. What if I let my prefilled Pen warm up for longer than 45 minutes before injecting?**

**A.** Your prefilled Pen can stay at room temperature up to 86°F (30°C) for up to 2 weeks.

**Q. What if I see air bubbles in the prefilled Pen?**

**A.** It is normal to have air bubbles in the prefilled Pen. They will not harm you or affect your dose.

**Q. What if there is a drop of liquid on the tip of the needle when I remove the gray base cap?**

**A.** It is okay to see a drop of liquid on the tip of the needle. This will not harm you or affect your dose.

**Q. What if I unlocked the prefilled Pen and pressed the blue injection button before I twisted off the gray base cap?**

**A.** **Do not** remove the gray base cap. Throw away (dispose of) the prefilled Pen and get a new one.

**Q. Do I need to hold the blue injection button down until the injection is complete?**

**A.** You do not need to hold the blue injection button down, but it may help you keep the prefilled Pen steady and firm against your skin.

**Q. What if the needle did not retract after my injection?**

**A.** **Do not** touch the needle or replace the gray base cap. Store the prefilled Pen in a safe place to avoid an accidental needlestick and contact 1-800-Lilly-Rx (1-800-545-5979) for instructions on how to return the prefilled Pen.

**Q. What if there is a drop of liquid or blood on my skin after my injection?**

**A.** This is normal. Press a cotton ball or gauze over the injection site. **Do not** rub the injection site.

**Q. What if I heard more than 2 clicks during my injection – 2 loud clicks and a soft one. Did I get my complete injection?**

**A.** Some patients may hear a soft click right before the second loud click. That is the normal operation of the prefilled Pen. **Do not** remove the prefilled Pen from your skin until you hear the second loud click.

**Q. How can I tell if my injection is complete?**

**A.** After you press the blue injection button, you will hear 2 loud clicks. The second loud click tells you that your injection is complete. You will also see the gray plunger at the top of the clear base.

**If you have more questions about how to use the OMVOH prefilled Pen:**

- Call your healthcare provider
- Call 1-800-Lilly-Rx (1-800-545-5979)
- Visit [www.OMVOH.com](http://www.OMVOH.com)



Scan this code to launch  
[www.OMVOH.com](http://www.OMVOH.com)

## Storing OMVOH Prefilled Pens

### Refrigeration

- In the original carton, store your prefilled Pens in the refrigerator between 36°F to 46°F (2°C to 8°C) until the expiration date.
- **Do not** freeze. **Do not** use OMVOH if it has been frozen.

### Room temperature

- If needed, your prefilled Pens may be stored at room temperature for up to 2 weeks in the original carton. **Do not** store above 86°F (30°C).
- When OMVOH has been stored at room temperature, do not return it to the refrigerator.
- Throw away (dispose of) OMVOH if not used within 2 weeks at room temperature.
  
- Protect your prefilled Pens from light until use.

**Do not** use the prefilled Pens and throw away (see **Throwing away (disposing of) OMVOH Prefilled Pens**) if they have been:

- Frozen
  - microwaved
  - warmed with hot water
  - left in direct sunlight
  - shaken
- **Keep OMVOH and all medicines out of the reach of children.**

**Read the Medication Guide for OMVOH inside this box to learn more about your medicine.**

This Instructions for Use has been approved by the U.S. Food and Drug Administration.

### Manufactured by:

**Eli Lilly and Company**

**Indianapolis, IN 46285, USA**

**US License Number 1891**

OMVOH™ is a trademark of Eli Lilly and Company.

Copyright © 2023, 2025, Eli Lilly and Company. All rights reserved.

Revised: October 2025

The OMVOH prefilled Pen meets the current dose accuracy and functional requirements of ISO 11608-1 and 11608-5.

A1.0-OMV-NL0004-IFU-PEN-YYYYMMDD

**INSTRUCTIONS FOR USE  
OMVOH™ (ahm-VOH)**

**(mirikizumab-mrkz)**

**injection, for subcutaneous use  
100 mg/mL prefilled syringe**

**This Instructions for Use contains information on how to inject OMVOH.**

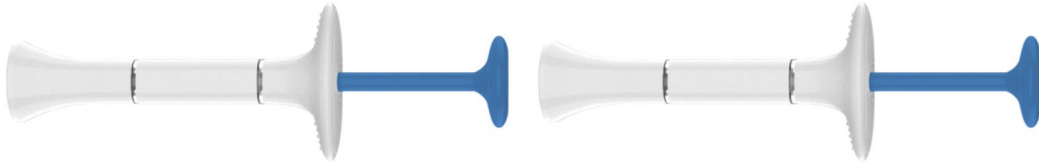

**Before you use the OMVOH prefilled syringes, read and carefully follow all the step-by-step instructions. Two injections are required for a full dose.**

**Important information you need to know before injecting OMVOH:**

- **For injection under the skin (subcutaneous injection) only.**
- Your healthcare provider should show you how to prepare and inject OMVOH using the prefilled syringes. **Do not** inject yourself or someone else until you have been shown how to inject OMVOH.
- Keep this Instructions for Use and read it as needed.
- **2 OMVOH injections are required for a full dose.**
- **Inject 1 OMVOH prefilled syringe followed right away by the other OMVOH prefilled syringe.**
- Each OMVOH prefilled syringe is for **1-time use only**. **Do not** share or reuse your OMVOH prefilled syringe. You may give or get an infection.
- The OMVOH prefilled syringes contain glass parts. Handle it carefully. If you drop it on a hard surface, do not use it. Use a new OMVOH prefilled syringe for your injection.
- Your healthcare provider may help you decide where on your body to inject your dose. You can also read the **Choose your injection site** section of these instructions to help you choose which area can work best for you.
- If you have vision problems, **do not** use OMVOH prefilled syringes without help from a caregiver.
- See **Storing OMVOH prefilled syringes** for important storage information.

## INSTRUCTIONS FOR USE

Before you use OMVOH prefilled syringes, read and carefully follow all the step-by-step instructions.

### Parts of the OMVOH prefilled syringe

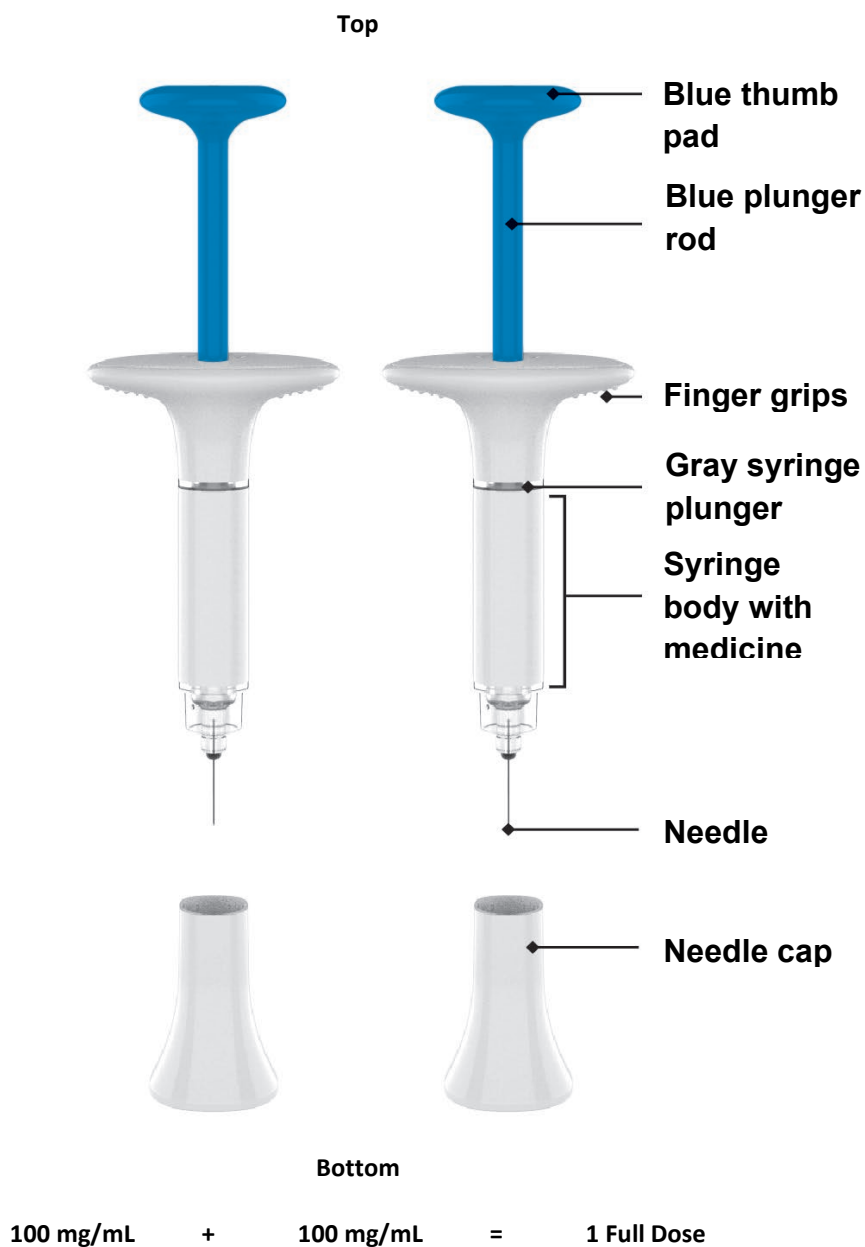

#### Important:

- 2 OMVOH injections are required for a full dose.
- Inject 1 OMVOH prefilled syringe followed right away by the other OMVOH prefilled syringe.

**2 injections are required for a full dose. Inject one prefilled syringe immediately followed by the other prefilled syringe.**

### Preparing to inject OMVOH

**Take the prefilled syringes from the refrigerator**

Take 2 OMVOH prefilled syringes from the refrigerator.

**Leave the needle caps on until you are ready to inject.**

Leave the prefilled syringes at room temperature for 45 minutes before injecting.

**Do not** microwave the prefilled syringes, or run hot water over them, or leave them in direct sunlight.

**Do not** shake the prefilled syringes.

### Gather supplies

Supplies:

- 2 alcohol wipes
- 2 cotton balls or pieces of gauze
- 1 sharps container (see **Throwing away (disposing of) OMVOH prefilled syringes**)

**Inspect the prefilled syringes and the medicine**

Make sure you have the right medicine. The medicine inside should be clear. It may be colorless to slightly yellow to slightly brown.

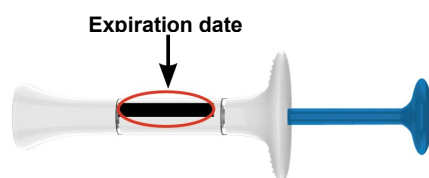

**Do not** use the prefilled syringes and throw away (dispose of) as directed by your healthcare provider or pharmacist if:

- one or both prefilled syringes look damaged
- the medicine is cloudy, is discolored, or has particles
- the expiration date printed on the label has passed
- the medicine is frozen

### Prepare for injection

Wash your hands with soap and water before you inject OMVOH.

**Choose your injection site**

Your healthcare provider can help you choose the injection site that is best for you.

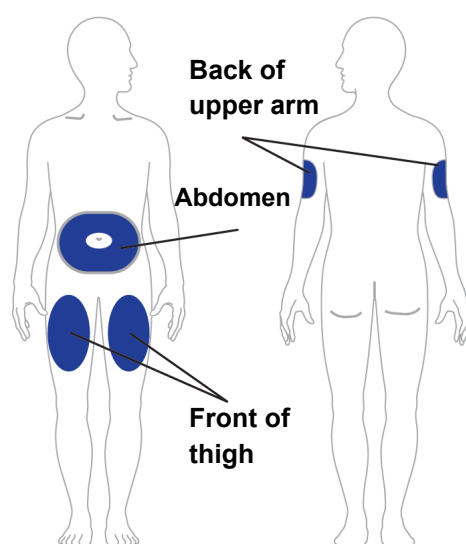

- **You or another person** may inject the medicine into your stomach area (abdomen). **Do not** inject within 2 inches of the belly button (navel).
- **You or another person** may inject the medicine in the front of your thighs. This area should be at least 2 inches above the knee and 2 inches below the groin.
- **Another person** may give you the injection in the back of your upper arm.
- **Do not** inject in the exact same spot every time. For example, if your first injection was in your abdomen, your second injection (to complete a full dose) should be in another spot in your abdomen.
- **Do not** inject into areas where the skin is tender, bruised, red, or hard.

**Clean the injection sites with an alcohol wipe. Let the injection sites dry before you inject the medicine.**

## Injecting OMVOH

### 1 Uncap the prefilled syringe

Leave the needle cap on until you are ready to inject.

- Pull the needle cap off and throw it away in your household trash.
- **Do not** put the needle cap back on. You could damage the needle or stick yourself by accident.
- **Do not** touch the needle.

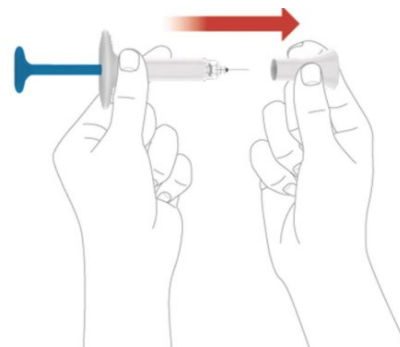

### 2 Insert

- **Gently pinch and hold a fold of skin where you will inject.**
- Insert the needle at a 45-degree angle.

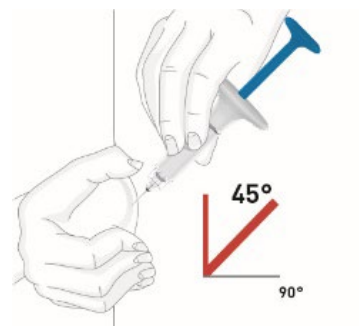

### 3 Inject

- Slowly push on the blue thumb pad to push the plunger all the way in until all the medicine is injected.
- The gray syringe plunger should be pushed all the way to the needle end of the syringe.
- You should see the blue plunger rod show through the syringe body when the injection is complete as shown.
- Remove the needle from your skin and gently let go of your skin.
- If you have bleeding at the injection site, press a cotton ball or gauze over the injection site.
- **Do not** rub the injection site, as this may cause bruising.
- **Do not** put the needle cap back on the prefilled syringe.

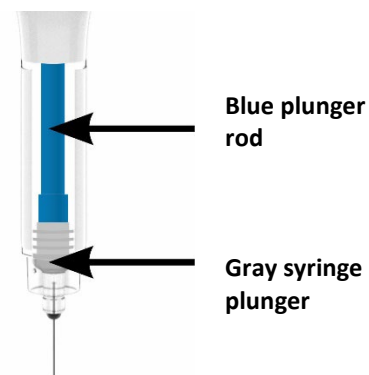
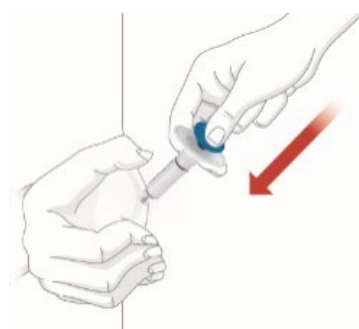

### 4 Inject the second prefilled syringe

- **Choose** a new injection site at least 2 inches away and clean it.
- With your second prefilled syringe, **repeat steps 1 to 3** right away after your first injection
- **You must inject 2 prefilled syringes to complete your full 200 mg dose.**

## Throwing away (disposing of) OMVOH prefilled syringes

### Throw away the used prefilled syringes

- Put the used OMVOH prefilled syringes in an FDA-cleared sharps disposal container right away after use. **Do not** throw away (dispose of) the OMVOH prefilled syringes in your household trash.



- If you do not have an FDA-cleared sharps disposal container, you may use a household container that is:
  - made of a heavy-duty plastic,
  - can be closed with a tight-fitting, puncture-resistant lid, without sharps being able to come out,
  - upright and stable during use,
  - leak-resistant, and
  - properly labeled to warn of hazardous waste inside the container.
- When your sharps disposal container is almost full, you will need to follow your community guidelines for the right way to dispose of your sharps disposal container. There may be state or local laws about how you should throw away needles and syringes.
- For more information about safe sharps disposal, and for specific information about sharps disposal in the state you live in, go to the FDA's website at: <http://www.fda.gov/safesharpsdisposal>.
- **Do not** recycle your used sharps disposal container.

### Commonly asked questions

**Q. What if I let my OMVOH prefilled syringe warm up for longer than 45 minutes before injecting?**

**A.** Your prefilled syringe can stay at room temperature up to 86°F (30°C) for up to 2 weeks.

**Q. What if I see air bubbles in the OMVOH prefilled syringe?**

**A.** It is normal to have air bubbles in the prefilled syringe. They will not harm you or affect your dose.

**Q. What if there is a drop of liquid on the tip of the needle when I remove the needle cap?**

**A.** It is okay to see a drop of liquid on the tip of the needle. This will not harm you or affect your dose.

**Q. What if I cannot push in the plunger?**

**A.** If the plunger is stuck or damaged:

- **Do not** continue to use the prefilled syringe
- Remove the needle from your skin
- Throw away (dispose of) the prefilled syringe and get a new one

**Q. What if there is a drop of liquid or blood on my skin after my injection?**

**A.** This is normal. Press a cotton ball or gauze over the injection site. **Do not** rub the injection site.

**Q. How can I tell if my injection is complete?**

**A.** When your injection is complete:

- The blue plunger rod should show through the body of the syringe.
- The gray syringe plunger should be pushed all the way to the needle end of the syringe.

**If you have more questions about how to use the OMVOH prefilled syringe:**

- Call your healthcare provider
- Call 1-800-LillyRx (1-800-545-5979)
- Visit [www.OMVOH.com](http://www.OMVOH.com)



Scan this code to launch  
[www.OMVOH.com](http://www.OMVOH.com)

**Storing OMVOH prefilled syringes**

- Store your prefilled syringes in the refrigerator between 36°F to 46°F (2°C to 8°C).
- If needed, your prefilled syringes may be stored at room temperature for up to 2 weeks. **Do not** store above 86°F (30°C). Throw away (dispose of) OMVOH if not used within 2 weeks at room temperature. When OMVOH has been stored at room temperature, do not return it to the refrigerator.
- **Do not** freeze your prefilled syringes.
- Store your prefilled syringes in the original carton to protect from light until use.
- **Do not** microwave your prefilled syringes, or run hot water over them, or leave them in direct sunlight.
- **Do not** shake your prefilled syringes.
- Throw away (dispose of) your prefilled syringes if any of the above conditions are not followed.
- **Keep your prefilled syringes and all medicines out of the sight and reach of children.**

**Read the Medication Guide for OMVOH inside this box to learn more about your medicine.**

This Instructions for Use has been approved by the U.S. Food and Drug Administration.

**Manufactured by:  
Eli Lilly and Company  
Indianapolis, IN 46285, USA  
US License Number 1891**

OMVOH™ is a trademark of Eli Lilly and Company.

Copyright © 2024, 2025, Eli Lilly and Company. All rights reserved.

Revised: October 2025

A1.0-OMV-NL0002-IFU-PFS-YYYYMMDD