

HIGHLIGHTS OF PRESCRIBING INFORMATION

These highlights do not include all the information needed to use NEMLUVIO safely and effectively. See full prescribing information for NEMLUVIO.

NEMLUVIO® (nemolizumab-ilto) for injection, for subcutaneous use

Initial U.S. Approval: 2024

INDICATIONS AND USAGE

NEMLUVIO is an interleukin-31 receptor antagonist indicated for the treatment of adults and pediatric patients 12 years of age and older with moderate-to-severe atopic dermatitis in combination with topical corticosteroids and/or calcineurin inhibitors when the disease is not adequately controlled with topical prescription therapies. (1)

DOSAGE AND ADMINISTRATION

- Complete all age-appropriate vaccinations as recommended by current immunization guidelines prior to treatment with NEMLUVIO. (2.1)
- The recommended dosage is an initial dose of 60 mg (two 30 mg injections), followed by 30 mg given every 4 weeks. (2.2)
- After 16 weeks of treatment, for patients who achieve clear or almost clear skin, a dosage of 30 mg every 8 weeks is recommended. (2.2)
- Use NEMLUVIO with topical corticosteroids and/or topical calcineurin inhibitors. When the disease has sufficiently improved, discontinue use of topical therapies. (2.2)
- Administer NEMLUVIO by subcutaneous injection. (2.4)
- NEMLUVIO must be reconstituted prior to administration. (2.5)

DOSAGE FORMS AND STRENGTHS

For injection: single-dose pre-filled dual-chamber pen containing 30 mg of nemolizumab-ilto lyophilized powder and diluent, water for injection. (3)

CONTRAINDICATIONS

Known hypersensitivity to nemolizumab-ilto or to any of the excipients in NEMLUVIO. (4)

WARNINGS AND PRECAUTIONS

- **Hypersensitivity:** Hypersensitivity reactions have been reported with NEMLUVIO use. If a clinically significant hypersensitivity reaction occurs, immediately institute appropriate therapy and discontinue NEMLUVIO. (5.1)
- **Vaccinations:** Avoid use of live vaccines during treatment with NEMLUVIO. (5.2)

ADVERSE REACTIONS

Most common adverse reaction (incidence $\geq 1\%$) headache (including migraine), arthralgia, urticaria, and myalgia. (6.1)

To report SUSPECTED ADVERSE REACTIONS, contact Galderma Laboratories, L.P at 1-866-735-4137 or FDA at 1-800-FDA-1088 or www.fda.gov/medwatch.

See 17 for PATIENT COUNSELING INFORMATION and FDA-approved patient labeling.

Revised: 12/2024

FULL PRESCRIBING INFORMATION: CONTENTS*

1 INDICATIONS AND USAGE

2 DOSAGE AND ADMINISTRATION

- 2.1 Vaccination Prior to Treatment
- 2.2 Recommended Dosage for Atopic Dermatitis
- 2.3 Missed Dose
- 2.4 Important Administration Instructions
- 2.5 Preparation for Use of NEMLUVIO

3 DOSAGE FORMS AND STRENGTHS

4 CONTRAINDICATIONS

5 WARNINGS AND PRECAUTIONS

- 5.1 Hypersensitivity
- 5.2 Vaccinations

6 ADVERSE REACTIONS

- 6.1 Clinical Trials Experience

8 USE IN SPECIFIC POPULATIONS

- 8.1 Pregnancy
- 8.2 Lactation
- 8.4 Pediatric Use
- 8.5 Geriatric Use

10 OVERDOSAGE

11 DESCRIPTION

12 CLINICAL PHARMACOLOGY

- 12.1 Mechanism of Action
- 12.3 Pharmacokinetics
- 12.6 Immunogenicity

13 NONCLINICAL TOXICOLOGY

- 13.1 Carcinogenesis, Mutagenesis, Impairment of Fertility

14 CLINICAL STUDIES

- 14.1 Atopic Dermatitis

16 HOW SUPPLIED/STORAGE AND HANDLING

17 PATIENT COUNSELING INFORMATION

* Sections or subsections omitted from the full prescribing information are not listed.

FULL PRESCRIBING INFORMATION

1 INDICATIONS AND USAGE

NEMLUVIO is indicated for the treatment of adults and pediatric patients 12 years of age and older with moderate-to-severe atopic dermatitis in combination with topical corticosteroids and/or calcineurin inhibitors when the disease is not adequately controlled with topical prescription therapies.

2 DOSAGE AND ADMINISTRATION

2.1 Vaccination Prior to Treatment

Complete all age-appropriate vaccinations as recommended by current immunization guidelines prior to treatment with NEMLUVIO [see *Warnings and Precautions (5.2)*].

2.2 Recommended Dosage for Atopic Dermatitis

The recommended subcutaneous dosage of NEMLUVIO in adults and pediatric patients 12 years of age and older is an initial dose of 60 mg (two 30 mg injections), followed by 30 mg given every 4 weeks.

After 16 weeks of treatment, for patients who achieve clear or almost clear skin, a subcutaneous dosage of 30 mg every 8 weeks is recommended.

Concomitant Topical Therapies:

Use NEMLUVIO with topical corticosteroids and/or topical calcineurin inhibitors. When the disease has sufficiently improved, discontinue use of topical therapies.

2.3 Missed Dose

If a dose is missed, administer the dose as soon as possible. Thereafter, resume dosing at the regular scheduled time.

2.4 Important Administration Instructions

- NEMLUVIO is administered by subcutaneous injection.
- NEMLUVIO is intended for use under the guidance of a healthcare provider. Prior to the first injection, provide patients and/or caregivers with proper training on the preparation and administration of NEMLUVIO. Patients may self-inject NEMLUVIO after receiving training on subcutaneous injection techniques. In pediatric patients 12 years of age and older, administer NEMLUVIO by or under the supervision of a trained adult or caregiver.

- For the initial dose, administer each of the two NEMLUVIO injections at different injection sites.
- Administer subcutaneous injection into the front upper thighs or abdomen except for the 2 inches (5 cm) around the navel. Injection in upper arm should only be performed by a caregiver or healthcare professional.
- Alternate the injection site with each injection. Do not inject NEMLUVIO into skin that is tender, inflamed, swollen, damaged or has bruises or scars or open wounds.
- Refer to the Instructions for Use for complete administration instructions with illustrations [see *Instructions for Use*].

2.5 Preparation for Use of NEMLUVIO

- Before injection, remove NEMLUVIO carton from the refrigerator and allow to reach room temperature (30-45 minutes).
- Inspect NEMLUVIO visually prior to reconstitution. NEMLUVIO is supplied in a single-dose prefilled dual-chamber pen with white powder in one chamber and a clear diluent in the other chamber. Do not use if powder is not white, or if diluent is cloudy or contains visible particles.
- NEMLUVIO must be reconstituted prior to administration.
- Following reconstitution, each prefilled pen delivers 30 mg/0.49 mL as a clear and colorless to slightly yellow solution. Parenteral drug products should be inspected visually for particulate matter and discoloration prior to administration, whenever solution and container permit. Do not use if the reconstituted solution has discoloration or contains particles.
- Use NEMLUVIO pens within 4 hours after reconstitution. Discard unused reconstituted NEMLUVIO pens after 4 hours.
- Discard any unused portions after administration.
- Refer to the Instructions for Use for complete administration instructions with illustrations [see *Instructions for Use*].

3 DOSAGE FORMS AND STRENGTHS

For injection: single-dose prefilled dual-chamber pen containing 30 mg of nemolizumab-ilt as a white lyophilized powder in one chamber and diluent, water for injection, in the other chamber.

4 CONTRAINDICATIONS

NEMLUVIO is contraindicated in patients who have known hypersensitivity to nemolizumab-ilto or to any of the excipients in NEMLUVIO [see *Warnings and Precautions (5.1)*].

5 WARNINGS AND PRECAUTIONS

5.1 Hypersensitivity

Hypersensitivity reactions, such as facial angioedema, have been reported with use of NEMLUVIO. NEMLUVIO is contraindicated in patients with a known hypersensitivity to nemolizumab-ilto or to any of the excipients in NEMLUVIO. If a clinically significant hypersensitivity reaction occurs, immediately institute appropriate therapy and discontinue NEMLUVIO [see *Contraindications (4)*, *Adverse Reactions (6.1)*].

5.2 Vaccinations

Complete all age-appropriate vaccinations as recommended by current immunization guidelines prior to treatment with NEMLUVIO. Avoid use of live vaccines in patients during treatment with NEMLUVIO. It is unknown if administration of live vaccines during NEMLUVIO treatment will impact the safety or effectiveness of these vaccines. No data are available on the response to non-live vaccines.

6 ADVERSE REACTIONS

The following adverse reactions are discussed in greater detail elsewhere in the labeling:

- Hypersensitivity [see *Warnings and Precautions (5.1)*]

6.1 Clinical Trials Experience

Because clinical trials are conducted under widely varying conditions, adverse reaction rates observed in the clinical trials of a drug cannot be directly compared to rates in the clinical trials of another drug and may not reflect the rates observed in practice.

A total of 1148 subjects, including 180 subjects 12 to 17 years of age, with moderate-to-severe atopic dermatitis were treated with NEMLUVIO for at least 1 year during the development program.

The safety of NEMLUVIO was evaluated in a pool of two randomized, double-blind, placebo-controlled, multicenter phase 3 trials (ARCADIA 1, ARCADIA 2). In these two trials, 1135 adult and pediatric subjects 12 years of age and older with moderate-to-severe AD were treated with subcutaneous injections of NEMLUVIO, with concomitant topical corticosteroids (TCS) and/or topical calcineurin inhibitors (TCI) for up to 16 weeks (Initial Treatment Period) [see *Clinical Studies (14)*].

After the Initial Treatment Period, subjects that responded to NEMLUVIO were re-randomized to every 4 weeks, every 8 weeks, or placebo dosing for the Maintenance Treatment Period (Week 16 through Week 48). The safety population during the Maintenance Treatment Period

had a mean age of 31 to 33 years (median age of 26 to 29 years) for the NEMLUVIO cohorts.

Week 0 to Week 16

In ARCADIA 1 and ARCADIA 2 trials through Week 16, the proportion of subjects who discontinued treatment because of adverse events was 2.3% in the NEMLUVIO 30 mg every 4 weeks group and 2.2% in the placebo groups. Table 1 summarizes the adverse reactions that occurred at a rate of at least 1% in the NEMLUVIO group, and for which the rate exceeds the rate in the placebo group during the first 16 weeks of treatment.

Table 1: Adverse Reactions Occurring in $\geq 1\%$ of Adult and Pediatric Subjects 12 Years of Age and Older with Atopic Dermatitis in the NEMLUVIO Group and Greater than Placebo in ARCADIA 1 and ARCADIA 2 Trials through Week 16

Adverse reactions	NEMLUVIO (N = 1135) n (%)	Placebo (N=584) n (%)
Headache (incl. migraine)	52 (5)	22 (4)
Arthralgia	12 (1)	1 (0.2)
Urticaria	12 (1)	2 (0.3)
Myalgia	11 (1)	1 (0.2)

Assessment of the safety profile of NEMLUVIO in 505 subjects up through Week 48 in the ARCADIA 1 and ARCADIA 2 trials was generally consistent with the safety profile observed at Week 16.

Specific Adverse Reactions

Hypersensitivity reactions

Type 1 hypersensitivity reactions (Ig-E mediated reactions) were reported in subjects treated with NEMLUVIO. This included occurrence of mild urticaria that did not lead to discontinuation of treatment.

Injection site reactions

The incidence of injection site reactions during initial period was reported for 1.2% of subjects treated with NEMLUVIO and 0.9% of subjects receiving placebo; during the maintenance period, the incidence was 0.6% with NEMLUVIO every 4 weeks, 0% with NEMLUVIO every 8 weeks, and 0% with placebo. None of these reactions led to discontinuation of treatment.

Herpes Zoster

During the initial treatment period herpes zoster infections were reported in 5 subjects (0.4%) treated with NEMLUVIO (including 1 case of ophthalmic herpes zoster) and no subjects receiving placebo. Cases of herpes zoster were mild to moderate in severity and did not lead to discontinuation of treatment.

Pediatric Subjects 12 Years of Age and Older with Atopic Dermatitis

The safety of NEMLUVIO was assessed in 176 subjects 12 to 17 years of age with moderate-to-severe atopic dermatitis enrolled in the ARCADIA 1 or ARCADIA 2 trials who received at least

one dose of NEMLUVIO from Week 0 to Week 16 in the primary safety population. The safety profile of NEMLUVIO in these subjects through Week 16 was consistent with the safety profile observed in adults with atopic dermatitis.

The safety profile of NEMLUVIO in 98 subjects 12 to 17 years of age followed through Week 48 was consistent with the safety profile observed at Week 16.

8 USE IN SPECIFIC POPULATIONS

8.1 Pregnancy

Risk Summary

Available data on NEMLUVIO use in pregnant women exposed during clinical trials are insufficient to evaluate for a drug-associated risk of major birth defects, miscarriage, or other adverse maternal or fetal outcomes. Transport of human IgG antibody across the placenta increases as pregnancy progresses and peaks during the third trimester; therefore, NEMLUVIO may be transferred from the mother to the developing fetus (*see Clinical Considerations*). In an enhanced pre- and postnatal development study in cynomolgus monkeys, when nemolizumab-ilto was administered subcutaneously during organogenesis to parturition, an increase in early postnatal death was observed at a dose 50 times the maximum recommended human dose (MRHD) (*see Data*). The clinical significance of this nonclinical finding is unknown.

The background risk of major birth defects and miscarriage for the indicated populations are unknown. All pregnancies have a background risk of birth defects, loss, or other adverse outcomes. In the U.S. general population, the estimated background risk of major birth defects and miscarriage in clinically recognized pregnancies is 2% to 4% and 15% to 20%, respectively.

Clinical Considerations

Fetal/Neonatal Adverse Reactions

Transport of endogenous IgG antibodies across the placenta increases as pregnancy progresses, and peaks during the third trimester. It is unclear whether nemolizumab-ilto may interfere with an infant's immune response to infections. Therefore, monitoring for the development of serious infection during the first 3 months of life in infants exposed in utero is recommended.

Data

Animal Data

In an enhanced pre- and postnatal development study, subcutaneous doses up to 25 mg/kg nemolizumab-ilto were administered to pregnant cynomolgus monkeys once every two weeks during organogenesis to parturition. No maternal or embryofetal toxicities were observed at doses up to 25 mg/kg (50 times the MRHD, based on AUC comparison). Early postnatal death occurred in the offspring of one control monkey and 3 monkeys at 25 mg/kg (50 times the MRHD, based on AUC comparison). The clinical significance of this nonclinical finding is unknown. Nemolizumab-ilto was administered subcutaneously to the offspring at doses up to 25 mg/kg (168 times the MRHD, based on AUC comparison), once every 2 weeks for 6 months,

starting from postnatal day 35. No adverse effects were noted in the remaining offspring.

8.2 Lactation

Risk Summary

There are no data on the presence of nemolizumab-ilto in human milk, the effects on the breastfed infant, or the effects on milk production. Nemolizumab-ilto was detected in breast milk of monkeys (*see Data*). Endogenous maternal IgG and monoclonal antibodies are transferred in human milk. The effects of local gastrointestinal exposure and limited systemic exposure in the breastfed infant to nemolizumab-ilto are unknown. The developmental and health benefits of breastfeeding should be considered along with the mother's clinical need for NEMLUVIO and any potential adverse effects on the breastfed child from NEMLUVIO or from the underlying maternal condition.

Data

Nemolizumab-ilto was detected in breast milk of monkeys in the enhanced pre- and postnatal development study following subcutaneous doses up to 25 mg/kg once every two weeks during organogenesis to parturition. The mean nemolizumab-ilto concentrations in milk were approximately 0.3 – 0.5% of the maternal plasma levels from lactation day 7 to 63. The concentration of nemolizumab-ilto in animal milk does not necessarily predict the concentration of drug in human milk.

8.4 Pediatric Use

The safety and effectiveness of NEMLUVIO for the treatment of moderate-to-severe atopic dermatitis in combination with topical corticosteroids and/or calcineurin inhibitors have been established in pediatric patients 12 years of age and older whose disease is not adequately controlled with topical prescription therapies. Use of NEMLUVIO for this indication is supported by evidence from two randomized, double-blind, placebo-controlled trials. The safety and effectiveness were generally consistent between pediatric and adult subjects [*See Adverse Reactions (6.1) and Clinical Studies (14.1)*].

The safety and effectiveness of NEMLUVIO have not been established in pediatric patients younger than 12 years of age.

8.5 Geriatric Use

Of the 1192 subjects with atopic dermatitis exposed to NEMLUVIO in the primary safety population, 72 (6.0%) subjects were 65 years of age or older. The long-term safety of NEMLUVIO was assessed in 78 (4.5%) subjects 65 years of age or older. Clinical studies of NEMLUVIO did not include sufficient numbers of subjects aged 65 and over to determine whether they respond differently from younger adult subjects [*see Clinical Pharmacology (12.3)*].

10 OVERDOSAGE

There is no specific treatment for NEMLUVIO overdose. In the event of overdosage, contact Poison Control (1-800-222-1222) for the latest recommendations and monitor the patient for any signs or symptoms of adverse reactions and institute appropriate symptomatic treatment immediately.

11 DESCRIPTION

Nemolizumab-ilto, an interleukin-31 receptor alpha (IL-31RA) antagonist, is a humanized monoclonal modified immunoglobulin G (IgG) antibody with a molecular weight of approximately 144 kDa. Nemolizumab-ilto is produced by recombinant DNA technology in Chinese Hamster Ovary cells.

NEMLUVIO (nemolizumab-ilto) for injection is a sterile, preservative-free, white lyophilized powder in a dual-chamber single-dose, prefilled pen. One chamber contains 30 mg of nemolizumab-ilto with inactive ingredients arginine hydrochloride (9.5 mg), poloxamer 188 (0.15 mg), sucrose (25.8 mg), trometamol (0.10 mg), and tris hydrochloride for pH adjustment. The diluent, water for injection, is in the other chamber. Following reconstitution, each prefilled pen delivers 30 mg/0.49 mL of nemolizumab-ilto with a pH of 6.7 to 7.3.

12 CLINICAL PHARMACOLOGY

12.1 Mechanism of Action

Nemolizumab-ilto is a humanized IgG2 monoclonal antibody that inhibits IL-31 signaling by binding selectively to IL-31 RA. IL-31 is a naturally occurring cytokine that is involved in pruritus, inflammation, epidermal dysregulation, and fibrosis. Nemolizumab-ilto inhibited IL-31-induced responses including the release of proinflammatory cytokines and chemokines.

12.3 Pharmacokinetics

After a single dose, nemolizumab-ilto exposure increased dose proportionally over a dose range of 0.03 and 3 mg/kg following subcutaneous administration. After multiple doses, nemolizumab-ilto systemic exposure increased in an approximately dose-proportional manner across the subcutaneous dose range up to 30 mg. There was a decrease in bioavailability by 9% with the 60 mg subcutaneous dose and by 15% with the 90 mg subcutaneous dose.

Following multiple doses of NEMLUVIO in subjects with atopic dermatitis, the estimated mean (SD) steady-state trough concentrations of nemolizumab-ilto were 2.63 (1.27) $\mu\text{g/mL}$ for 30 mg administered every 4 weeks and 0.74 (0.44) $\mu\text{g/mL}$ for 30 mg administered every 8 weeks. Steady-state nemolizumab concentrations were achieved 4 weeks after the initial 60 mg loading dose.

Absorption

Following an initial subcutaneous dose of 60 mg, nemolizumab-ilto reached peak mean (SD) concentrations (C_{max}) of 7.5 (2.31) $\mu\text{g/mL}$ by approximately 6 days post dose.

Distribution

The volume of distribution of nemolizumab-ilto was estimated to be 7.67 L.

Elimination

Nemolizumab-ilto is expected to be degraded in the same manner as endogenous IgG. The terminal elimination half-life (SD) of nemolizumab-ilto was estimated to be 18.9 (4.96) days and systemic clearance was estimated to be 0.263 L/day.

Metabolism

The metabolic pathway of nemolizumab-ilto has not been characterized. Nemolizumab-ilto is expected to be degraded into small peptides by catabolic pathways.

Specific Populations

Geriatric Populations

No clinically significant difference in the pharmacokinetics of nemolizumab-ilto was estimated based on age (subjects 18 to 65 years of age and older than 65 years of age). Dose adjustment in this population is not needed.

Pediatric Populations

No clinically significant difference in the pharmacokinetics of nemolizumab-ilto was estimated in pediatric subjects 12 to 17 years of age compared to adults. Dose adjustment in this population is not needed.

Renal or Hepatic Impairment

No clinically significant differences in the pharmacokinetics of nemolizumab-ilto were estimated based on mild to moderate renal or hepatic impairments. The effect of severe renal and severe hepatic impairments on the pharmacokinetics of nemolizumab-ilto is unknown.

Body Weight

The exposure of nemolizumab-ilto decreases with increasing body weight. With the recommended dose, the steady state mean exposure parameters (AUC_{ss} , C_{maxss} and C_{trough}) of subjects with body weight of above 87 kg is expected to be 1.7-fold lower than that of subjects weighing below 62 kg.

The difference in systemic exposure due to body weight had no clinically meaningful impact on efficacy in subjects with atopic dermatitis. Dose adjustment based on body weight is not needed.

Drug Interaction Studies

The effects of nemolizumab on the pharmacokinetics of midazolam (CYP3A4/5 substrate), warfarin (CYP2C9 substrate), omeprazole (CYP2C19 substrate), metoprolol (CYP2D6 substrate), and caffeine (CYP1A2 substrate) were evaluated in a study in 14 subjects with

moderate to severe AD receiving an initial SC dose of 60 mg followed by 30 mg SC every four weeks for 12 weeks. No clinically significant changes in the exposure of CYP450 substrates before and after multiple nemolizumab injections were observed, with C_{max} and AUC ratios ranging from 88.2 to 107.8%. The concomitant use of nemolizumab-ilto is unlikely to influence the PK profiles of CYP substrates.

12.6 Immunogenicity

The observed incidence of anti-drug antibodies is highly dependent on the sensitivity and specificity of the assay. Differences in assay methods preclude meaningful comparisons of the incidence of anti-drug antibodies in the trials described below with the incidence of anti-drug antibodies in other trials, including those of nemolizumab-ilto or other nemolizumab products.

In the phase 3 trials (ARCADIA 1, ARCADIA 2) up to 16 weeks, the incidence of treatment-emergent ADAs was 5.6% (33/593) and 6.8% (34/499), respectively. Among subjects who continued treatment from week 16 through week 48 in the two studies, the ADA incidence was 11.2% (10/89) and 16.9% (13/77) for those received 30 mg every 4 weeks, and 12.8% (11/86) and 8% (6/75) for those received 30 mg every 8 weeks. Neutralizing antibody incidence was 6% (2/33) and 2.9% (1/34) among the ADA+ subjects throughout 48 weeks in ARCADIA 1 and ARCADIA 2, respectively.

Antibodies to nemolizumab-ilto were associated with reduced serum nemolizumab-ilto concentrations beyond Week 16. In the phase 3 trials, NEMLUVIO treated subjects who developed ADAs had nemolizumab-ilto concentrations that were 20% to 70% lower compared to subjects who did not develop ADAs. There was no clinically significant effect of anti-drug antibodies on safety or efficacy of nemolizumab-ilto over the treatment duration of 48 weeks.

13 NONCLINICAL TOXICOLOGY

13.1 Carcinogenesis, Mutagenesis, Impairment of Fertility

Animal studies have not been conducted to evaluate the carcinogenic or mutagenic potential of NEMLUVIO.

No effects on fertility parameters as reproductive organ morphology, menstrual cycle length, or sperm/testicular analysis were observed in male or female sexually mature cynomolgus monkeys that were administered nemolizumab-ilto at subcutaneous doses up to 25 mg/kg once every two weeks for 6 months (72 times the MRHD, based on AUC comparison). The monkeys were not mated to evaluate fertility.

14 CLINICAL STUDIES

14.1 Atopic Dermatitis

Two randomized, double-blind, placebo-controlled trials (ARCADIA 1 [NCT03985943] and

ARCADIA 2 [NCT03989349]) enrolled a total of 1728 subjects 12 years of age and older with moderate-to-severe atopic dermatitis not adequately controlled by topical treatments. Disease severity was defined by an Investigator's Global Assessment (IGA) score of 3 (moderate) and 4 (severe) in the overall assessment of atopic dermatitis, an Eczema Area and Severity Index (EASI) score of ≥ 16 , a minimum body surface area (BSA) involvement of $\geq 10\%$, and a Peak Pruritus Numeric Rating Scale (PP-NRS) score of ≥ 4 .

Subjects in the NEMLUVIO group received initial subcutaneous injections of NEMLUVIO 60 mg, followed by 30 mg injections every 4 weeks. Concomitant low and/or medium potency TCS and/or TCI were administered for at least 14 days prior to baseline and continued during the trial. Based on disease activity, these concomitant therapies could be tapered and/or discontinued at investigator discretion.

After 16 weeks, subjects achieving either EASI-75 or IGA success continued into the trial maintenance period for another 32 weeks to evaluate the maintenance of response achieved at Week 16. NEMLUVIO responders were re-randomized to either NEMLUVIO 30 mg every 4 weeks, NEMLUVIO 30 mg every 8 weeks, or placebo every 4 weeks (all groups continued background TCS/TCI). Subjects randomized to placebo in the initial treatment period who achieved the same clinical response at Week 16 continued to receive placebo every 4 weeks.

In these trials, at baseline, 51% of subjects were male, 80% were White, 13% were Asian, and 6% were Black or African American; for ethnicity, 9% of subjects identified as Hispanic or Latino. Fifteen (15)% of subjects were 12-17 years of age. Seventy (70)% of subjects had a baseline IGA score of 3 (moderate AD), and 30% of subjects had a baseline IGA score of 4 (severe AD). The baseline mean EASI score was 27.5 and the baseline mean weekly average PP-NRS was 7.1. Overall, 63% of subjects received other previous systemic treatments for AD.

The IGA is a 5-category scale, including "0 = clear", "1 = almost clear", "2 = mild", "3 = moderate" or "4 = severe" indicating the investigator's overall assessment of the AD. EASI scores range from 0 to 72 points and reflect the severity and extent of AD. EASI-75 indicates at least a 75% improvement in EASI score from baseline. The PP-NRS score is a weekly average of daily PP NRS scores on an 11-point scale from 0-10 that assesses the maximal intensity of pruritus in the last 24 hours with 0 being no itch and 10 being worst itch imaginable.

Both ARCADIA 1 and ARCADIA 2 assessed the co-primary endpoints of:

- Proportion of subjects with an IGA success (defined as an IGA of 0 [clear] or 1 [almost clear] and a ≥ 2 -point reduction from baseline) at Week 16
- Proportion of subjects with EASI-75 ($\geq 75\%$ improvement in EASI from baseline) at Week 16

PP-NRS improvement ≥ 4 from baseline at Week 16 was a key secondary outcome in both trials.

Clinical Response at Week 16 (ARCADIA 1 and ARCADIA 2)

The efficacy results for ARCADIA 1 and ARCADIA 2 evaluating the initial treatment period with NEMLUVIO over 16 weeks are presented in Table 2.

Table 2: Efficacy Results of NEMLUVIO (30 mg Every 4 Weeks) with Concomitant TCS/TCI at Week 16 in Adult and Pediatric Subjects 12 Years of Age and Older with Moderate to Severe AD in ARCADIA 1 and ARCADIA 2

	ARCADIA 1			ARCADIA 2		
	NEMLUVIO + TCS/TCI	Placebo + TCS/TCI	Difference from Placebo (95% CI)	NEMLUVIO + TCS/TCI	Placebo + TCS/TCI	Difference from Placebo (95% CI)
Number of subjects randomized	620	321		522	265	
Proportion of subjects with IGA 0 or 1 ^a	36%	25%	12% (6%, 17%)	38%	26%	12% (6%, 19%)
Proportion of subjects with EASI-75 ^a	44%	29%	15% (9%, 21%)	42%	30%	12% (6%, 19%)
Proportion of subjects with an improvement (reduction) of ≥ 4 from baseline in PP-NRS ^a	33%	15%	18% (13%, 23%)	36%	15%	21% (15%, 27%)

^a Subjects who received rescue treatment or had missing data (fewer than 4 PP-NRS daily diary entries in a 7-day period) were considered non-responders.

Examination of weight, age, gender, race, and prior treatment did not identify meaningful difference in response to NEMLUVIO among these subgroups at Week 16.

Maintenance and Durability of Response (Week 16 to Week 48)

The clinical response in NEMLUVIO responders (IGA 0/1 or EASI-75 at Week 16) was evaluated between Week 16 and Week 48 in ARCADIA 1 and ARCADIA 2 trials. For the maintenance treatment period, NEMLUVIO responders were re-randomized to NEMLUVIO 30 mg every 4 weeks, NEMLUVIO 30 mg every 8 weeks or placebo every 4 weeks (NEMLUVIO withdrawal) with concomitant TCS/TCI. The results are presented in Table 3.

Table 3: Efficacy Results of NEMLUVIO with Concomitant TCS/TCI at Week 48 in Adult and Pediatric Subjects 12 Years of Age and Older with Moderate to Severe AD in ARCADIA 1 and ARCADIA 2

	NEMLUVIO Every 4 Weeks + TCS/TCI	NEMLUVIO Every 8 Weeks + TCS/TCI	Placebo + TCS/TCI
Number of subjects who were IGA Responders^a at Week 16	142	142	131
Proportion of subjects with IGA 0 or 1 ^b at Week 48	63%	64%	55%
Number of subjects who were EASI-75 Responders at Week 16	163	163	157
Proportion of subjects with EASI-75 ^b at Week 48	75%	77%	65%

^a Responder was defined as a subject with an IGA of 0 (clear) or 1 (almost clear) and a ≥ 2 -point reduction from baseline.

^b Subjects who received rescue treatment or with missing data were considered non-responders.

16 HOW SUPPLIED/STORAGE AND HANDLING

How Supplied

NEMLUVIO (nemolizumab-ilto) for injection is a sterile, preservative-free, white lyophilized powder available in single-dose, dual-chamber prefilled pen containing 30 mg of nemolizumab-ilto in one chamber and the diluent, water for injection, in the other chamber. Following reconstitution, each prefilled pen delivers 30 mg/0.49 mL of nemolizumab-ilto.

Each carton contains 1 single-dose prefilled pen.

Presentation	Pack size	NDC #
Pre-filled Pen	Pack of 1 pen	0299-6220-15

Storage and Handling

Store the NEMLUVIO dual chamber prefilled pen in a refrigerator at 36°F to 46°F (2°C to 8°C) in the original carton to protect from light until the expiration date. Do not freeze. Do NOT expose to heat or direct sunlight.

Alternatively, the NEMLUVIO carton containing the unused dual chamber prefilled pen may be stored at room temperature [up to 77°F (25°C)] for up to 90 days. Write the date the NEMLUVIO dual chamber prefilled pen is first removed from the refrigerator in the space provided on the inner partition for the pen. Do not use the NEMLUVIO dual chamber prefilled pen beyond the expiration date or 90 days after the date it was first removed from the refrigerator (whichever is earlier).

17 PATIENT COUNSELING INFORMATION

Advise the patient to read the FDA-approved patient labeling (Patient Information and Instructions for Use).

Hypersensitivity

Advise patients to seek immediate medical attention and discontinue NEMLUVIO if they experience any symptoms of hypersensitivity reactions [see *Warnings and Precautions (5.1)*].

Vaccinations

Instruct patients to inform their healthcare provider that they are taking NEMLUVIO prior to a potential vaccination [see *Warnings and Precautions (5.2)*].

Administration Instructions:

- Instruct patients and/or caregivers to receive proper training in subcutaneous injection technique prior to self-injection [see *Dosage and Administration (2.4)*]. Inform patients and/or caregivers that Galderma Customer Support may be called for assistance at 1-866-735-4137.
- Inform patients that NEMLUVIO must be reconstituted prior to administration. Advise patients/caregivers to refer to the Instructions for Use that accompany the NEMLUVIO pen

for complete mixing and administration instructions with illustrations [*see Dosage and Administration (2.4, 2.5), Instructions for Use*].

- Inform patients and/or caregivers of proper pen disposal and caution against any reuse of needles. Instruct patients and/or caregivers to discard used pens in an appropriate sharps disposal container following safe needle disposal practices [*see Instructions for Use*].
- Advise patients and/or caregivers of the importance of complying with dosing schedule. If a dose is missed, instruct patients/caregivers to administer the injection as soon as possible, and thereafter, resume dosing at the regular scheduled time. [*see Dosage and Administration (2.3)*].

Manufactured by:

Galderma Laboratories, L.P., Dallas, TX 75201

U.S. License No. 2289

NEMLUVIO® is a trademark of Galderma.

© 2024 Galderma Laboratories, L.P. All rights reserved.

PATIENT INFORMATION
NEMLUVIO® [Nem LOO vee oh]
(nemolizumab-ilto)
for injection, for subcutaneous use

What is NEMLUVIO?

- NEMLUVIO is a prescription medicine used to treat adults and children 12 years of age and older with moderate-to-severe eczema (atopic dermatitis) that is not well controlled with prescription therapies used on the skin (topical). NEMLUVIO can be used with certain prescription topical medicines. It is not known if NEMLUVIO is safe and effective in children under 12 years of age.

Do not use NEMLUVIO if you are allergic to nemolizumab-ilto or to any ingredients in NEMLUVIO. See the end of this Patient Information leaflet for a complete list of ingredients in NEMLUVIO.

Before taking NEMLUVIO, tell your healthcare provider about all of your medical conditions, including if you:

- are scheduled to receive any vaccination. You should not receive a live vaccine right before or during treatment with NEMLUVIO.
- are pregnant or plan to become pregnant. It is not known whether NEMLUVIO will harm your unborn baby.
- are breastfeeding or plan to breastfeed. It is not known whether NEMLUVIO passes into your breast milk and if it can harm your baby.

Tell your healthcare provider about all of the medicines you take, including prescription and over-the-counter medicines, vitamins, and herbal supplements.

How should I take NEMLUVIO?

- **See the detailed Instructions for Use that comes with NEMLUVIO for information on how to prepare and inject NEMLUVIO and how to properly store and throw away (dispose of) used NEMLUVIO prefilled pens.**
- Use NEMLUVIO exactly as prescribed by your healthcare provider.
- Use NEMLUVIO with prescription topical therapies. When your eczema has improved, your healthcare provider may stop topical therapies.
- Your healthcare provider will tell you how much NEMLUVIO to inject and how often to inject it.
- NEMLUVIO comes as a single-dose pre-filled pen with a needle guard.
- NEMLUVIO is given as an injection under the skin (subcutaneous injection).
- If your healthcare provider decides that you or your caregiver can give the injections of NEMLUVIO, you or your caregiver should receive training on the right way to prepare and inject NEMLUVIO. **Do not** try to inject NEMLUVIO until you have been shown the right way by your healthcare provider.
- If you miss a dose, inject the missed dose as soon as possible, then continue with your next dose at your regular scheduled time.
- If you inject too much NEMLUVIO, call your healthcare provider or the Poison Help line at 1-800-222-1222 or go to the nearest hospital emergency room right away.
- Your healthcare provider may prescribe other medicines to use with NEMLUVIO. Use the other prescribed medicines exactly as your healthcare provider tells you to.

What should I avoid while taking NEMLUVIO?

You should not receive live vaccines while taking NEMLUVIO.

What are the possible side effects of NEMLUVIO?

NEMLUVIO may cause serious side effects including:

- **allergic reactions (hypersensitivity).** NEMLUVIO can cause allergic reactions that can sometimes be serious. Stop using NEMLUVIO and tell your healthcare provider or get emergency help right away if you get any of the following symptoms:
 - breathing problems
 - swelling of the face, lips, mouth, tongue, or throat
 - fainting, dizziness, feeling lightheaded

- fast pulse
- fever
- general ill feeling
- swollen lymph nodes
- skin rash (red or rough skin)
- joint pain
- nausea or vomiting
- cramps in your stomach area

The most common side effects of NEMLUVIO include:

- headache
- joint pain
- hives (itchy red rash or wheals)
- muscle aches

These are not all of the possible side effects of NEMLUVIO.

Call your doctor for medical advice about side effects. You may report side effects to FDA at 1-800-FDA-1088.

How should I store NEMLUVIO?

- Store the NEMLUVIO pen in the refrigerator between 36°F to 46°F (2°C to 8°C) until the expiration date.
- Store the NEMLUVIO pen in the original carton to protect it from light.
- The NEMLUVIO pen can be stored at room temperature (up to 77°F or 25°C) for a single period up to 90 days. Throw away (dispose of) the NEMLUVIO pen after the expiration date and any NEMLUVIO pen that has been left at room temperature longer than 90 days.
- After the NEMLUVIO pen lyophilized powder and water for injection are mixed (reconstituted), the NEMLUVIO pen must be used within 4 hours or thrown away (discarded).
- **Do not** heat or put the NEMLUVIO pen in direct sunlight.
- **Do not** freeze the NEMLUVIO pen.
- If the NEMLUVIO pen was heated or frozen, throw it away (dispose of it).

Keep the NEMLUVIO pen and all medicines out of the reach of children.

General information about the safe and effective use of NEMLUVIO.

Medicines are sometimes prescribed for purposes other than those listed in a Patient Information leaflet. Do not use NEMLUVIO for a condition for which it was not prescribed. Do not give NEMLUVIO to other people, even if they have the same symptoms that you have. It may harm them. You can ask your pharmacist or healthcare provider for information about NEMLUVIO that is written for healthcare professionals.

What are the ingredients in NEMLUVIO?

Active ingredients: nemolizumab-ilto

Inactive ingredients: arginine hydrochloride, poloxamer 188, sucrose, trometamol, and tris hydrochloride

Manufactured by: Galderma Laboratories, L.P., Dallas, TX 75201
U.S License No. 2289
NEMLUVIO® is a trademark of Galderma.
©2024 Galderma Laboratories, L.P. All rights reserved.

This Patient Information has been approved by the U.S. Food and Drug Administration.

Issued: 12/2024

INSTRUCTIONS FOR USE
NEMLUVIO® [Nem LOO vee oh]
(nemolizumab-ilto)
for injection, for subcutaneous use

This Instructions for Use contains information on how to inject NEMLUVIO.

Read and understand these instructions before using the NEMLUVIO pen.

Do not inject yourself or someone else until you have been instructed how to inject NEMLUVIO.

In adolescents (ages 12 to 17 years old), it is recommended that NEMLUVIO be given by or under supervision of a trained adult or caregiver.

Your healthcare provider will instruct you or your caregiver how to prepare and inject a dose of NEMLUVIO before you try to do it yourself the first time. Call your healthcare provider if you have any questions.

NEMLUVIO is supplied as a single-dose pen (called NEMLUVIO pen or pen in these instructions). It contains medicine (30 mg of lyophilized powder) in one chamber and water for dissolving the medicine in the other chamber. Before you can inject it, you must mix the lyophilized powder with the water for dissolving the medicine.

Device Overview

NEMLUVIO Single-Dose Pre-Filled Dual-Chamber Pen

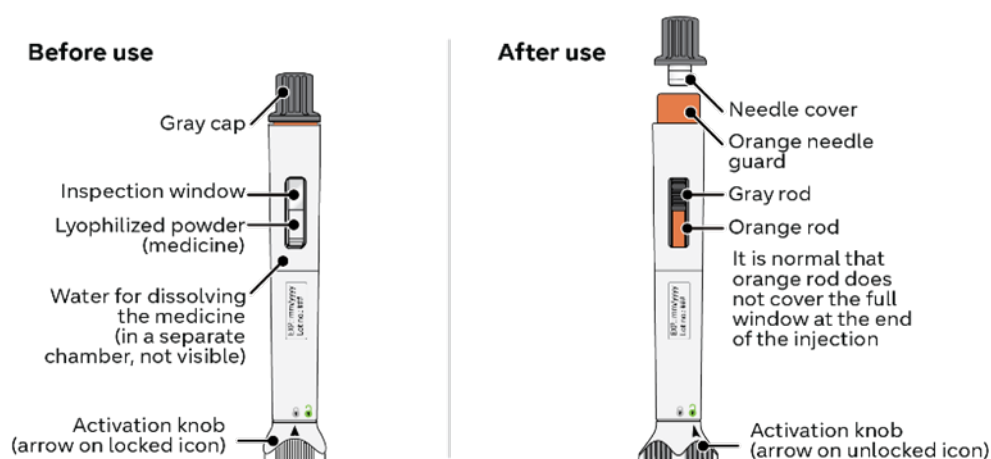

Important Information

What you need to know before using the NEMLUVIO pen:

- Read all the instructions carefully before using the NEMLUVIO pen.
- **Mark your calendar** ahead of time to remember when to take NEMLUVIO.
- Follow all steps exactly as described. This makes sure that you get the correct dose of medicine.
- Make sure that the lyophilized powder is completely dissolved before injecting (Step 9).
- After dissolving, proceed right away with the injection to avoid any contamination or break down of medicine (degradation).
- **Do not** use the NEMLUVIO pen if it has been dropped on a hard surface or is damaged, cracked or broken.
- In some cases, your healthcare provider may prescribe 2 pens for a full dose. Use 1 NEMLUVIO pen after the other.
- To reduce the risk of accidental needle stick injury, each NEMLUVIO pen has an orange needle guard. After injecting the medicine, as you lift the pen from your skin, the orange needle guard locks into place to cover the needle (Step 16).
- When preparing the pen for injection, **do not** pull the gray cap. Instead, twist the gray cap until the orange needle guard pops up. Then, gently pull the cap off the orange needle guard (Step 12).
- Throw away (dispose of) the used NEMLUVIO pen right away after use in a sharps disposal container. See Section C: Throwing away (Disposing of) NEMLUVIO below.

Storage Information

- Store the NEMLUVIO pen in the refrigerator between 36°F to 46°F (2°C to 8°C) until the expiration date.
- Store the NEMLUVIO pen in the original carton to protect it from light.
- The NEMLUVIO pen can be stored at room temperature up to 77°F (25°C) for a single period up to 90 days. Throw away (dispose of) the NEMLUVIO pen after the expiration date and any NEMLUVIO pen that has been left at room temperature longer than 90 days.
- After the NEMLUVIO pen lyophilized powder and water for injection are mixed (reconstituted), the NEMLUVIO pen must be used within 4 hours or thrown away (discarded).
- **Do not** heat or put the NEMLUVIO pen into direct sunlight.
- **Do not** freeze the NEMLUVIO pen.
- If the NEMLUVIO pen was heated or frozen, throw it away (dispose of it).

Keep the NEMLUVIO pen and all medicines out of the reach of children.

Traveling Information:

- Generally, you are allowed to carry pens with you on an airplane. Be sure to carry the NEMLUVIO pens with you in your carry-on luggage.

If you have any other questions refer to the Frequently asked questions (FAQs) on the back of this leaflet.

A. Preparing to inject NEMLUVIO

Step 1: Let NEMLUVIO reach room temperature

Injecting cold medicine might result in pain at the injection site. Take the **NEMLUVIO** carton out of the refrigerator and let it come to room temperature for 30 to 45 minutes before starting Step 2 (see **Figure A**).

Do not:

- warm the pen with any heat source (such as microwave or direct sunlight). This might damage NEMLUVIO.
- directly expose the pen to liquids.

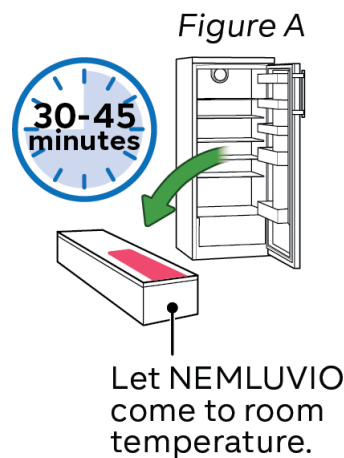

Step 2: Wash your hands

- To avoid contamination and infection, wash your hands with soap (see **Figure B**).
- Dry them properly.

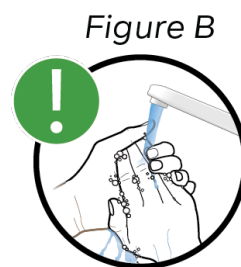

Step 3: Gather supplies (see Figure C)

- Remove the pen from the carton.
- Gather the following supplies on a clean, flat and well-lit surface:

- Pen
- Alcohol wipes*
- Sharps disposal container*
- Gauze pads or cotton balls*

*Items not included in the carton.

Note: In some cases, your healthcare provider may prescribe 2 pens. Use 1 pen after the other.

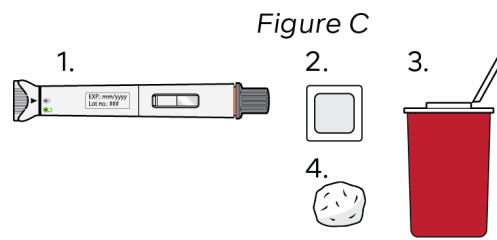

Step 4: Check the NEMLUVIO pen for the following:

- Expiration date has **not** passed.
- The lyophilized powder is white and **not** dissolved (see Figure D).
- The pen has **not** been dropped and is not damaged or cracked.

Do not use the pen unless all conditions above are met.

If any condition is **not** met, call: **1-866-735-4137**.

Throw away (dispose of) the pen and use a new one (see Section C: Throwing away (Disposing of) NEMLUVIO).

Figure D

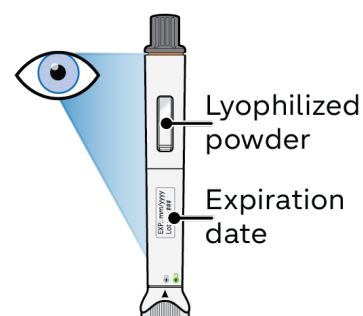

Step 5: Activate the NEMLUVIO pen

Hold the pen upright and turn the activation knob to the right until it stops (see Figure E).

This starts the process of transferring water to the powder chamber.

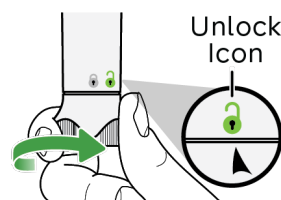
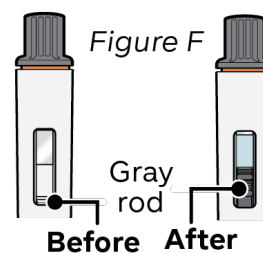

Figure E

Step 6: Wait until the gray rod stops moving

Watch the inspection window until the gray rod has stopped moving (see Figure F).

Do not shake the pen. Shaking the pen before the gray rod has completely stopped can affect the medicine dose.



Step 7: Dissolve the medicine

When the gray rod has completely stopped, shake the pen up and down for 30 seconds (see Figure G).

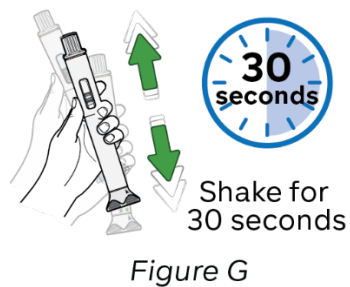

Step 8: Wait 5 minutes for bubbles to decrease

Wait for bubbles to decrease and the lyophilized powder to dissolve completely. This will take about 5 minutes (see Figure H).

Note: If the medicine has not dissolved completely, shake the pen up and down again for 30 seconds and then wait 5 minutes.

Note: It is normal for a small foam layer or a few small air bubbles to remain in the dissolved medicine.

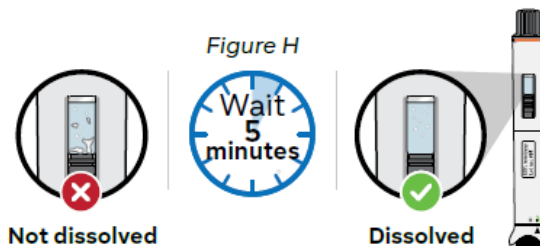

Step 9: Check the medicine in the inspection window

Check to see if the dissolved medicine:

- is clear and colorless to slightly yellow,
- does not contain particles (see Figure i).

Do not use the pen if the dissolved medicine is cloudy or contains any particles.

Throw away (dispose of) the pen and use a new one (see Section C: Throwing away (Disposing of) NEMLUVIO).

Note: After the medicine has dissolved, it must be used within 4 hours. During this time, it should be kept at room temperature (up to 77°F (25°C)). If you have not used it within 4 hours, throw it away (dispose of it).

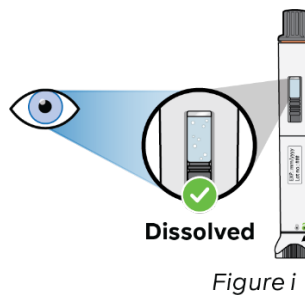

B. Injecting NEMLUVIO

Step 10: Select one injection site (see Figure J)

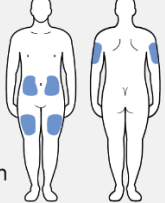
<p>Note: When using a second pen, select a different injection site at least 1 inch away from the first injection site.</p>	<p>Self-Injection ●</p> <ul style="list-style-type: none">• Abdomen 2 inches away from navel• Upper thigh 	<p>Figure J</p>
<p>Select the injection site using the following chart:</p> <p>Where not to inject:</p> <ul style="list-style-type: none">• near your waistline or about 2 inches around the navel.• into tender, bruised, red skin, or areas with scars or stretch marks.• twice into the same site (for example, within 1 inch).	<p>Injection by Caregiver ●</p> <ul style="list-style-type: none">• Abdomen 2 inches away from navel• Upper thigh• Outer, upper arm 	

Step 11: Clean the injection site (see Figure K)

<p>a. Always use a new alcohol wipe to clean the injection site. This avoids contamination and infection.</p> <p>b. Let the skin air dry.</p> <p>Do not:</p> <ul style="list-style-type: none">• touch the injection site after cleaning.• fan or blow air on the cleaned injection site.• reuse the alcohol wipe.	 <p>Figure K</p> <p>Alcohol Wipe</p>
--	---

Step 12: Twist the gray cap

Do not:

- pull the gray cap when twisting to avoid damaging the device.
- touch the orange needle guard.

- a. **Hold** the pen **upright** (see Figure L, a).
- b. Twist the gray cap until the orange needle guard pops up (see Figure L, b).
- c. Gently pull the cap off the orange needle guard (see Figure L, c).
- d. After cap removal, please throw away (dispose of) the cap in a sharps disposal container (see Step 17).

Note: If the cap cannot be removed, refer back to **Step 5** and make sure the activation knob is turned completely to the right until it stops.

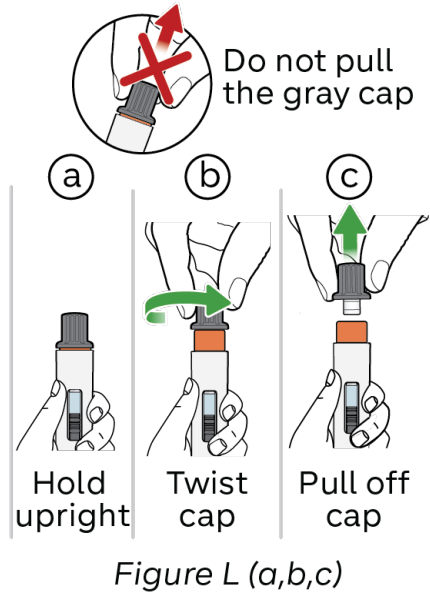

Step 13: Place the NEMLUVIO pen

Read Steps 13-16 before starting Step 13.

Note: Always inject the way your healthcare provider showed you.

Place the pen on the injection site vertically so that the orange needle guard is flat against the skin (see Figure M).

Note: Make sure you can easily see the inspection window during injection.

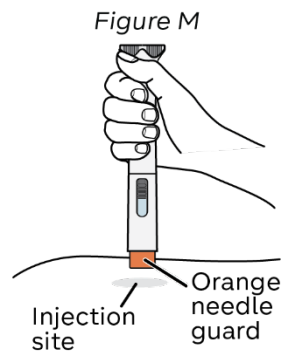

Step 14: Start injection and hold the NEMLUVIO pen on the skin

Gently push the pen down until the orange needle guard is completely pushed in.

The injection starts right away with a click (see Figure N).

The orange rod will begin to move down the injection window.

Do not lift the pen yet and keep pushing down.

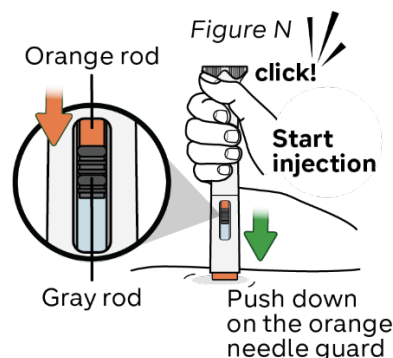

Step 15: Inject for 15 seconds

Hold slowly and count to 15.

Check the inspection window to make sure the orange rod and gray rod have stopped (see Figure O).

This means the injection has been completed.

Note: It is normal that the orange rod does not cover the whole inspection window at the end of injection.

Do not lift the pen until the orange rod and gray rod have stopped moving.

If the orange rod is not visible, please **call: 1-866-735-4137**. Throw away (dispose of) the pen and use a new one (see Section C for disposal details).

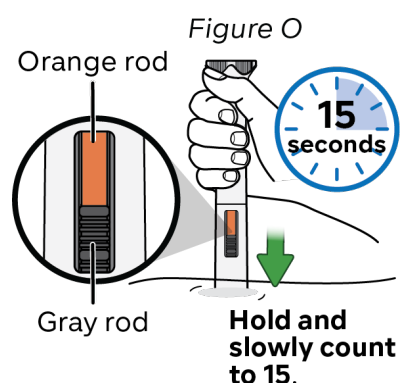

Step 16: Lift the NEMLUVIO pen up

- Lift the pen straight up from your skin. The orange needle guard locks into place to cover the needle (see Figure P).
- If there is bleeding, press a cotton ball or gauze over the injection site.

Do not rub the injection site.

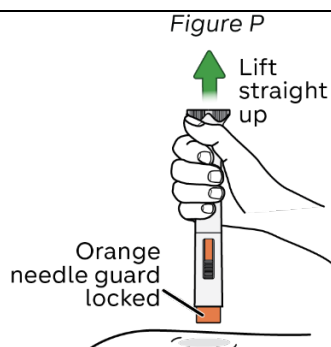

Turn over to read about pen disposal and FAQs

C. Throwing away (disposing of) NEMLUVIO

Step 17: Throw away (dispose of) NEMLUVIO in a sharps disposal container

Avoid contact with the needle.

Throw away (dispose of) the used pen and the gray cap in a FDA cleared sharps disposal container right away after use (see Figure Q).

Do not:

- recap the pen after use,
- dispose of the NEMLUVIO pen and cap in your household trash,
- dispose of your used sharps disposal container in your household trash unless your community guidelines permit this,
- recycle your used sharps disposal container.

If you do not have an FDA-cleared sharps disposal container, you may use a household container that is:

- made of a heavy-duty plastic,
- can be closed with a tight-fitting, puncture-resistant lid, without sharps being able to come out,
- upright and stable during use,
- leak-resistant and
- properly labeled to warn of hazardous waste inside the container.

When your sharps disposal container is almost full, you will need to follow your community guidelines for the right way to dispose of your sharps disposal container.

There may be state or local laws about how you should dispose of used pens.

For more information about safe sharps disposal, and for specific information about sharps disposal in the state that you live in, go to the FDA's website at:

<http://www.fda.gov/safesharpsdisposal>

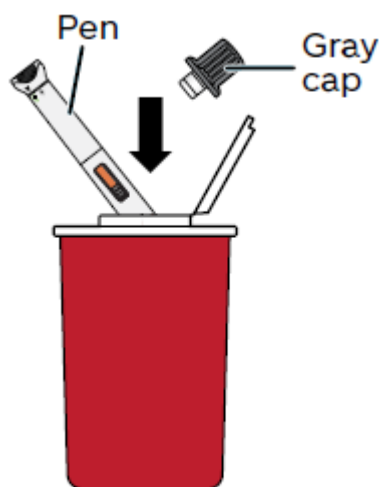

Figure Q

FAQs (Frequently asked questions)

Needle	Injecting the medicine
Where is the needle?	Why do I need to hold the pen upright while removing the gray cap?
<p>The needle is attached to the NEMLUVIO pen and covered by the gray cap.</p> <p>When you twist the gray cap, the orange needle guard pops up and keeps the needle covered until you inject.</p>	<p>Holding the NEMLUVIO pen with the gray cap upright helps prevent the medicine from leaking. It is normal to see a few drops of medicine inside the gray cap even when you hold the pen upright and remove the gray cap.</p>

For more information, please see the figures in Step 12 in this Instructions for Use.	
Dissolving the medicine	How do I know I injected myself the full dose of medicine in the pen?
How do I know if the medicine is fully dissolved?	<p>To be sure you get the full dose of medicine, press and hold the NEMLUVIO pen against your skin.</p> <p>You will feel the needle go into your skin. Hold the NEMLUVIO pen against your skin for 15 seconds. This will allow enough time for all the medicine to go from the pen to under your skin.</p> <p>Only remove the NEMLUVIO pen when the orange rod and the gray rod have stopped moving.</p> <p>After removing the NEMLUVIO pen, look for the orange rod in the window as a way to tell that the dose has been given. If the orange rod does not appear, contact 1-866-735-4137.</p> <p>For details please refer to Step 15 in this Instructions for Use.</p>
<p>To dissolve, shake the NEMLUVIO pen up and down until the white particles are no longer on the bottom, top, or sides. The dissolved medicine should look clear. Please refer to Step 9 in this Instructions for Use.</p> <p>After shaking the NEMLUVIO pen, look through both sides of the inspection window. You should not see any white particles along the bottom, top, or sides.</p> <p>It is acceptable to have small air bubbles or a small foam layer on top of the medicine. It does not harm you.</p> <p>If you see white particles in the medicine, it is not fully dissolved.</p>	
Storage	
How should I store the NEMLUVIO pen?	General Information
	Is it necessary to receive instructions on how to use the NEMLUVIO pen from a healthcare provider?
<p>The NEMLUVIO pen should be stored in the refrigerator in its original carton to protect it from light. It can be stored at room temperature for up to 77°F (25°C) for a single period up to 90 days.</p> <p>The device should not come in contact with liquids.</p>	<p>Yes.</p> <p>Do not inject the medicine if you did not receive a demonstration by your healthcare provider.</p> <p>You should contact your healthcare provider right away to receive the information on how to use the NEMLUVIO pen.</p>
Where do I find the expiration date?	Where can I get more information about using NEMLUVIO:
<p>You can find the expiration date on the NEMLUVIO pen, it is labeled EXP YYYY-MM.</p> <p>Do not use the NEMLUVIO pen past the expiration date.</p>	<p>If you have other questions about how to use the NEMLUVIO pen:</p> <ul style="list-style-type: none"> - Call your healthcare provider - Call 1-866-735-4137
What should I do if the medicine has been frozen?	
Do not use the NEMLUVIO pen if it has been frozen. Throw away (dispose of) the NEMLUVIO pen and use a new one.	

Manufactured by:
Galderma Laboratories, L.P.
Dallas, TX 75201
US License number: 2289

This Instructions for Use has been approved by the U.S. Food and Drug Administration.

Issued: 12/2024